

COMPARTMENT 55
 T18N, RI E, SEC. 3, 9, 10
 T19N, RI E, SEC. 33, 34
 COUNTY: GLADWIN
 UNIT: GLADWIN
 FOREST: AU SABLE
 YO: 2004
 ACRES: 1,270 GIS CALCULATED
 MAP REVISED: 8/23/2002
 STAND EXAMINER:

Final Version

LEGEND

- ◊ RLS CORNER
- ◊ MIRIS CORNER
- PAVED ROADS
- - - GRAVEL & GOOD DIRT ROADS
- - - POOR DIRT ROADS
- ~ LAKES
- ~ RIVERS
- - - INTERMITTENT STREAMS
- POWER LINES
- STAND BOUNDARY
- ▨ FINAL HARVEST
- ▨ SHELTERWOOD-SEED
- ▨ THINNING
- ▨ BURNING
- ▨ PLANTING

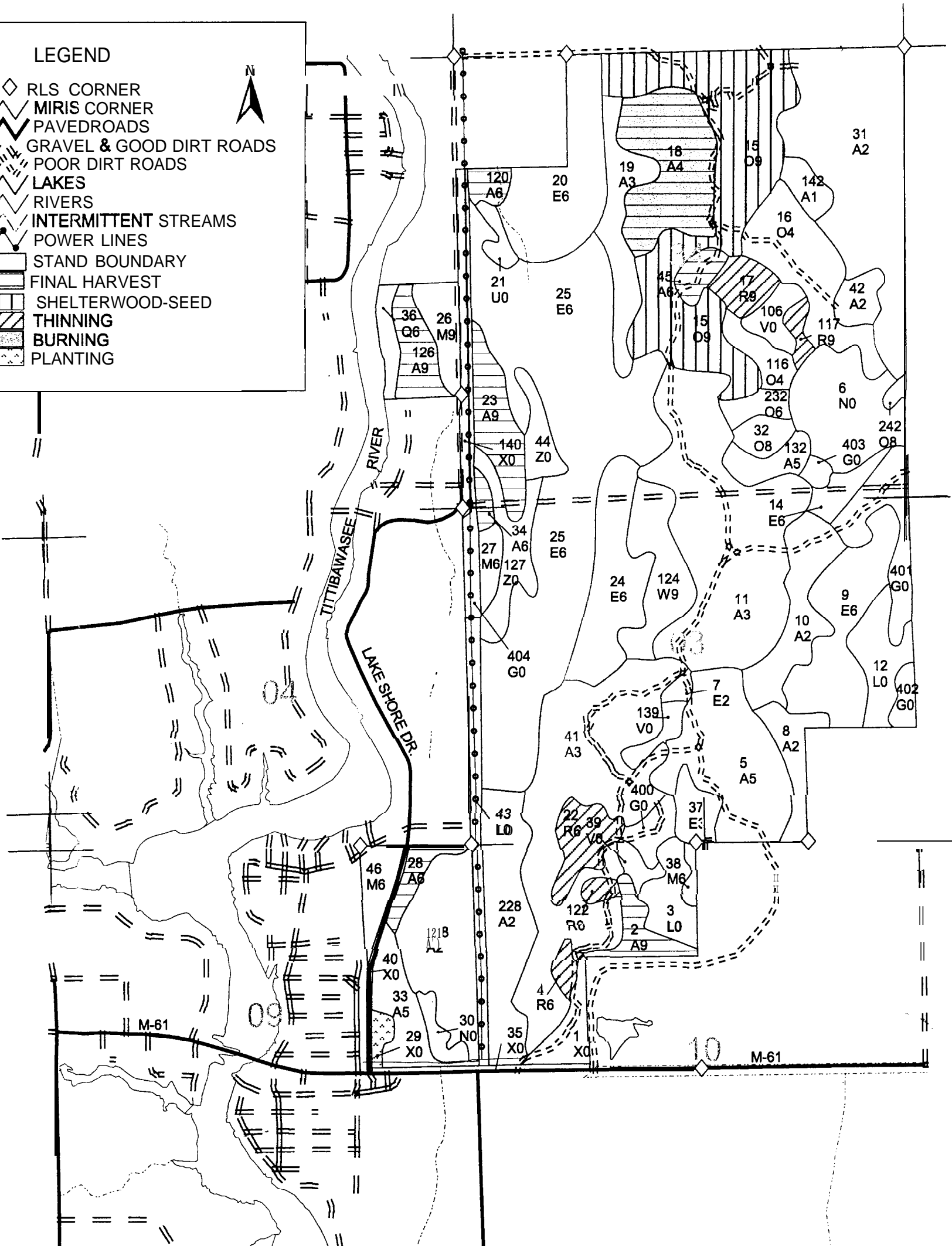

T18N, RI E, SEC. 3, 9, 10
 T19N, RI E, SEC. 33, 34
 COUNTY: GLADWIN
 UNIT: GLADWIN
 FOREST: AU SABLE
 YOE: 2004
 ACRES: 1,270 GIS CALCULATED
 MAP REVISED: 8/23/2002
 STAND EXAMINER:

ROAD SYSTEM MAP

Roads to Remain Open
 Proposed Road Closure
 Existing Road Closures

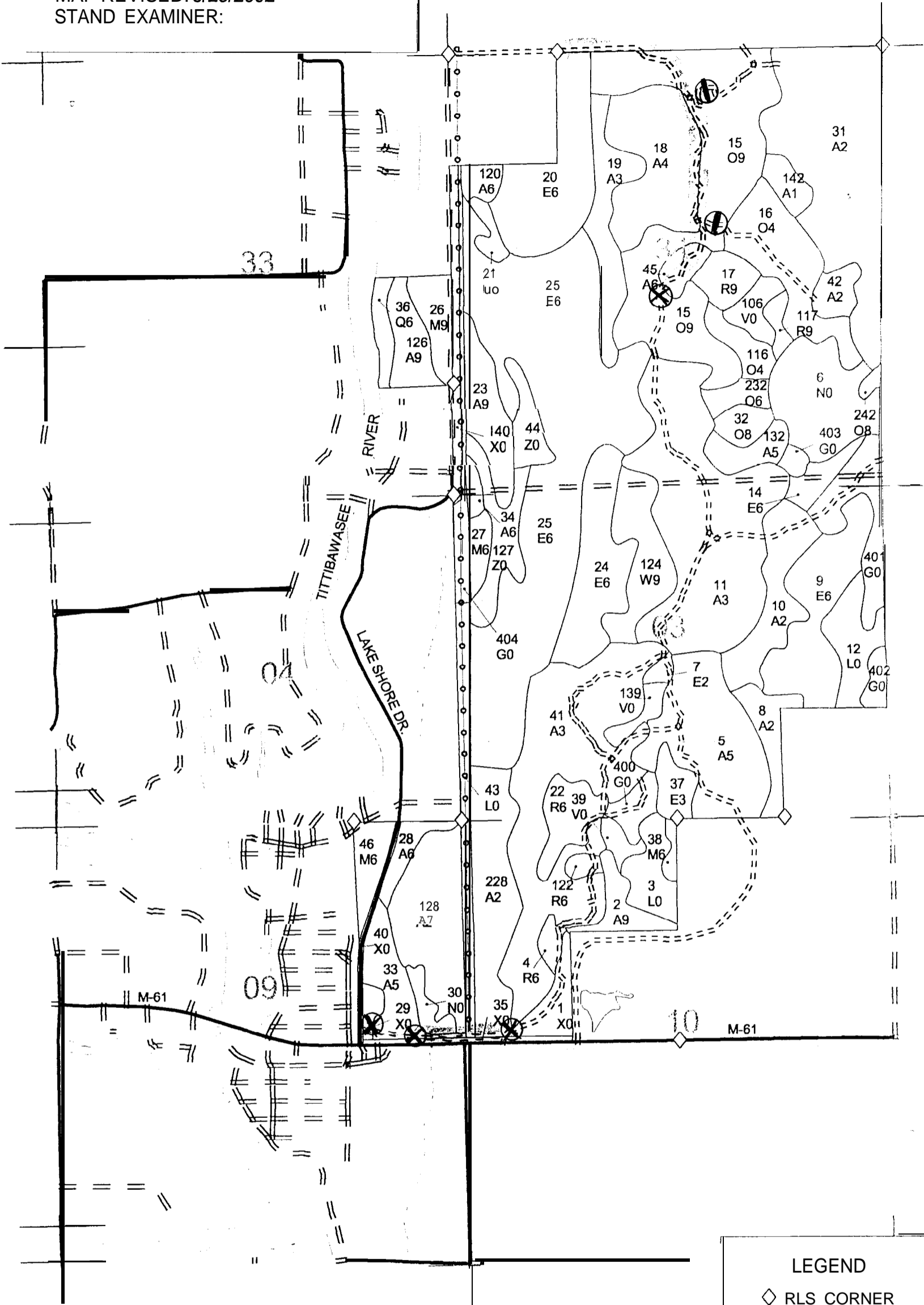
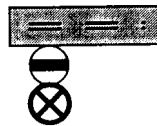

LEGEND

- ◇ RLS CORNER
- ◊ MIRIS CORNER
- ▬ PAVED ROADS
- ▬ GRAVEL & GOOD DIRT ROADS
- ▬ POOR DIRT ROADS
- ▬ LAKES
- ▬ RIVERS
- ▬ INTERMITTENT STREAMS
- POWER LINES
- STAND BOUNDARY



