



W

WALE BOUNDARY  
(Red Paint)

JPT COMPLEX

COMPARTMENT 127

T20N, R3E, SEC. 33-36

ARENAC COUNTY

GLADWIN MANAGEMENT UNIT

YEAR OF ENTRY 2001

1275 ACRES

Proposed Treatments.

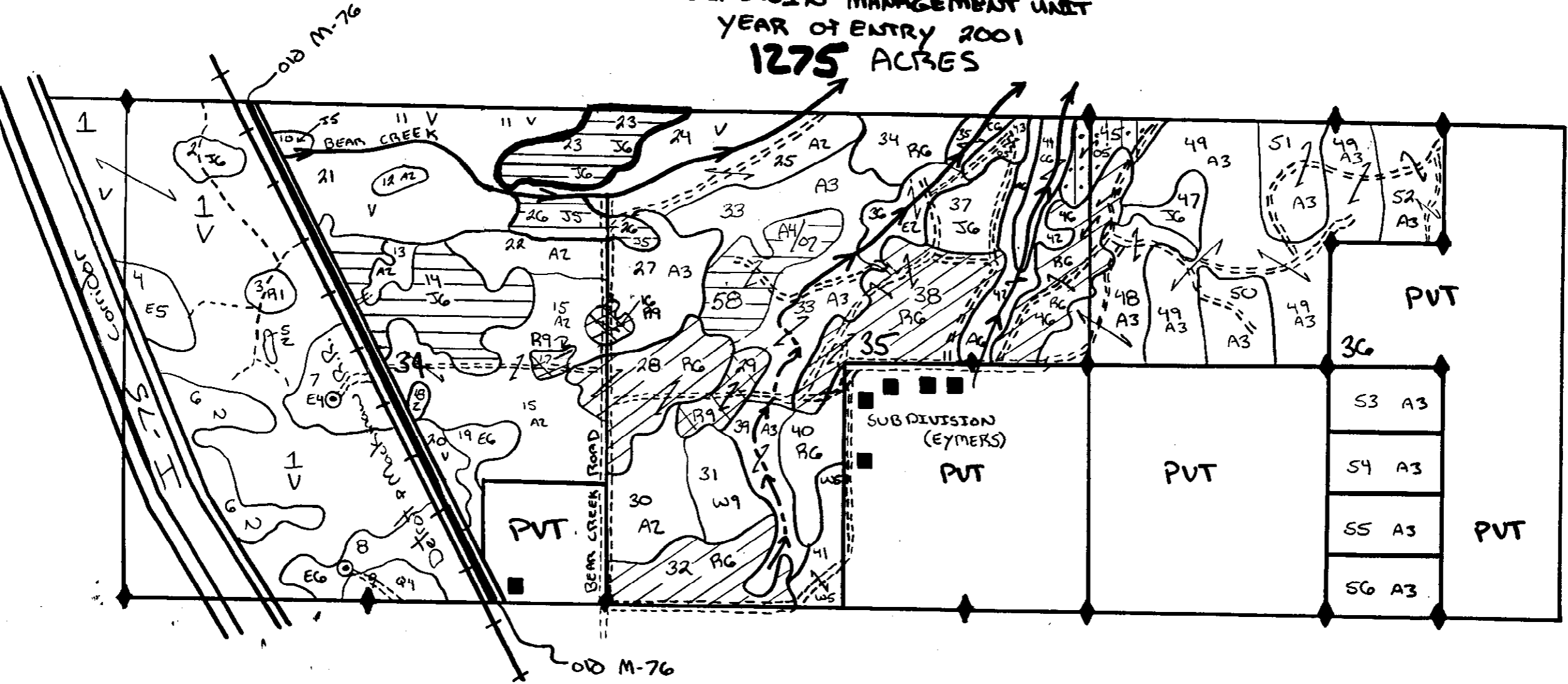

Update 5/11/2000  
 MAP Scale: 4" = 1 mile.  
 Examined by: Tim GALLAGHER 1999 7/31/99

