

STATE OF MICHIGAN  
DEPARTMENT OF NATURAL RESOURCES  
TIMBER SALE MAP

32-007-03-01  
SALE NO. 1010171013101  
YEAR 2001  
SALE TYPE

STATE FOREST AND FOREST AREA Gwinn Management Unit - Gwinn Field Office		MAPPED BY J. Koski	DATE 8-16-02
T 44N	R 23W	Section(s) 06 07	Sub. SWSE; NESE, S <sup>1</sup> / <sub>2</sub> S <sup>1</sup> / <sub>2</sub> ; N <sup>1</sup> / <sub>2</sub> N <sup>1</sup> / <sub>2</sub> , W <sup>1</sup> / <sub>2</sub> W <sup>1</sup> / <sub>2</sub>
COVER TYPE Sec. 18			DENSITY

- |                 |                    |                    |                  |                           |                       |
|-----------------|--------------------|--------------------|------------------|---------------------------|-----------------------|
| A - Aspen       | H - Hemlock        | P - Lowland Poplar | V - Bog or Marsh | 1 - Non Stocked           | 7 - Saw Timber Poor   |
| B - Paper Birch | J - Jack Pine      | Q - Mx Swamp Cnpr  | W - White Pine   | 2 - Seedling Sapling Poor | 8 - Saw Timber Medium |
| C - Cedar       | L - Lowland Brush  | R - Red Pine       | X - Non Stocked  | 3 - Seedling Sapling Well | 9 - Saw Timber Well   |
| E - Swamp Hdwds | M - Mpl, Bch, Brch | S - Black Spruce   | Z - Water        | 4 - Pole Timber Poor      |                       |
| F - Spruce Fir  | N - Marsh          | T - Tamarack       |                  | 5 - Pole Timber Medium    |                       |
| G - Grass       | O - Oak            | U - Upland Brush   |                  | 6 - Pole Timber Well      |                       |

McFarland Hardwoods  
49 AC

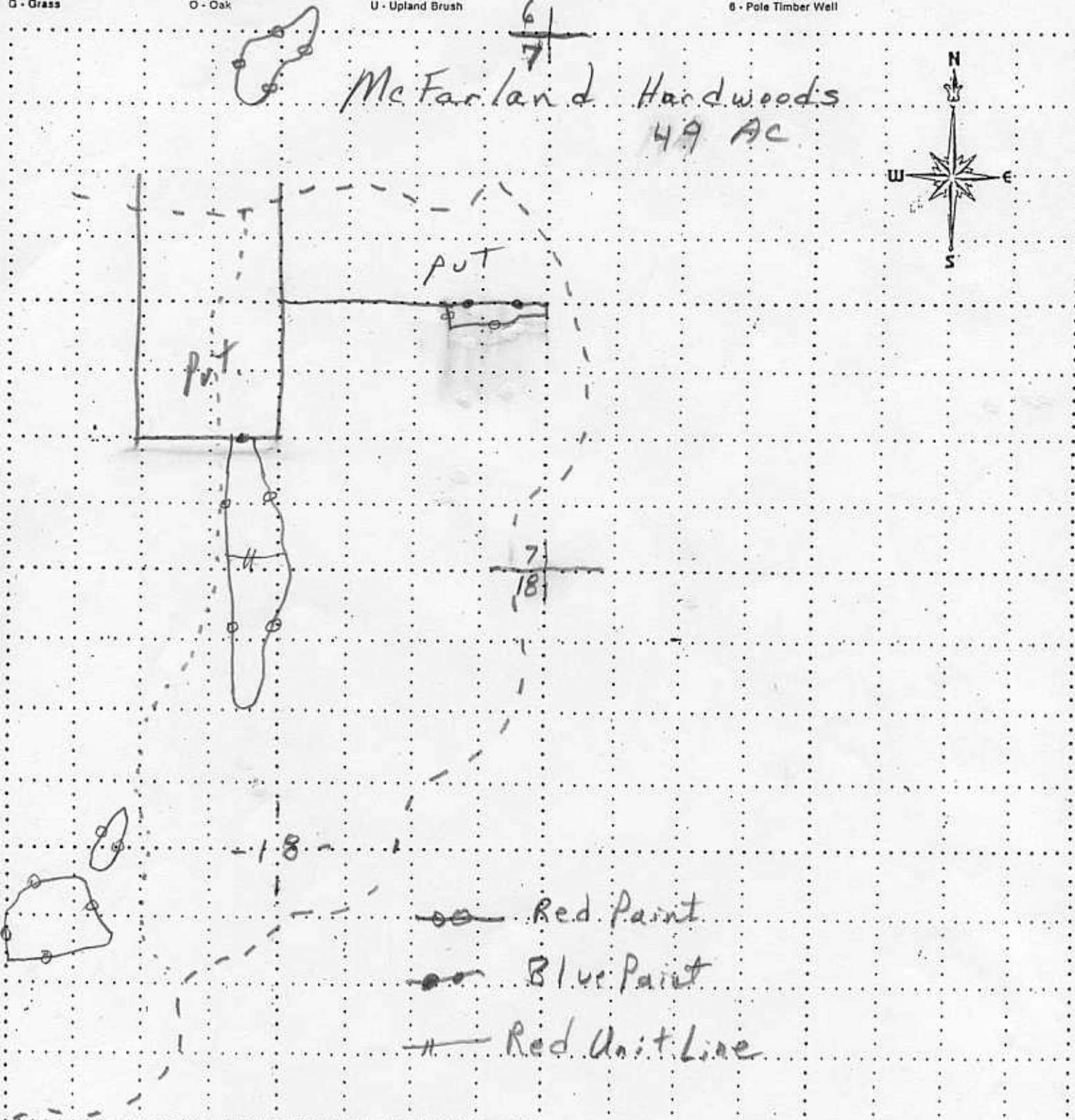
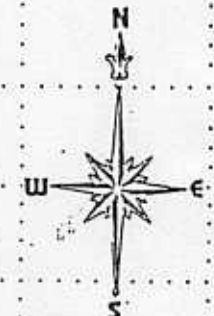

- Red Paint
- ⊗ Blue Paint
- ⊗— Red Unit Line