

— Red Line
 + + + Green Line

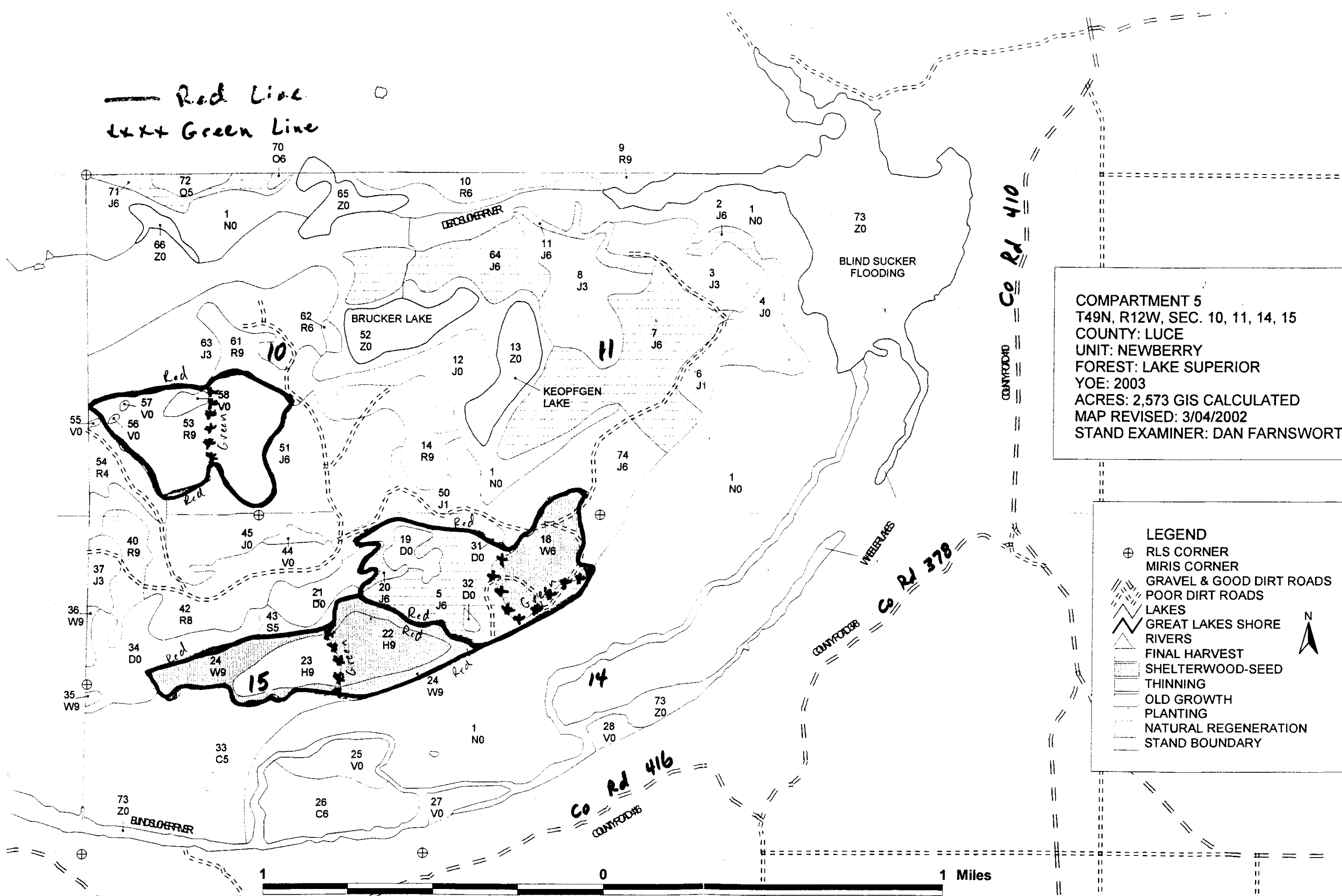

COMPARTMENT 5
 T49N, R12W, SEC. 10, 11, 14, 15
 COUNTY: LUCE
 UNIT: NEWBERRY
 FOREST: LAKE SUPERIOR
 YOY: 2003
 ACRES: 2,573 GIS CALCULATED
 MAP REVISED: 3/04/2002
 STAND EXAMINER: DAN FARNSWORTH

LEGEND

- ⊕ RLS CORNER
- ⊕ MIRIS CORNER
- ▨ GRAVEL & GOOD DIRT ROADS
- ▨ POOR DIRT ROADS
- LAKES
- GREAT LAKES SHORE
- RIVERS
- ▨ FINAL HARVEST
- ▨ SHELTERWOOD-SEED
- ▨ THINNING
- ▨ OLD GROWTH
- ▨ PLANTING
- ▨ NATURAL REGENERATION
- ▨ STAND BOUNDARY



MC MILLAN MAP NO. 12 T. 49-50N.-R. 12W.

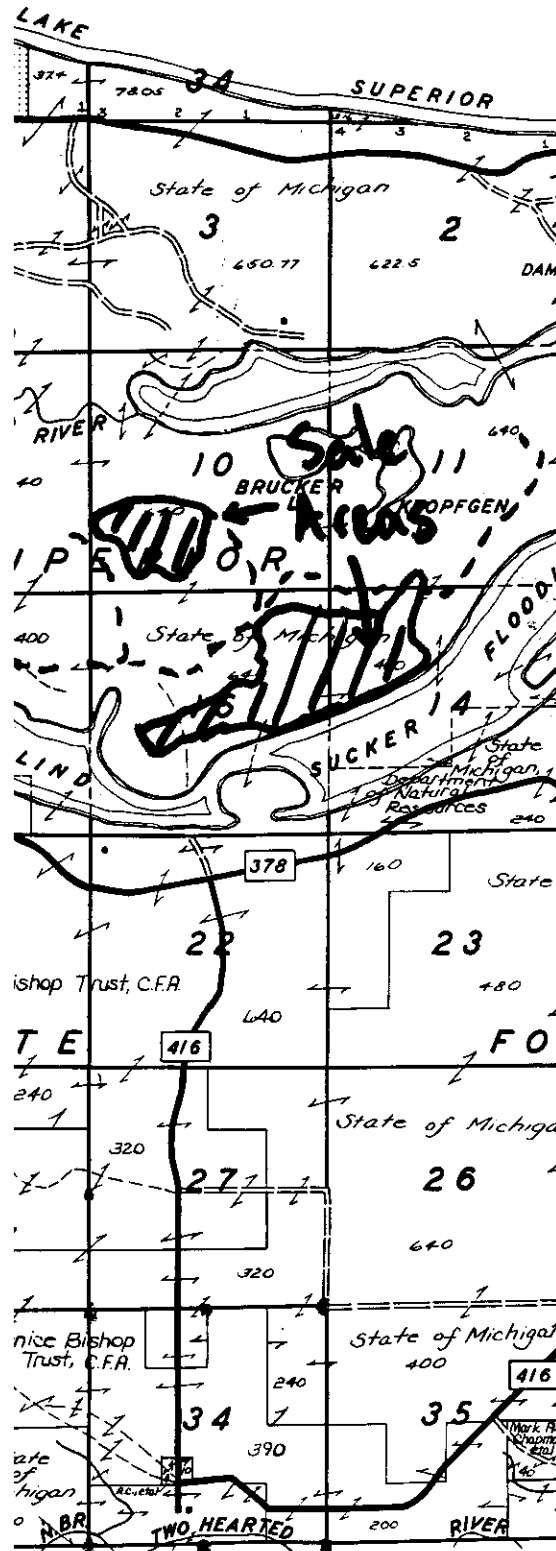

SEE PAGE 32
 28000 27000 26000 25000
 Luce County, Mich

2500