

COMPARTMENT 41
 T49N, R9W, SEC. 13, 14, 23-25, 27
 COUNTY: LUCE
 UNIT: NEWBERRY
 FOREST: LAKES SUPERIOR
 YOY: 2003
 ACRES: 1,555 GIS CALCULATED
 MAP REVISED: 3/20/2002
 STAND EXAMINER: DAN FARNSWORTH

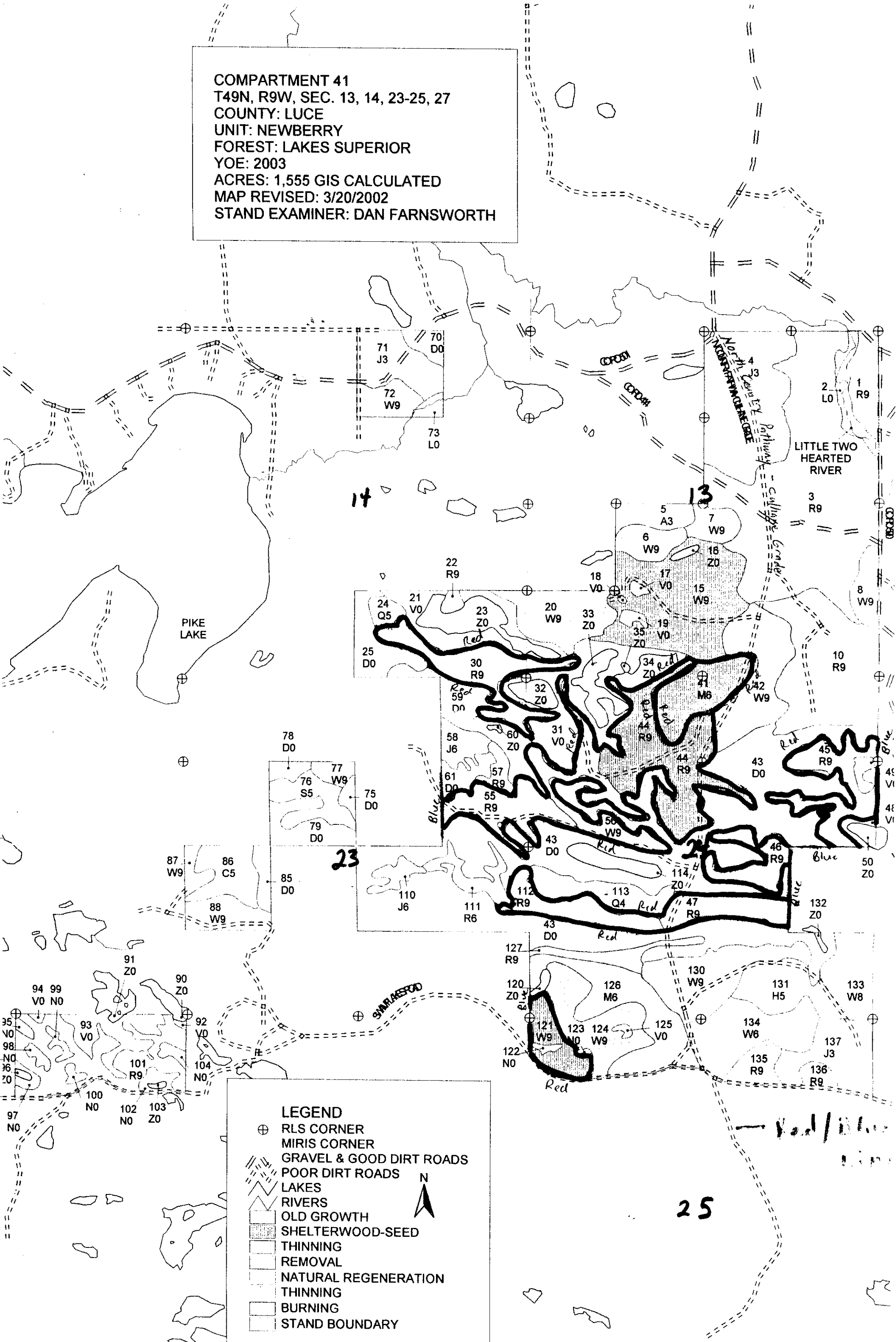

LEGEND

- ⊕ RLS CORNER
- ⊕ MIRIS CORNER
- ▬▬▬ GRVEL & GOOD DIRT ROADS
- ▬▬▬ POOR DIRT ROADS
- ~~~ LAKES
- ~~~ RIVERS
- ▭ OLD GROWTH
- ▭ SHELTERWOOD-SEED
- ▭ THINNING
- ▭ REMOVAL
- ▭ NATURAL REGENERATION
- ▭ THINNING
- ▭ BURNING
- ▭ STAND BOUNDARY

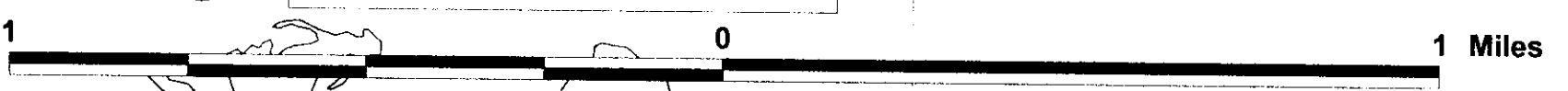

MC MILLAN MAP NO. 15 T.49N.-R.9 W.

CMAT
41
NOY

LINEAR

SEE PAGE 41

412

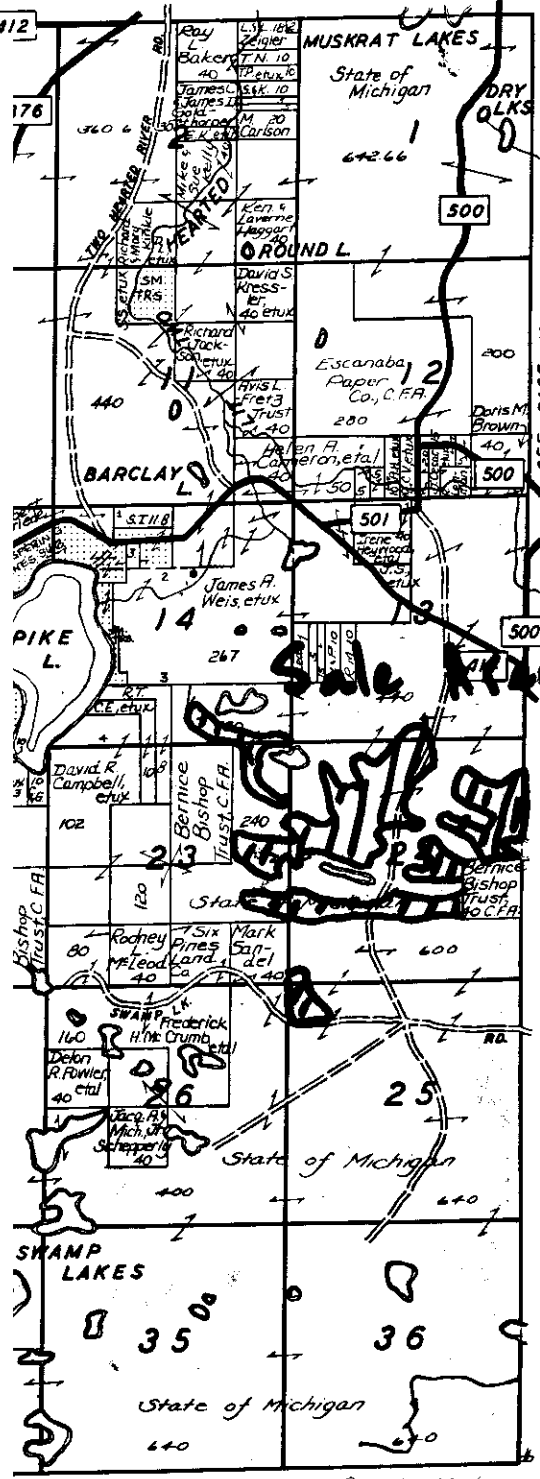

SEE PAGE 40

SEE PAGE 40

SEE PAGE 40

SEE PAGE 40

13000 12000 11000 10000 9000 8000 7000