

- Sale  
Boundary  
Red/Blue  
+ Green Line

COMPARTMENT 47  
T48N, R8W, SEC. 2-5, 8-10  
COUNTY: LUCE  
UNIT: NEWBERRY  
FOREST: LAKE SUPERIOR  
YOE: 2003  
ACRES: 2,940 GIS CALCULATED  
MAP REVISED: 3/20/2002  
STAND EXAMINER: DAN FARNSWORTH

	RLS CORNER
	MIRIS CORNER
	PAVED ROADS
	GRAVEL & GOOD DIRT ROADS
	POOR DIRT ROADS
	CLOSED/ABANDONED ROADS
	LAKES
	RIVERS
	INTERMITTENT STREAMS
	OLD GROWTH
	FINAL HARVEST
	THINNING
	SELECTION
	STAND BOUNDARY

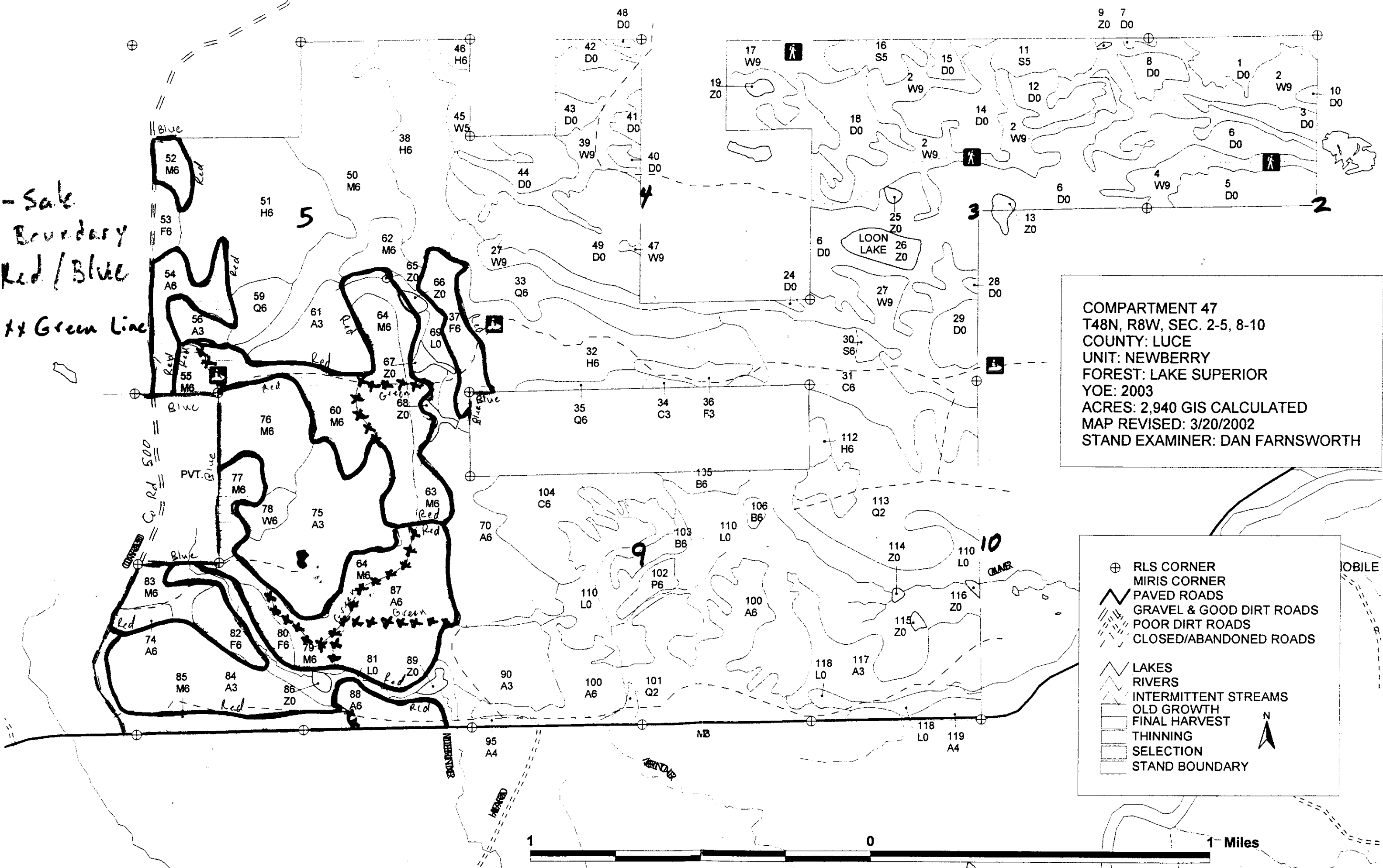

1 Miles

