



TIMBER SALE MAP

This information provided by authority of Part 525, 1994 PA 451, as amended.

Forest Management Unit Atlanta Management Unit	County Alpena	Mapped By D. Parris Cruised By Natzke, Parris, Zimmerman	Date 9/30/17	Page 1	of 2
Township 34N	Range 07E	Section(s) and Subdivision(s) Sec. 20 N2SW, SWSW; Sec. 29 E2SE Sec. 32 NE4, NESW, E2SE ; Sec. 33 SWNW, W2SW	Scale 1:15,840		

Cover Type

A = Aspen	H = Hemlock	N = Marsh	U = Upland Brush
B = Paper Birch	J = Jack Pine	O = Oak	UM = Upland Mixed
C = Cedar	L = Lowland Brush	P = Lowland Poplar	V = Bog or Marsh
D = Tread Bog	LM = Lowland Mixed	Q = Mixed Swamp Conifer	W = White Pine
E = Swamp Hdwoods	M = Mpl, Bch, Brch	R = Red Pine	X = Non Stocked
F = Spruce Fir	MC = Mixed Conifer	S = Black Spruce	Z = Water
G = Grass	MD = Mixed Deciduous	T = Tamarack	

Density

0 = Non Stocked	5 = Pole Timber Medium
1 = Seedling Sapling Poor	6 = Pole Timber Well
2 = Seedling Sapling Medium	7 = Saw Timber Poor
3 = Seedling Sapling Well	8 = Saw Timber Medium
4 = Pole Timber Poor	9 = Saw Timber Well

PU	Acres	PU	Acres
1	24.5	6	26.7
2	25.3	7	21.3
3	17.3	8	9.4
4	20.2	9	4.7
5	21.0		

Are We There Yet? SBW

Compartment 142

170.4 Acres

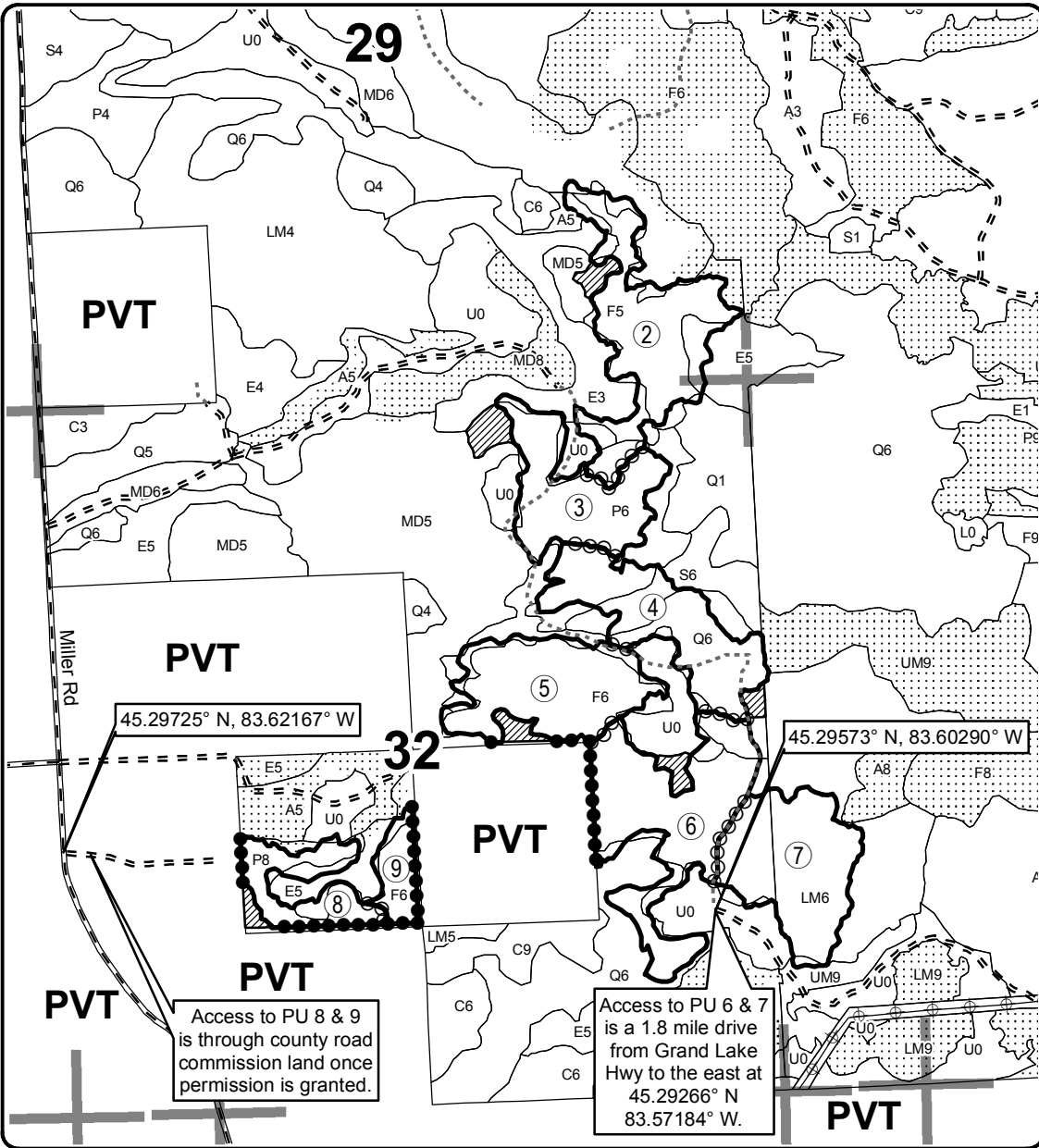

Legend

- Against State (Red)
- Payment Unit (Yellow)
- Private Line (Blue)
- Retention (Red)
- Stand Boundaries
- Nearby Sale
- Gravel Roads
- Poor Dirt Roads
- Closed Roads
- Lakes and Rivers
- Powerline
- Section Corners



Locator Map
1:200,000

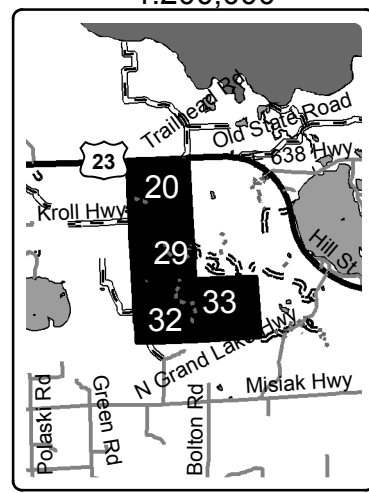

Access to PU 8 & 9 is through county road commission land once permission is granted.

Access to PU 6 & 7 is a 1.8 mile drive from Grand Lake Hwy to the east at 45.29266° N 83.57184° W.

