



TIMBER SALE MAP

This information provided by authority of Part 525, 1994 PA 451, as amended.

Forest Management Unit Atlanta Management Unit	County Presque Isle	Mapped By Natzke	Date 05/25/2021	Page 1	of 1
Township 36N	Range 02E	Section(s) and Subdivision(s) Sec. 18 NW, W2NE	Scale 1:15,840		

Cover Type

A = Aspen	H = Hemlock	N = Marsh	U = Upland Brush
B = Paper Birch	J = Jack Pine	O = Oak	UM = Upland Mixed
C = Cedar	L = Lowland Brush	P = Lowland Poplar	V = Bog or Marsh
D = Treed Bog	LM = Lowland Mixed	Q = Mixed Swamp Conifer	W = White Pine
E = Swamp Hdwoods	M = Mpl, Bch, Brch	R = Red Pine	X = Non Stocked
F = Spruce Fir	MC = Mixed Conifer	S = Black Spruce	Z = Water
G = Grass	MD = Mixed Deciduous	T = Tamarack	

Density

0 = Non Stocked	5 = Pole Timber Medium
1 = Seedling Sapling Poor	6 = Pole Timber Well
2 = Seedling Sapling Medium	7 = Saw Timber Poor
3 = Seedling Sapling Well	8 = Saw Timber Medium
4 = Pole Timber Poor	9 = Saw Timber Well

Designer Aspen & Oak

Compartment 156

38.7 Acres

PU	Acres
1	18.3
2	20.4

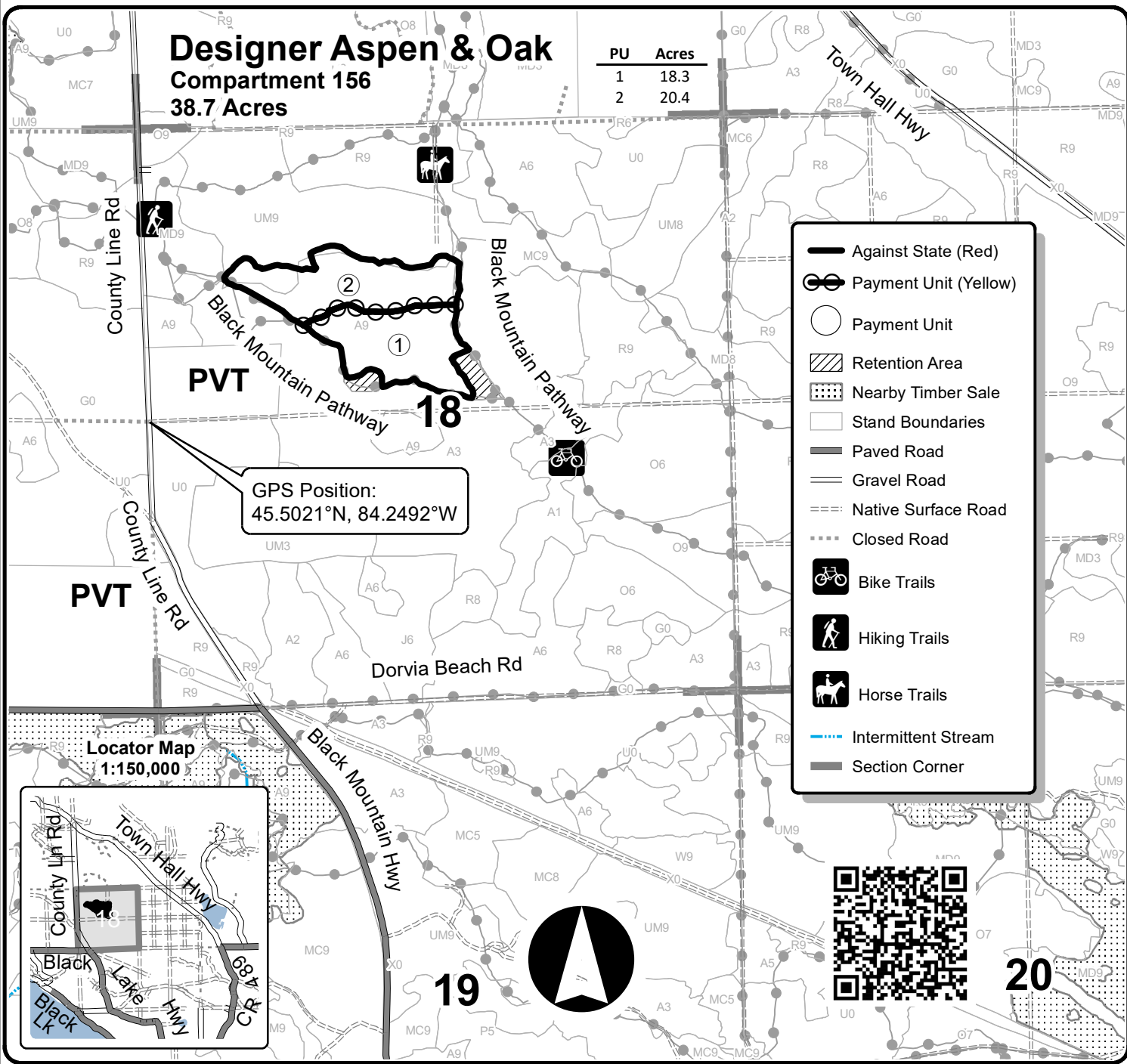

- Against State (Red)
- Payment Unit (Yellow)
- Payment Unit
- Retention Area
- Nearby Timber Sale
- Stand Boundaries
- Paved Road
- Gravel Road
- Native Surface Road
- Closed Road
- Bike Trails
- Hiking Trails
- Horse Trails
- Intermittent Stream
- Section Corner

Locator Map

1:150,000

