



# TIMBER SALE MAP

This information provided by authority of Part 525, 1994 PA 451, as amended.

Forest Management Unit <b>Atlanta</b>		County <b>Montmorency</b>	Mapped By <b>Doug Tyran</b>	Date <b>07/30/2021</b>	Page <b>1</b>	of <b>1</b>
Township <b>32N</b>	Range <b>01E</b>	Section(s) and Subdivision(s) <b>27: NWNW, S1/2NW, SWNE, SW 28: NESE</b>		Scale <b>1:15,840</b>		

### Cover Type

A = Aspen	H = Hemlock	N = Marsh	U = Upland Brush
B = Paper Birch	J = Jack Pine	O = Oak	UM = Upland Mixed
C = Cedar	L = Lowland Brush	P = Lowland Poplar	V = Bog or Marsh
D = Treed Bog	LM = Lowland Mixed	Q = Mixed Swamp Conifer	W = White Pine
E = Swamp Hdwoods	M = Mpl, Bch, Brch	R = Red Pine	X = Non Stocked
F = Spruce Fir	MC = Mixed Conifer	S = Black Spruce	Z = Water
G = Grass	MD = Mixed Deciduous	T = Tamarack	

### Density

0 = Non Stocked	5 = Pole Timber Medium
1 = Seedling Sapling Poor	6 = Pole Timber Well
2 = Seedling Sapling Medium	7 = Saw Timber Poor
3 = Seedling Sapling Well	8 = Saw Timber Medium
4 = Pole Timber Poor	9 = Saw Timber Well

### PU Acres

<b>1</b>	<b>65.6</b>
<b>2</b>	<b>54.0</b>
<b>3</b>	<b>14.5</b>

## Pine Party

### Compartment 060

### 134.1 Acres

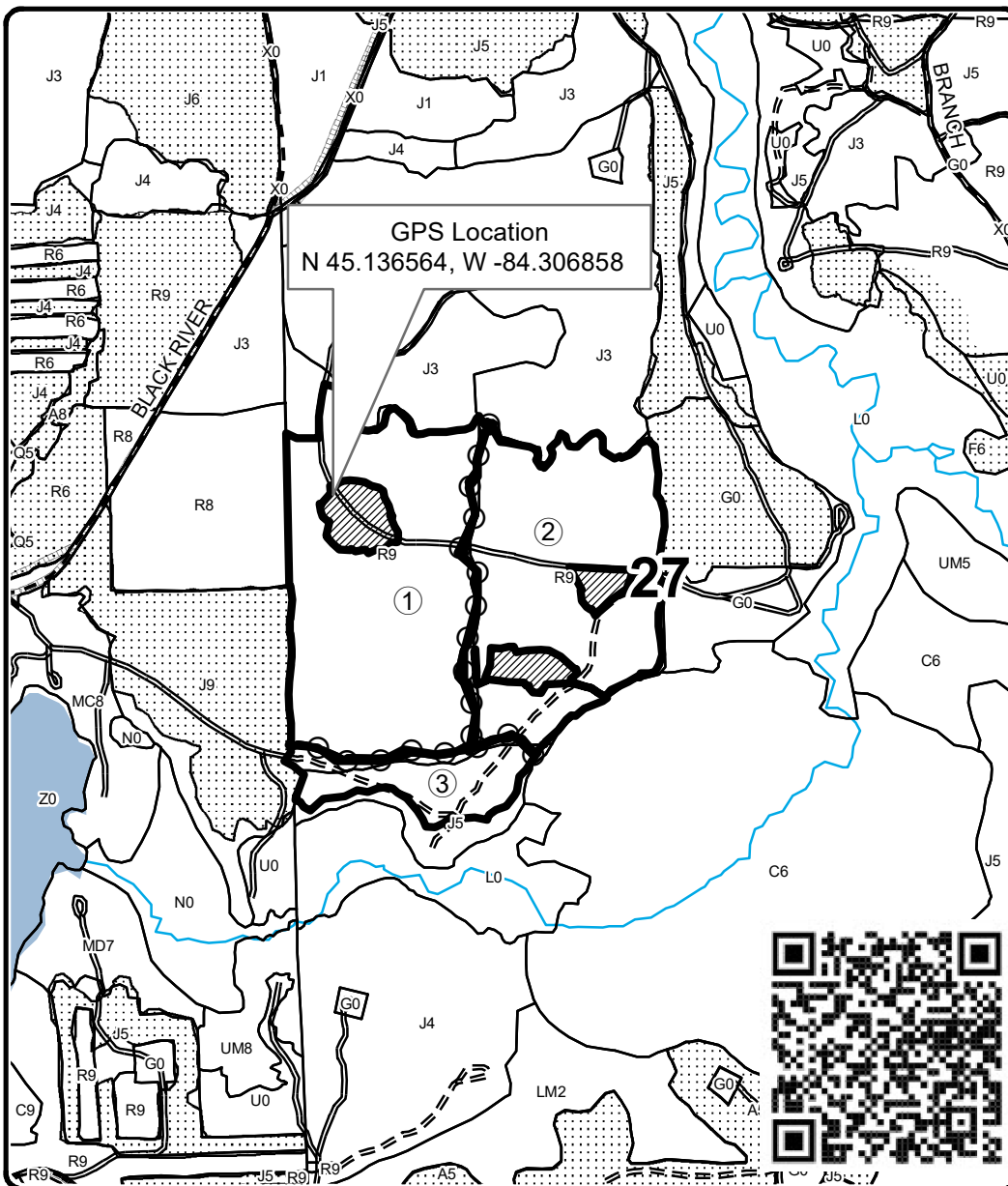

### Legend

- Against State (Red)
- Payment Unit (Yellow)
- Retention Area (Green)
- Stand Boundaries
- Nearby Timber Sales
- Lakes and Rivers
- Primary Forest Road
- Secondary Forest Road
- Forest Access Route
- Paved Road
- Gravel Road
- County Road - Seasonal
- Private

### Locator Map

1:200,000

