



# TIMBER SALE MAP

This information provided by authority of Part 525, 1994 PA 451, as amended.

Forest Management Unit

County

Mapped By

Ryan Mattila

Date

Page

of

Baraga

Houghton

Cruised By

Mattila, Collins

12/27/2018

1

1

Township

Range

Section(s) and Subdivision(s)

Scale

51N

35W

Sec 3; S1/2SE. Sec 10; NENW, W1/2NE, NENE.

1:15,840

### Cover Type

- A = Aspen
- B = Paper Birch
- C = Cedar
- D = Treed Bog
- E = Swamp Hdwoods
- F = Spruce Fir
- G = Grass
- H = Hemlock
- J = Jack Pine
- L = Lowland Brush
- LM = Lowland Mixed
- M = Mpl, Bch, Brch
- MC = Mixed Conifer
- MD = Mixed Deciduous
- N = Marsh
- O = Oak
- P = Lowland Poplar
- Q = Mixed Swamp Conifer
- R = Red Pine
- S = Black Spruce
- T = Tamarack
- U = Upland Brush
- UM = Upland Mixed
- V = Bog or Marsh
- W = White Pine
- X = Non Stocked
- Z = Water

### Density

- 0 = Non Stocked
- 1 = Seedling Sapling Poor
- 2 = Seedling Sapling Medium
- 3 = Seedling Sapling Well
- 4 = Pole Timber Poor
- 5 = Pole Timber Medium
- 6 = Pole Timber Well
- 7 = Saw Timber Poor
- 8 = Saw Timber Medium
- 9 = Saw Timber Well

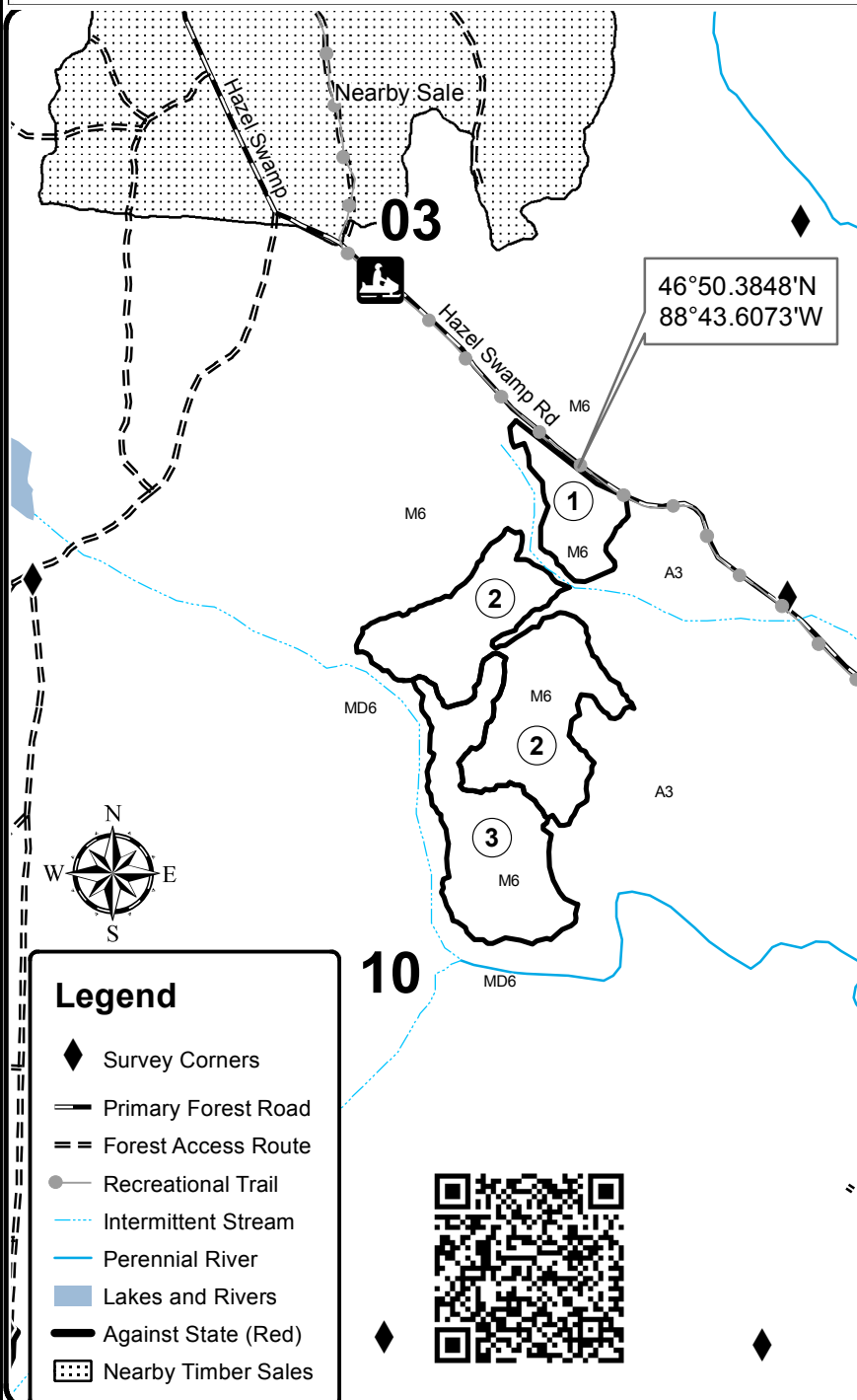

### Comp 41 Thaw

65.1 Acres  
Houghton County, Compartment 41

UNIT	1	2	3	TOTALS
ACRES	9.5	37.6	24.4	71.5
<b>Sawlogs MBF</b>				
Basswood	0.0	5.7	1.5	7.2
Red Maple	1.4	3.9	3.0	8.3
Sugar Maple	4.9	22.9	0.0	27.8
White Ash	2.0	4.9	0.0	6.9
Yellow Birch	0.0	0.7	0.0	0.7
<b>TOTAL</b>	<b>8.3</b>	<b>38.1</b>	<b>4.5</b>	<b>50.9</b>
<b>Pulpwood Cords</b>				
Mixed Hardwood	107	196	293	596
Quaking Aspen	0	3	272	275
White Spruce	0	0	14	14
<b>TOTAL</b>	<b>107</b>	<b>199</b>	<b>579</b>	<b>885</b>

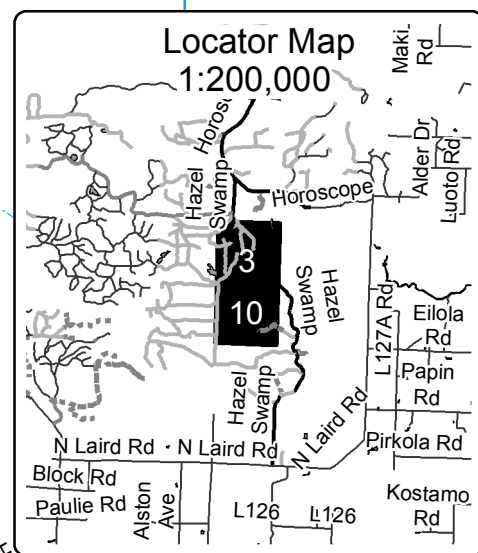

### Legend

- ◆ Survey Corners
- Primary Forest Road
- == Forest Access Route
- Recreational Trail
- Intermittent Stream
- Perennial River
- Lakes and Rivers
- Against State (Red)
- ▨ Nearby Timber Sales

