



TIMBER SALE MAP

This information provided by authority of Part 525, 1994 PA 451, as amended.

Forest Management Unit Cadillac / Manton		County Missaukee	Mapped By M. Edison	Date 9/24/2021	Page 1	of 1
Township 22N	Range 5W	Section(s) and Subdivision(s) 11 S1/2SE 12 NW/4E, N1/2SW, SWSW, NWSE 13 N1/2SE, NWNW, S1/2NW, S1/2NE, N1/2SW 14 N1/2NE, SENE, W1/2SE	Cruised By Upper Michigan Land Management		Scale 1:31,680	

Cover Type				Density	
A = Aspen	H = Hemlock	N = Marsh	U = Upland Brush	0 = Non Stocked	5 = Pole Timber Medium
B = Paper Birch	J = Jack Pine	O = Oak	UM = Upland Mixed	1 = Seedling Sapling Poor	6 = Pole Timber Well
C = Cedar	L = Lowland Brush	P = Lowland Poplar	V = Bog or Marsh	2 = Seedling Sapling Medium	7 = Saw Timber Poor
D = Treed Bog	LM = Lowland Mixed	Q = Mixed Swamp Conifer	W = White Pine	3 = Seedling Sapling Well	8 = Saw Timber Medium
E = Swamp Hdwoods	M = Mpl, Bch, Brch	R = Red Pine	X = Non Stocked	4 = Pole Timber Poor	9 = Saw Timber Well
F = Spruce Fir	MC = Mixed Conifer	S = Black Spruce	Z = Water		
G = Grass	MD = Mixed Deciduous	T = Tamarack			

PU	Acres	PU	Acres
1	104.1	4	3.8
2	54.0	5	12.6
3	29.2	6	14.3

Jeffs Far Reach Mix

Compartment 95

218 Acres

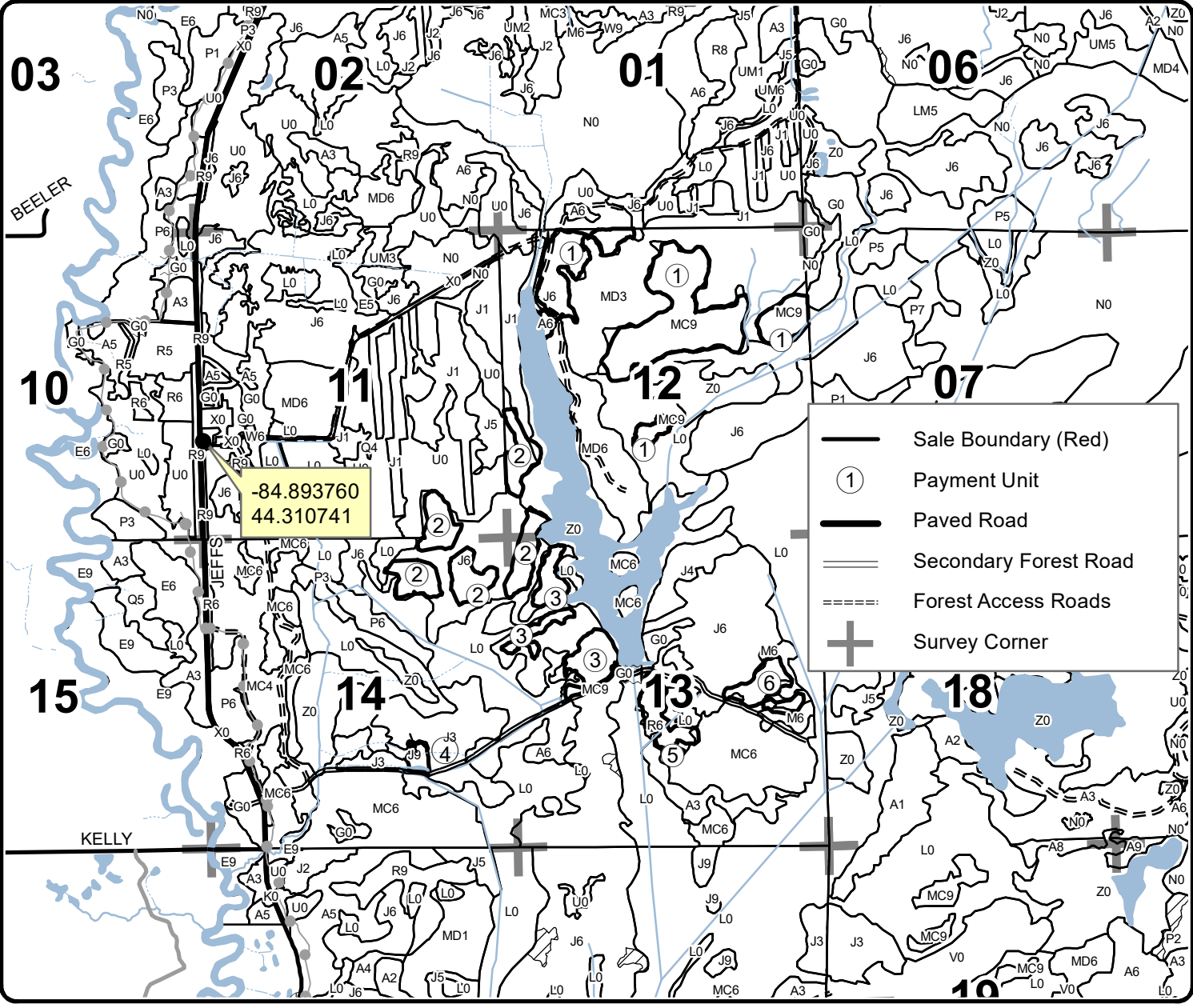

-84.893760
44.310741

- Sale Boundary (Red)
- Payment Unit
- Paved Road
- Secondary Forest Road
- Forest Access Roads
- Survey Corner

