



# TIMBER SALE MAP

This information provided by authority of Part 525, 1994 PA 451, as amended.

Sale Number	Year
12-003	22

Forest Management Unit Crystal Falls		County Dickinson	Mapped By Jacob Siler	Date 03/08/2022	Page 2	of 2
Township 43N	Range 29W	Section(s) and Subdivision(s) S23 SESW; S26 NENW,S1/2NW,NE; S35 N1/2NE,N1/2SW,SESW,SE; S36 NWSW		Scale 1:15,840		
Cover Type				Density		
A = Aspen	H = Hemlock	N = Marsh	U = Upland Brush	0 = Non Stocked	5 = Pole Timber Medium	
B = Paper Birch	J = Jack Pine	O = Oak	UM = Upland Mixed	1 = Seedling Sapling Poor	6 = Pole Timber Well	
C = Cedar	L = Lowland Brush	P = Lowland Poplar	V = Bog or Marsh	2 = Seedling Sapling Medium	7 = Saw Timber Poor	
D = Treed Bog	LM = Lowland Mixed	Q = Mixed Swamp Conifer	W = White Pine	3 = Seedling Sapling Well	8 = Saw Timber Medium	
E = Swamp Hdwoods	M = Mpl, Bch, Brch	R = Red Pine	X = Non Stocked	4 = Pole Timber Poor	9 = Saw Timber Well	
F = Spruce Fir	MC = Mixed Conifer	S = Black Spruce	Z = Water			
G = Grass	MD = Mixed Deciduous	T = Tamarack				

### PU: Acres

1: 25.0	5: 26.4	9: 4.1
2: 18.7	6: 17.2	10: 4.2
3: 26.9	7: 10.1	11: 6.5
4: 30.9	8: 41.6	12: 6.6

## Cave Dweller

### Compartment 52

### 218.2 Acres

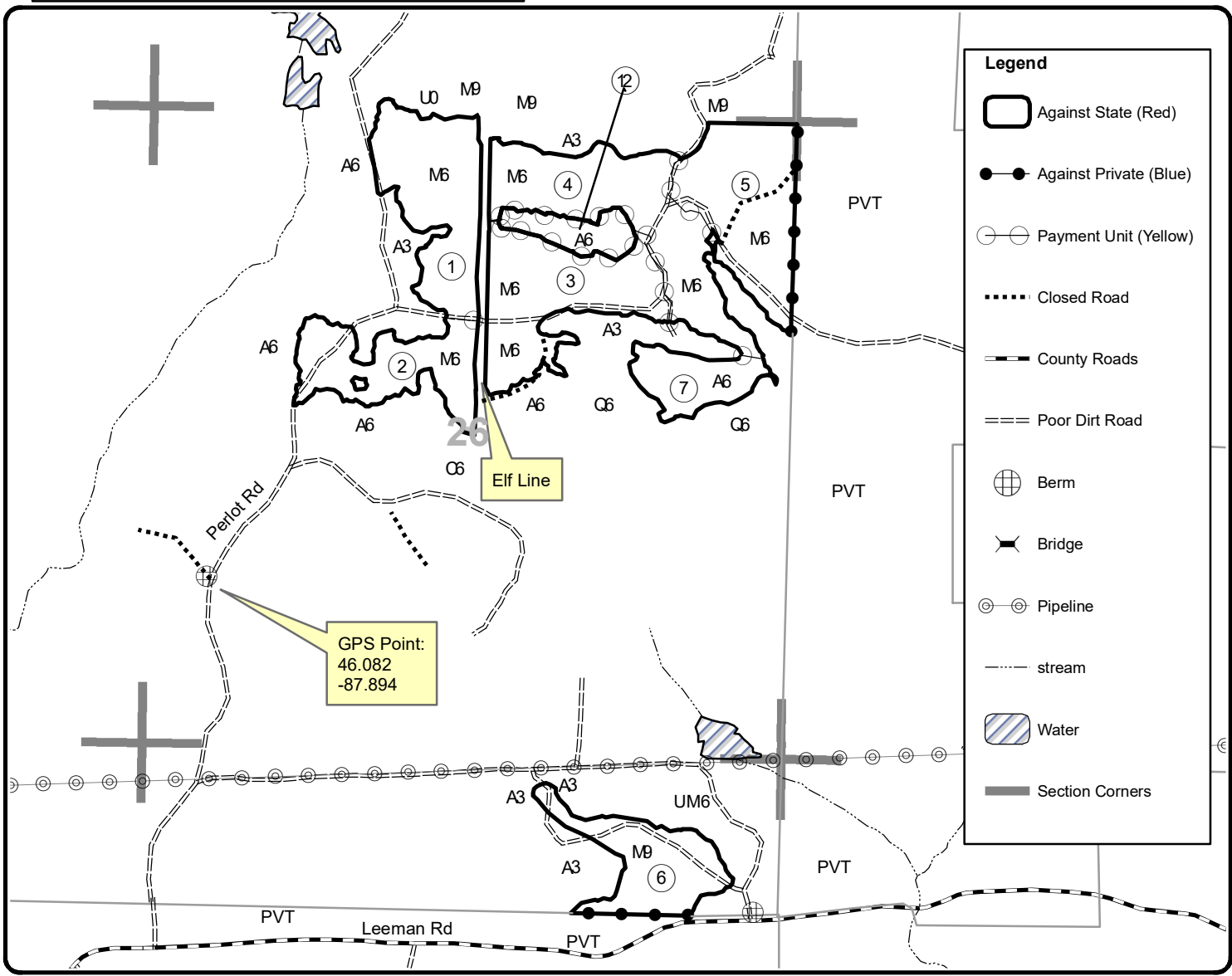

Legend	
	Against State (Red)
	Against Private (Blue)
	Payment Unit (Yellow)
	Closed Road
	County Roads
	Poor Dirt Road
	Berm
	Bridge
	Pipeline
	stream
	Water
	Section Corners

