



# TIMBER SALE MAP

This information provided by authority of Part 525, 1994 PA 451, as amended.

Forest Management Unit Crystal Falls		County Dickinson	Mapped By Jacob Siler	Date 07/23/19	Page 2	of 2
Township 44N	Range 29W	Section(s) and Subdivision(s) Sections: 21, 27, 28, 29, 33 & 34		Scale 1:15,840		

Cover Type				Density	
A = Aspen	H = Hemlock	N = Marsh	U = Upland Brush	0 = Non Stocked	5 = Pole Timber Medium
B = Paper Birch	J = Jack Pine	O = Oak	UM = Upland Mixed	1 = Seedling Sapling Poor	6 = Pole Timber Well
C = Cedar	L = Lowland Brush	P = Lowland Poplar	V = Bog or Marsh	2 = Seedling Sapling Medium	7 = Saw Timber Poor
D = Treed Bog	LM = Lowland Mixed	Q = Mixed Swamp Conifer	W = White Pine	3 = Seedling Sapling Well	8 = Saw Timber Medium
E = Swamp Hdwoods	M = Mpl, Bch, Brch	R = Red Pine	X = Non Stocked	4 = Pole Timber Poor	9 = Saw Timber Well
F = Spruce Fir	MC = Mixed Conifer	S = Black Spruce	Z = Water		
G = Grass	MD = Mixed Deciduous	T = Tamarack			

**PU: Acres**

1: 28.2	7: 29.9	13: 26.1
2: 21.1	8: 23.5	14: 15.8
3: 23.1	9: 33.9	15: 33.6
4: 23.7	10: 15.8	
5: 25.9	11: 30.9	
6: 14.2	12: 14.5	

## Rub Line Pine Mix Compartment 10 360.2 Acres

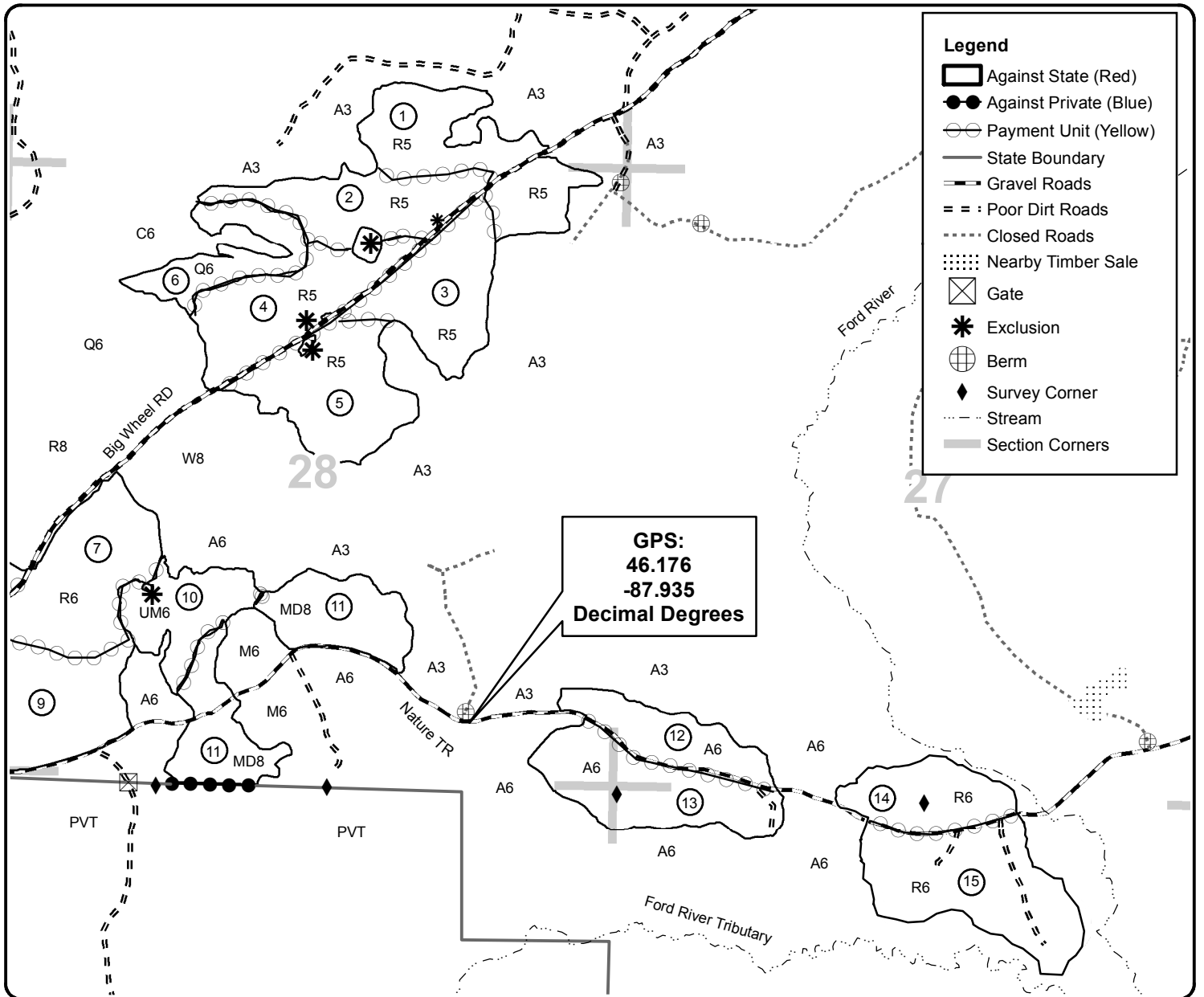

**Legend**

- Against State (Red)
- Against Private (Blue)
- Payment Unit (Yellow)
- State Boundary
- Gravel Roads
- - - Poor Dirt Roads
- ⋯ Closed Roads
- ⋯ Nearby Timber Sale
- ⊠ Gate
- \* Exclusion
- ⊕ Berm
- ◆ Survey Corner
- ⋯ Stream
- Section Corners

**GPS:**  
46.176  
-87.935  
Decimal Degrees

