



# TIMBER SALE MAP

This information provided by authority of Part 525, 1994 PA 451, as amended.

Sale Number 33-044 Year 17

Forest Management Unit Escanaba Management Unit		County Menominee County	Mapped By Beaudo	Date 9/27/2017	Page 1	of 1
Township 36N	Range 25W	Section(s) and Subdivision(s) Sec 9 - NENW, NESE, NESW, NWSE, NWSW, SENE, SENW, SESW, SWNE, SWSE, SWSW; Sec 16 - NENW, NWNE		Scale 1:15,840		

Cover Type				Density	
A = Aspen	H = Hemlock	N = Marsh	U = Upland Brush	0 = Non Stocked	5 = Pole Timber Medium
B = Paper Birch	J = Jack Pine	O = Oak	UM = Upland Mixed	1 = Seedling Sapling Poor	6 = Pole Timber Well
C = Cedar	L = Lowland Brush	P = Lowland Poplar	V = Bog or Marsh	2 = Seedling Sapling Medium	7 = Saw Timber Poor
D = Tread Bog	LM = Lowland Mixed	Q = Mixed Swamp Conifer	W = White Pine	3 = Seedling Sapling Well	8 = Saw Timber Medium
E = Swamp Hdwoods	M = Mpl, Bch, Brch	R = Red Pine	X = Non Stocked	4 = Pole Timber Poor	9 = Saw Timber Well
F = Spruce Fir	MC = Mixed Conifer	S = Black Spruce	Z = Water		
G = Grass	MD = Mixed Deciduous	T = Tamarack			

PU	Acres	PU	Acres
1	12.4	6	25.6
2	21.3	7	29.0
3	20.0	8	17.8
4	14.7	9	8.3
5	34.5		

**D 4 Road SBW**  
**Compartment 42**  
**183.6 Acres**

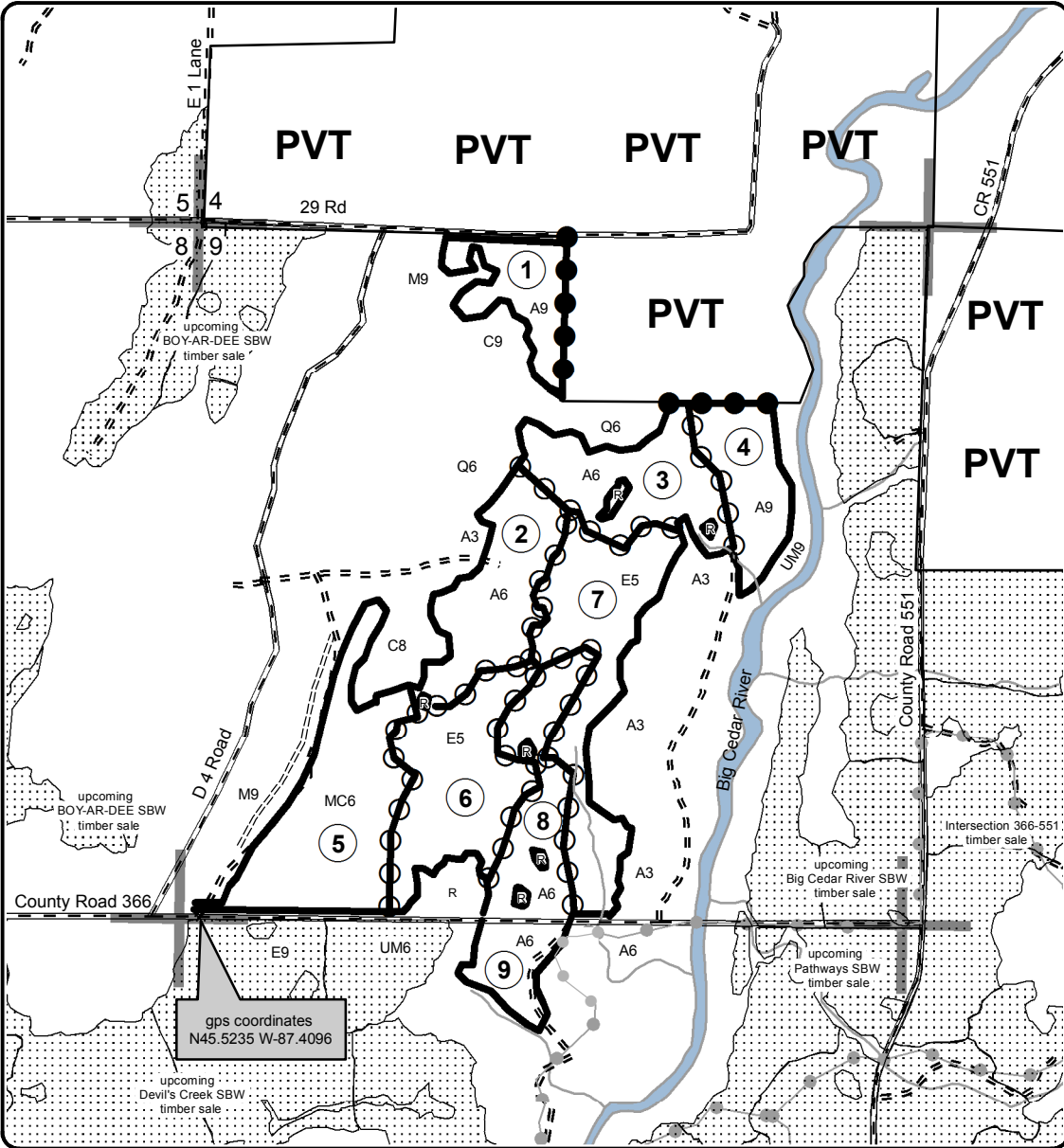

**Legend**

- Against State (Red)
- Payment Unit (Yellow)
- Private Line (Blue)
- Section Corners
- 9 Section Number
- Paved Roads
- Gravel Roads
- == Poor Dirt Roads
- Recreational Trail
- State Land Boundary
- ① Payment Unit
- ~ Creek/Seasonal Drainage
- R Retention Patch
- PVT Private Property

