



TIMBER SALE MAP

This information provided by authority of Part 525, 1994 PA 451, as amended.

Forest Management Unit Gwinn		County Marquette	Mapped By Holodnick	Date 5/20/20	Page 2	of 2
Township 45N	Range 22W	Section(s) and Subdivision(s) Sec 15: SWNW, NWSW, NWNW Sec3: SWNW, SESE Sec 10: NESW, NENW, NWSE, NWNE		Scale 1:15,840		

Cover Type				Density	
A = Aspen	H = Hemlock	N = Marsh	U = Upland Brush	0 = Non Stocked	5 = Pole Timber Medium
B = Paper Birch	J = Jack Pine	O = Oak	UM = Upland Mixed	1 = Seedling Sapling Poor	6 = Pole Timber Well
C = Cedar	L = Lowland Brush	P = Lowland Poplar	V = Bog or Marsh	2 = Seedling Sapling Medium	7 = Saw Timber Poor
D = Tread Bog	LM = Lowland Mixed	Q = Mixed Swamp Conifer	W = White Pine	3 = Seedling Sapling Well	8 = Saw Timber Medium
E = Swamp Hdwoods	M = Mpl, Bch, Brch	R = Red Pine	X = Non Stocked	4 = Pole Timber Poor	9 = Saw Timber Well
F = Spruce Fir	MC = Mixed Conifer	S = Black Spruce	Z = Water		
G = Grass	MD = Mixed Deciduous	T = Tamarack			

PU Acres

1	27.7	7	22
2	26.0	8	14.7
3	28.7		
4	28.9		
5	15		
6	21.3		

C101 Contract Marking HWD

Compartment 101

184.3 Acres

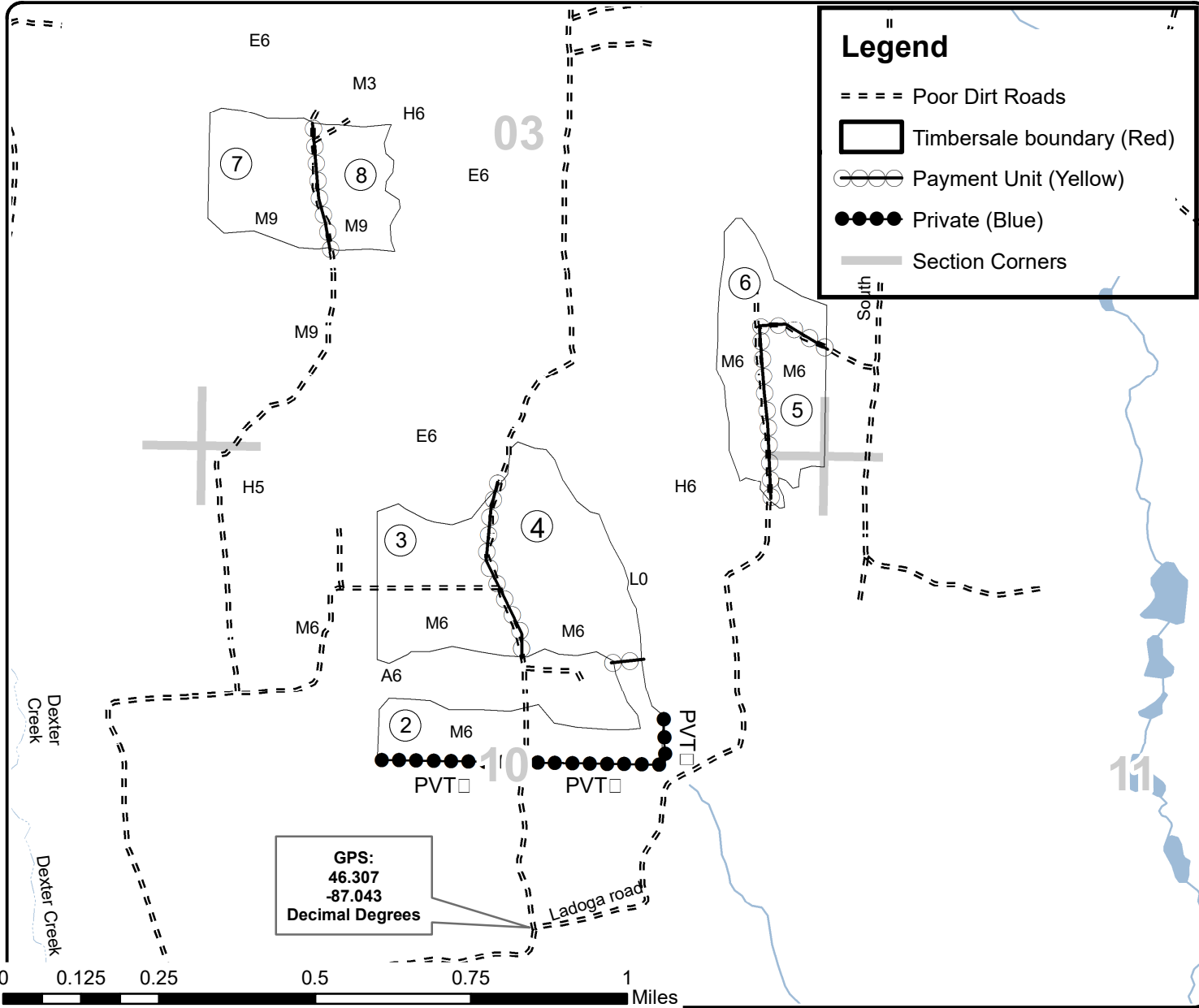

Legend

- == == Poor Dirt Roads
- ▭ Timbersale boundary (Red)
- ○ ○ Payment Unit (Yellow)
- ● ● Private (Blue)
- Section Corners

GPS:
46.307
-87.043
Decimal Degrees

