



# TIMBER SALE MAP

This information provided by authority of Part 525, 1994 PA 451, as amended.

Forest Management Unit Gwinn		County Marquette	Mapped By Holodnick	Date 5/20/20	Page 1	of 1
Township 45N	Range 21W	Section(s) and Subdivision(s) Sec 11: SW 1/4 Sec 13: NW 1/4, SW1/4 Sec 14: NESE, NWSW, SWSW, NWSE Sec 15: NESE, SESE		Scale 1:15,840		

Cover Type				Density	
A = Aspen	H = Hemlock	N = Marsh	U = Upland Brush	0 = Non Stocked	5 = Pole Timber Medium
B = Paper Birch	J = Jack Pine	O = Oak	UM = Upland Mixed	1 = Seedling Sapling Poor	6 = Pole Timber Well
C = Cedar	L = Lowland Brush	P = Lowland Poplar	V = Bog or Marsh	2 = Seedling Sapling Medium	7 = Saw Timber Poor
D = Tread Bog	LM = Lowland Mixed	Q = Mixed Swamp Conifer	W = White Pine	3 = Seedling Sapling Well	8 = Saw Timber Medium
E = Swamp Hdwoods	M = Mpl, Bch, Brch	R = Red Pine	X = Non Stocked	4 = Pole Timber Poor	9 = Saw Timber Well
F = Spruce Fir	MC = Mixed Conifer	S = Black Spruce	Z = Water		
G = Grass	MD = Mixed Deciduous	T = Tamarack			

## PU Acres

1	19.5	7	23.6	13	21.5
2	20.6	8	20.8	14	26.3
3	22.2	9	21.1		
4	16.3	10	11.2		
5	15.9	11	42.7		
6	21.1	12	43.2		

# C98 Contract Marking HWD

## Compartment 98

### 326 Acres

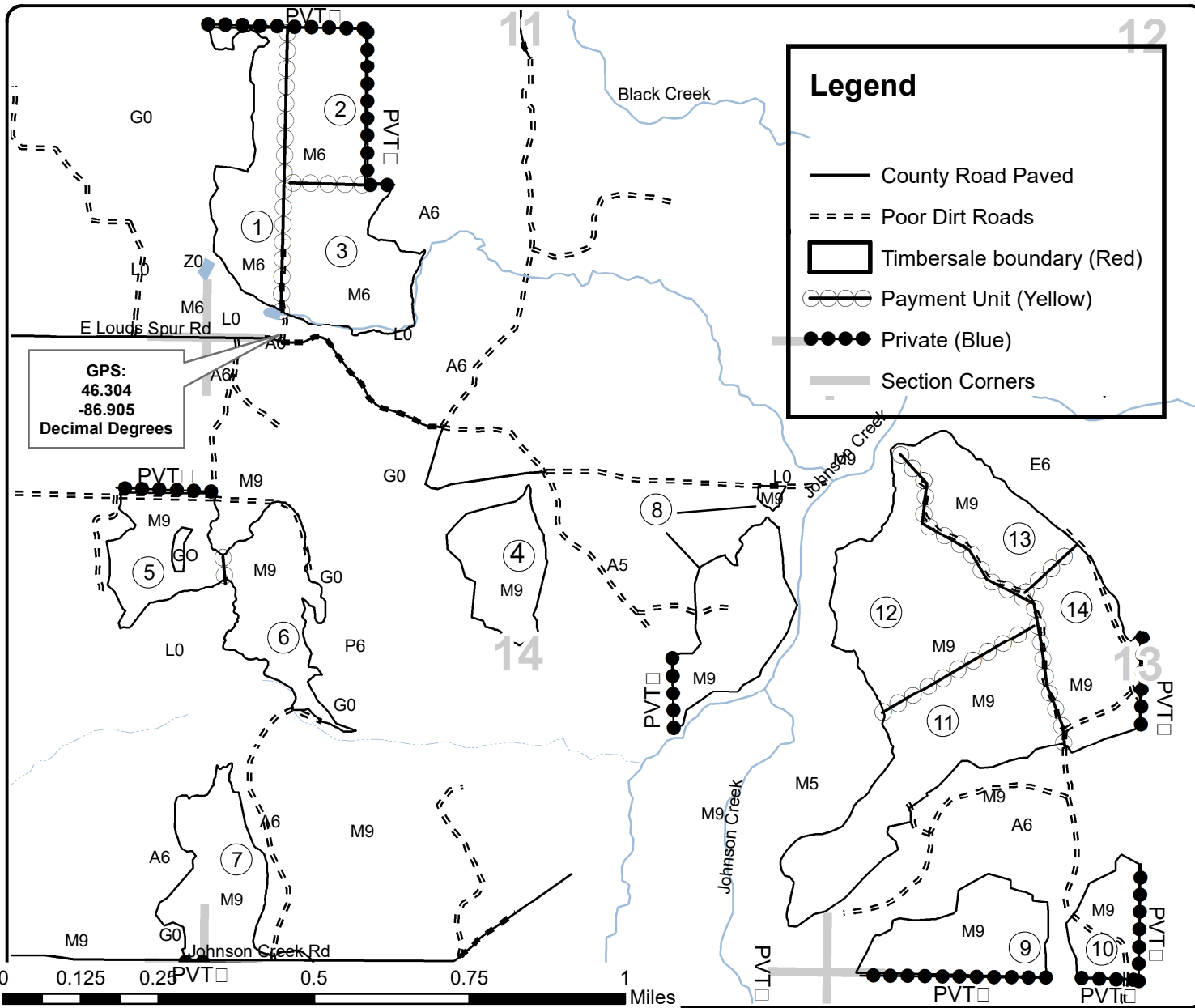

### Legend

- County Road Paved
- Poor Dirt Roads
- Timbersale boundary (Red)
- Payment Unit (Yellow)
- Private (Blue)
- Section Corners