



TIMBER SALE MAP

This information provided by authority of Part 525, 1994 PA 451, as amended.

Sale Number
32-001-24

Date
09/27/2024

Forest Management Unit	County	Mapped By: Siler	Scale	Page	Of
Gwinn Mgt Unit	Marquette	Cruised By: Contractor & Gwinn Unit	1:10,000	3	4

Township	Range	Section(s) and Subdivision(s)
44N / 45N	24W	Sec. 14 NESW,S1/2SW,SE; Sec. 24 NW,NE,N1/2SW,SWSW,NWSE; Sec. 25 NWNW; Sec. 3 NESW,NWSE;

Cover Type			
A = Aspen	J = Jack Pine	O = Oak	U = Upland Brush
B = Paper Birch	K = Rock	P = Lowland Poplar	UM = Upland Mix Forest
C = Cedar	L = Lowland Brush	Q = Mixed Swamp Conifer	V = Bog or Marsh
D = Treed Bog	LM = Lowland Mix Forest	R = Red Pine	W = White Pine
E = Swamp Hardwoods	M = Maple, Beech, Birch	S = Black Spruce	X = Non Stocked
F = Spruce/Fir	MC = Mixed Conifer	T = Tamarack	Y = Sand
G = Grass	MD = Mixed Deciduous		Z = Water
H = Hemlock	N = Marsh		

Density	
0 = Non Stocked	5 = Pole Timber Medium
1 = Seedling Sapling Poor	6 = Pole Timber Well
2 = Seedling Sapling Medium	7 = Saw Timber Poor
3 = Seedling Sapling Well	8 = Saw Timber Medium
4 = Pole Timber Poor	9 = Saw Timber Well

PU #	Acres	PU #	Acres	PU #	Acres	PU #	Acres
1	18.6	6	36.1	11	29.8	16	26.9
2	13.8	7	13.6	12	22.2	17	3.5
3	9.2	8	37.9	13	30.6	18	4.1
4	3.7	9	30.6	14	21.5	19	0.8
5	20.3	10	12.4	15	25.1	20	0.1

Acres: 360.8

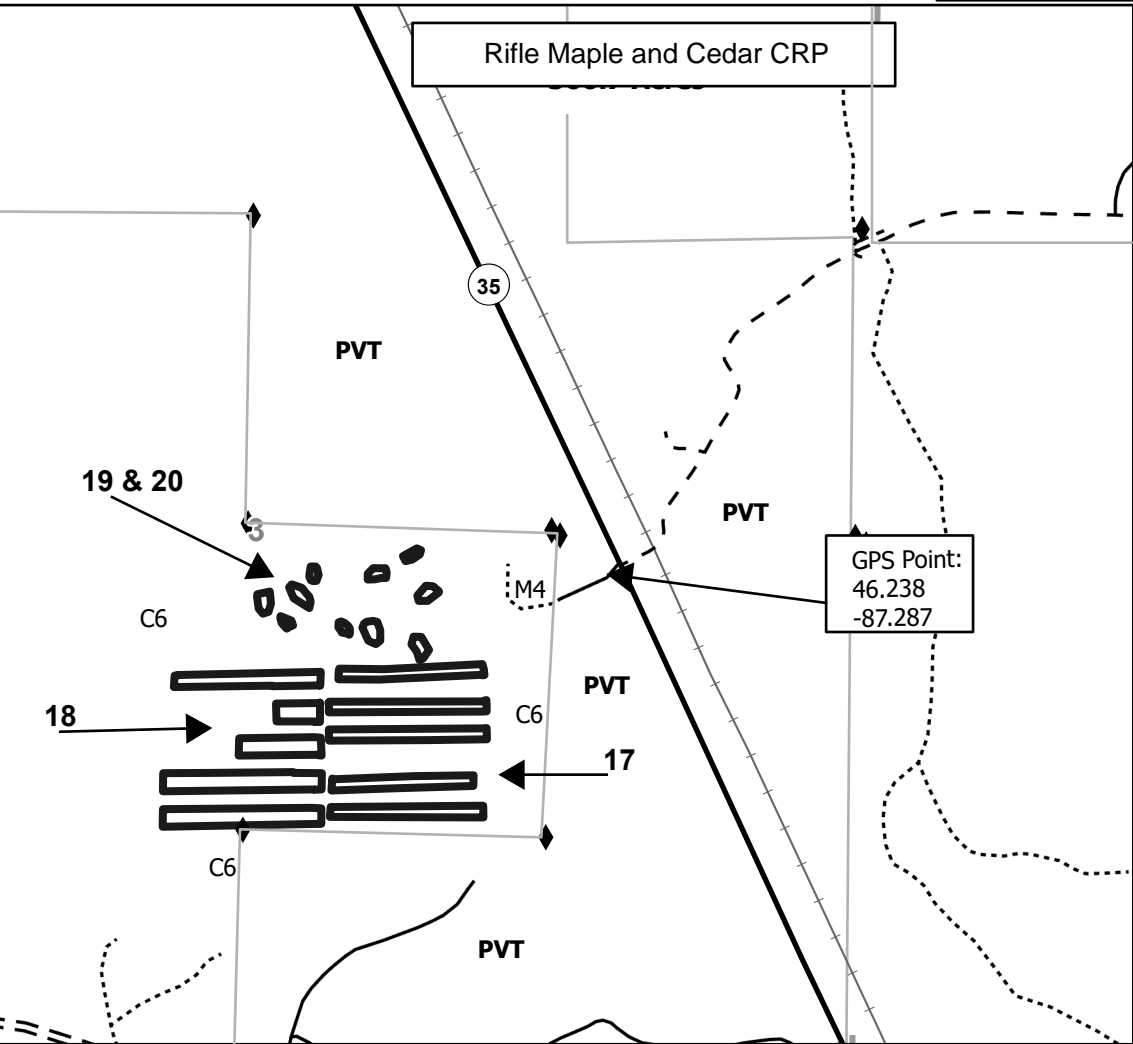
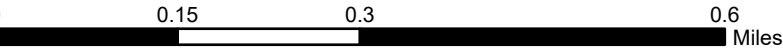
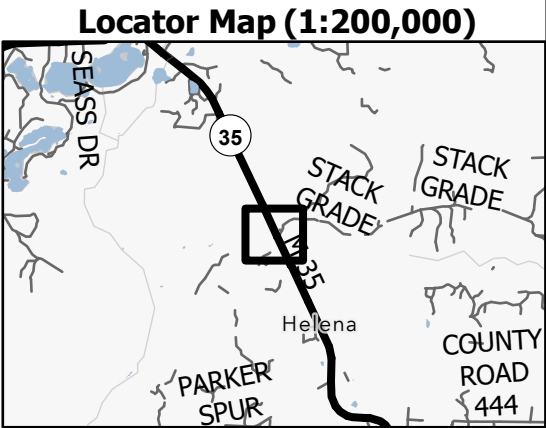

Legend	
	Against State (Red)
	State Boundary
	Forest Access Route
	Administrative Access Only
	Paved Road
	Private Gravel/Dirt
	Survey Grade Corner
	Section Corner

Use QR Code to open Map in App

