

**TIMBER SALE MAP**

This information provided by authority of Part 525, 1994 PA 451, as amended.

Sale Number

**32-005-25**

Date

**06/06/2025**

Forest Management Unit

Gwinn Mgt Unit

County

Marquette

Mapped By: Gould

Cruised By: Siler, Caron

Scale

1:24,000

Page

1

Of

1

Township

46N

Range

28W /

Section(s) and

Subdivision(s)

Sec. 30 S1/2NW,N1/2SW; Sec. 35 SESW; Sec. 36 SENE,NESW,N1/2SE,SWSE;

**Cover Type**

A = Aspen	J = Jack Pine	O = Oak	U = Upland Brush
B = Paper Birch	K = Rock	P = Lowland Poplar	UM = Upland Mix Forest
C = Cedar	L = Lowland Brush	Q = Mixed Swamp Conifer	V = Bog or Marsh
D = Treed Bog	LM = Lowland Mix Forest	R = Red Pine	W = White Pine
E = Swamp Hardwoods	M = Maple, Beech, Birch	S = Black Spruce	X = Non Stocked
F = Spruce/Fir	MC = Mixed Conifer	T = Tamarack	Y = Sand
G = Grass	MD = Mixed Deciduous	Z = Water	
H = Hemlock	N = Marsh		

**Density**

0 = Non Stocked	5 = Pole Timber Medium
1 = Seedling Sapling Poor	6 = Pole Timber Well
2 = Seedling Sapling Medium	7 = Saw Timber Poor
3 = Seedling Sapling Well	8 = Saw Timber Medium
4 = Pole Timber Poor	9 = Saw Timber Well

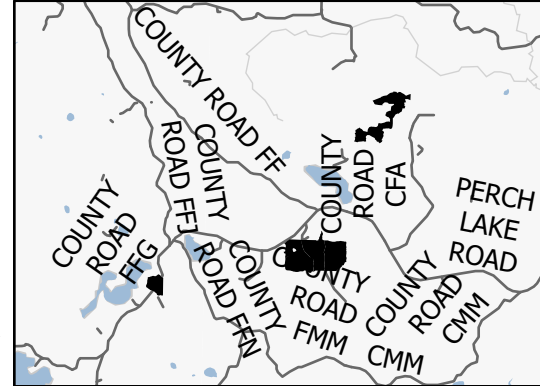
**Locator Map 1:100,000**

Payment Unit Number	Acres
1	30.5
2	22.9
3	25.9
4	11.4
5	38.2

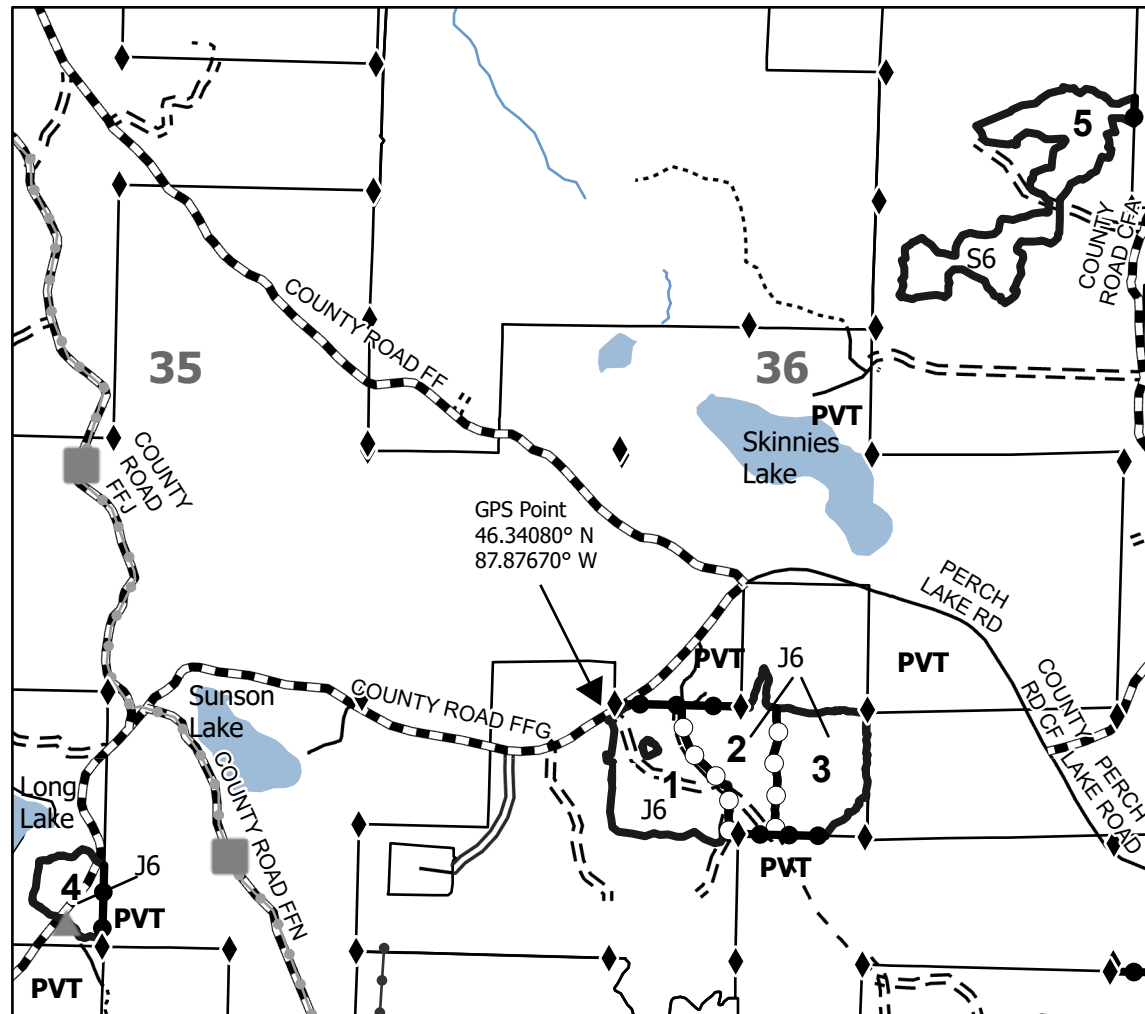
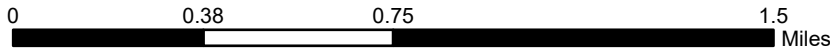
**Dry Pancake Pine****128.9 Acres****Compartment 32225****Legend**

- Against State (Red)
- Private Line (Blue)
- Payment Unit (Yellow)
- Primary Forest Road
- == Forest Access Route
- ..... Administrative Access Only
- Paved Road
- Government Gravel/Dirt
- - - Private Gravel/Dirt
- Powerline
- Recreational Trails
- ◆ Survey Grade Corner
- ▲ Berm

Use QR Code to  
open Map in App