



# TIMBER SALE MAP

This information provided by authority of Part 525, 1994 PA 451, as amended.

Sale Number	Year
61 - 108	18

Forest Management Unit Traverse City		County Kalkaska	Mapped By Crigier	Date 12/19/2017	Page 1	of 1
Township 28N	Range 06W	Section(s) and Subdivision(s) Sec: 5, 6, 7, 8 (see proposal)		Scale 1:15,840		

Cover Type				Density	
A = Aspen	H = Hemlock	N = Marsh	U = Upland Brush	0 = Non Stocked	5 = Pole Timber Medium
B = Paper Birch	J = Jack Pine	O = Oak	UM = Upland Mixed	1 = Seedling Sapling Poor	6 = Pole Timber Well
C = Cedar	L = Lowland Brush	P = Lowland Poplar	V = Bog or Marsh	2 = Seedling Sapling Medium	7 = Saw Timber Poor
D = Treed Bog	LM = Lowland Mixed	Q = Mixed Swamp Conifer	W = White Pine	3 = Seedling Sapling Well	8 = Saw Timber Medium
E = Swamp Hdwoods	M = Mpl, Bch, Brch	R = Red Pine	X = Non Stocked	4 = Pole Timber Poor	9 = Saw Timber Well
F = Spruce Fir	MC = Mixed Conifer	S = Black Spruce	Z = Water		
G = Grass	MD = Mixed Deciduous	T = Tamarack			

## PorcuPine Compartment 175 369.7 Acres

PU	Acres	PU	Acres
1	13.1	6	25.6
2	23.4	7	36.4
3	37.4	8	55.4
4	52.5	9	66.0
5	24.0	10	36.0

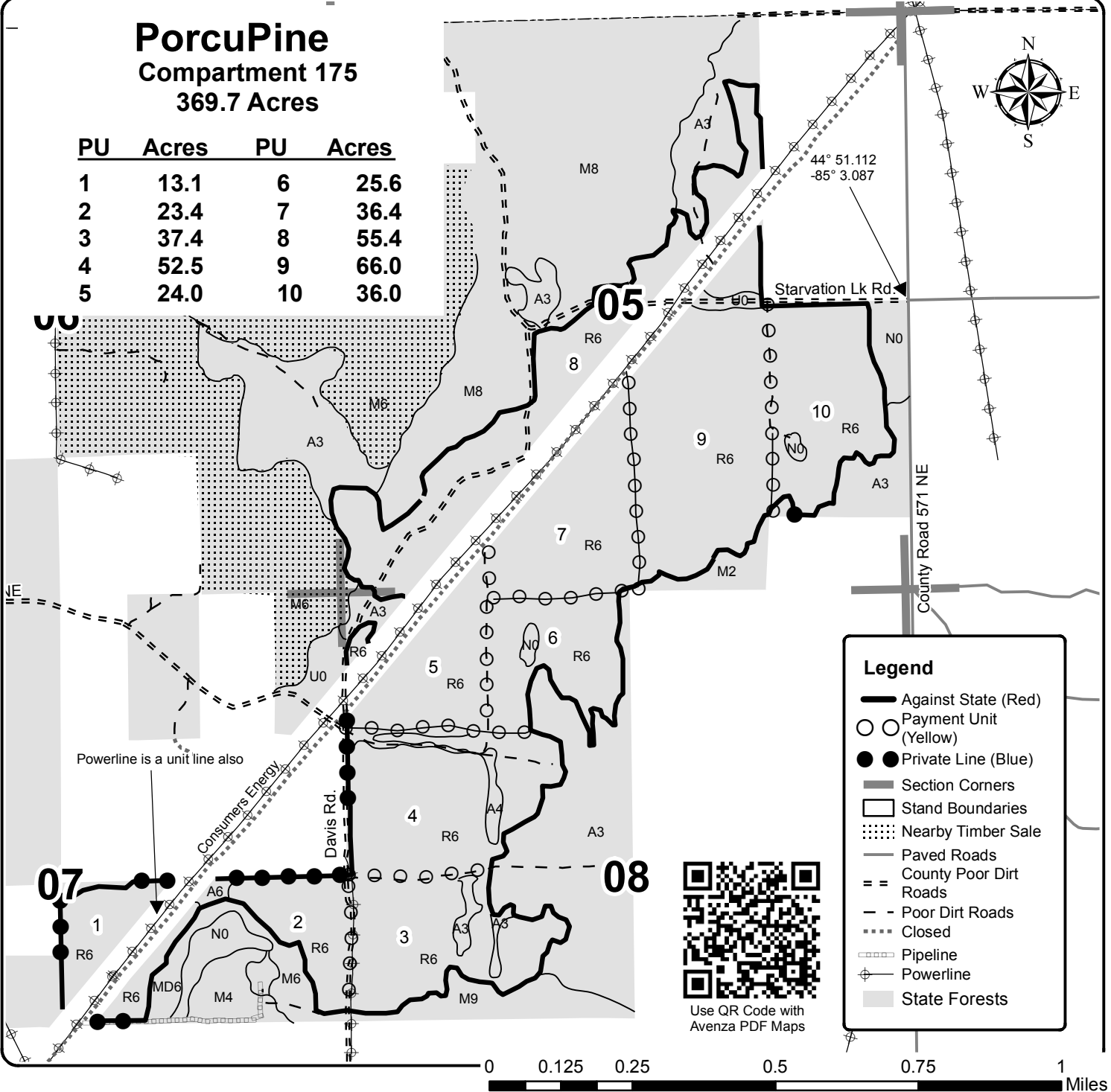

### Legend

- Against State (Red)
- ○ Payment Unit (Yellow)
- ● Private Line (Blue)
- Section Corners
- Stand Boundaries
- ⋯ Nearby Timber Sale
- Paved Roads
- = = County Poor Dirt Roads
- - Poor Dirt Roads
- ⋯ Closed
- Pipeline
- ⚡ Powerline
- State Forests

