



# TIMBER SALE MAP

This information provided by authority of Part 525, 1994 PA 451, as amended.

Forest Management Unit Sault Ste Marie FMU	County Mackinac	Mapped By Fanelli	Date 08/26/2020	Page 1	of 1
Township 43N	Range 10W	Section(s) and Subdivision(s) Sec 18: S1/2SW; Sec 19: N1/2NW, SENW, N1/2NE; Sec 20: NWSW	Scale 1:15,840		

Cover Type				Density	
A = Aspen	H = Hemlock	N = Marsh	U = Upland Brush	0 = Non Stocked	5 = Pole Timber Medium
B = Paper Birch	J = Jack Pine	O = Oak	UM = Upland Mixed	1 = Seedling Sapling Poor	6 = Pole Timber Well
C = Cedar	L = Lowland Brush	P = Lowland Poplar	V = Bog or Marsh	2 = Seedling Sapling Medium	7 = Saw Timber Poor
D = Treed Bog	LM = Lowland Mixed	Q = Mixed Swamp Conifer	W = White Pine	3 = Seedling Sapling Well	8 = Saw Timber Medium
E = Swamp Hdwoods	M = Mpl, Bch, Brch	R = Red Pine	X = Non Stocked	4 = Pole Timber Poor	9 = Saw Timber Well
F = Spruce Fir	MC = Mixed Conifer	S = Black Spruce	Z = Water		
G = Grass	MD = Mixed Deciduous	T = Tamarack			

PU	Acres	PU	Acres
1	24.5	4	11.3
2	16.1		
3	28.0		

## Bedrock Mix

### Compartment 173

#### 79.9 Acres

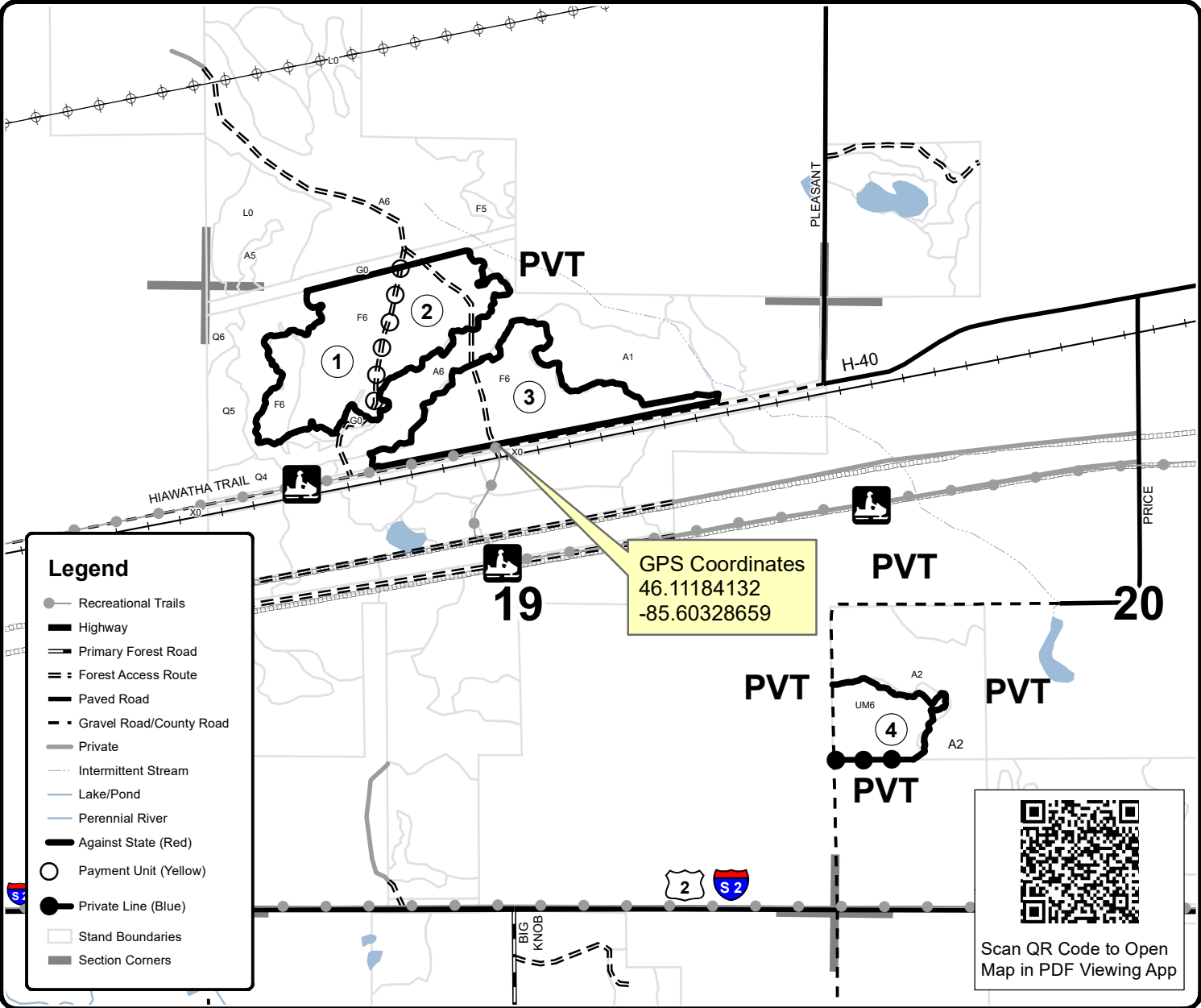

Legend	
	Recreational Trails
	Highway
	Primary Forest Road
	Forest Access Route
	Paved Road
	Gravel Road/County Road
	Private
	Intermittent Stream
	Lake/Pond
	Perennial River
	Against State (Red)
	Payment Unit (Yellow)
	Private Line (Blue)
	Stand Boundaries
	Section Corners

Scan QR Code to Open Map in PDF Viewing App

