



TIMBER SALE MAP

This information provided by authority of Part 525, 1994 PA 451, as amended.

Forest Management Unit	County	Mapped By	Date	Page	of
Sault Ste Marie Management Unit	Mackinac & Luce	A Krugh	09/27/2018	1	1
Township	Range	Section(s) and Subdivision(s)	Scale		
44N & 45N	10W & 11W	5 S1/2NW 6 NWNW,NWSW 1 NW,N1/2NE,SWNE,SW,N1/2SE 2 E1/2NE,E1/2SE 36 SESW,S1/2SE	1:31,680		

Cover Type				Density	
A = Aspen	H = Hemlock	N = Marsh	U = Upland Brush	0 = Non Stocked	5 = Pole Timber Medium
B = Paper Birch	J = Jack Pine	O = Oak	UM = Upland Mixed	1 = Seedling Sapling Poor	6 = Pole Timber Well
C = Cedar	L = Lowland Brush	P = Lowland Poplar	V = Bog or Marsh	2 = Seedling Sapling Medium	7 = Saw Timber Poor
D = Treed Bog	LM = Lowland Mixed	Q = Mixed Swamp Conifer	W = White Pine	3 = Seedling Sapling Well	8 = Saw Timber Medium
E = Swamp Hdwoods	M = Mpl, Bch, Brch	R = Red Pine	X = Non Stocked	4 = Pole Timber Poor	9 = Saw Timber Well
F = Spruce Fir	MC = Mixed Conifer	S = Black Spruce	Z = Water		
G = Grass	MD = Mixed Deciduous	T = Tamarack			

Swatter House HW

Compartment 181

362.4 Acres

PU	Acres	PU	Acres	PU	Acres	PU	Acres
1	30.2	5	28.4	9	26.8	13	3.5
2	31.5	6	21.8	10	17.2	14	27.8
3	38.1	7	14.4	11	39.6		
4	25.9	8	36.4	12	20.8		

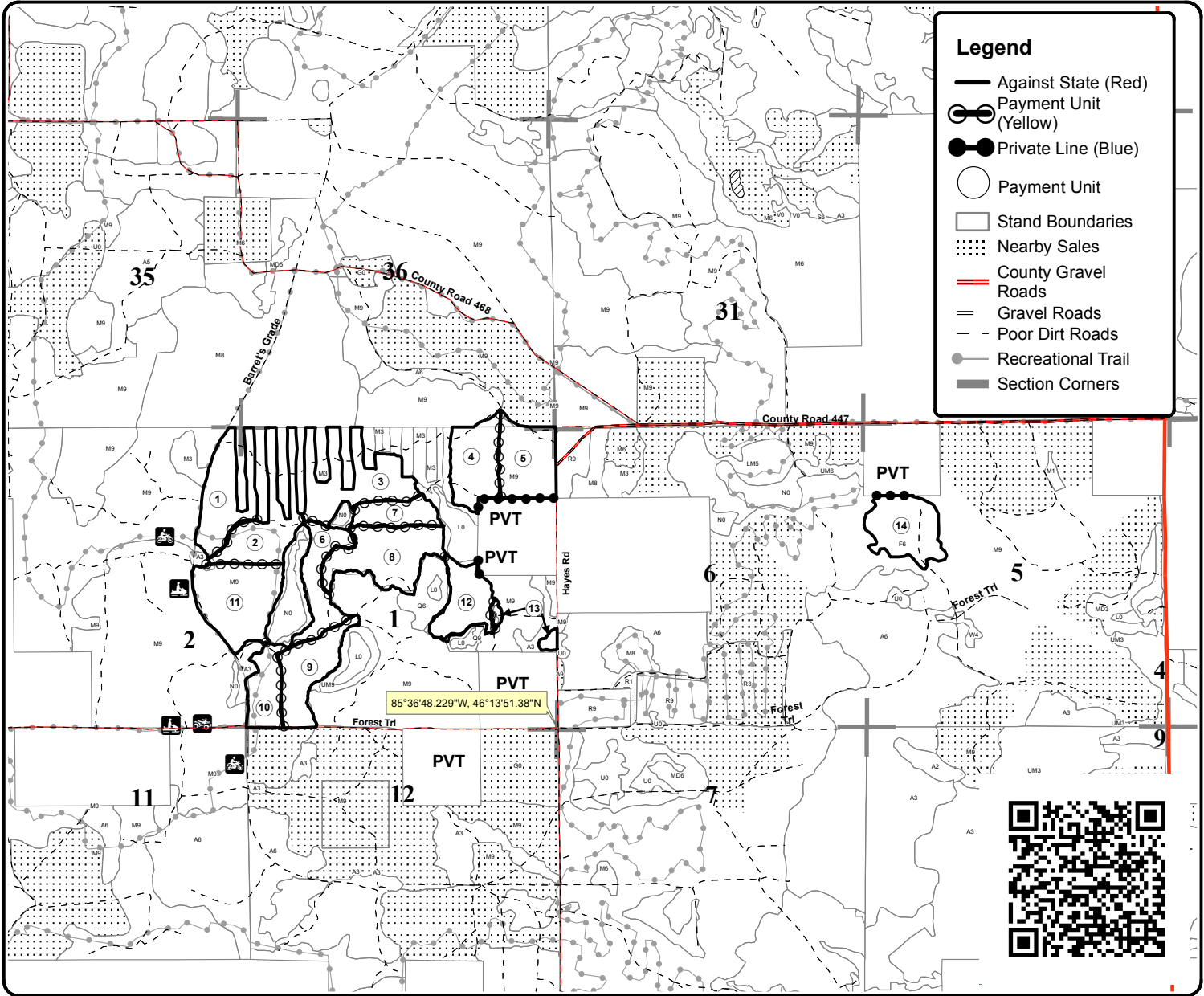

Legend

- Against State (Red)
- ⊖ Payment Unit (Yellow)
- Private Line (Blue)
- Payment Unit
- Stand Boundaries
- ▨ Nearby Sales
- County Gravel Roads
- ≡ Gravel Roads
- - Poor Dirt Roads
- Recreational Trail
- Section Corners

