

Grayling

Ogemaw

UMLMWS/Martell  
UMLMWS

7/12/21

1

1

24N

03E

Sec. 6 - SENW, S/12NE, SW, SE; Sec. 7 - NENW, S1/2NW, SW, NWSE, S1/2SE;  
Sec. 18 - NWNE

1:15,840

PU	Acres	PU	Acres
1	25.2	5	36.4
2	23.7	6	31.6
3	30.1	7	43.4
4	37.0		

# GNA2 Bass Lake Aspen

## Compartment 7925187

### 227.4 Acres

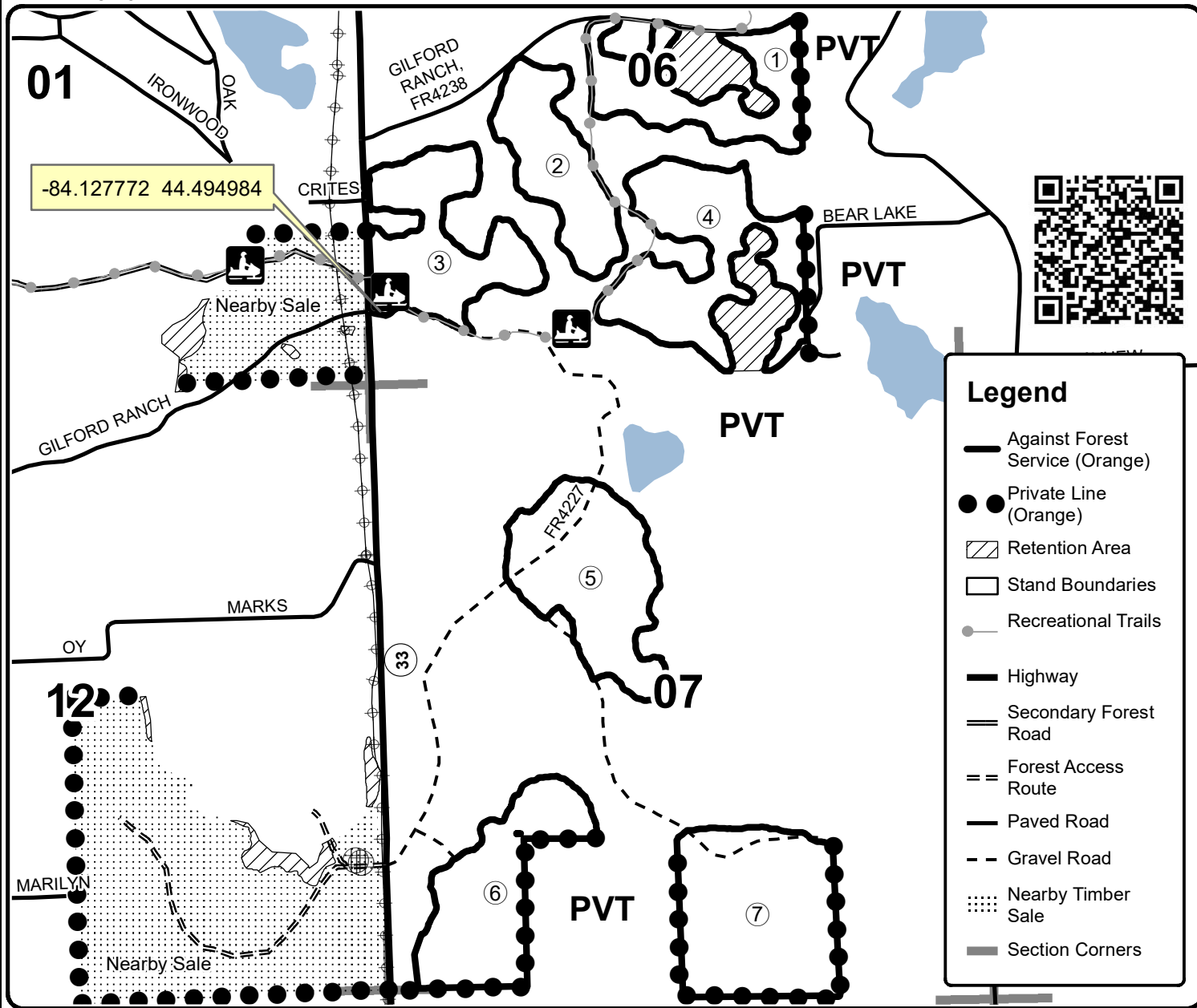

### Legend

- Against Forest Service (Orange)
- Private Line (Orange)
- Retention Area
- Stand Boundaries
- Recreational Trails
- Highway
- Secondary Forest Road
- Forest Access Route
- Paved Road
- Gravel Road
- Nearby Timber Sale
- Section Corners

