



### TIMBER SALE MAP

This information provided by authority of Part 525, 1994 PA 451, as amended.

Sale Number <b>41-003-23</b>	Date <b>09/15/2023</b>	
Scale <b>1:15,840</b>	Page <b>1</b>	Of <b>1</b>

Forest Management Unit <b>Shingleton Mgt Unit</b>	County <b>Schoolcraft</b>	Mapped By: <b>Luoto</b>
		Cruised By: <b>Gould</b>

Township <b>45N</b>	Range <b>13W</b>	Section(s) and Subdivision(s) <b>Sec. 13 SESW; Sec. 24 NENW,NE,E1/2SE;</b>
------------------------	---------------------	-------------------------------------------------------------------------------

Cover Type			
A = Aspen	J = Jack Pine	O = Oak	U = Upland Brush
B = Paper Birch	K = Rock	P = Lowland Poplar	UM = Upland Mix Forest
C = Cedar	L = Lowland Brush	Q = Mixed Swamp Conifer	V = Bog or Marsh
D = Treed Bog	LM = Lowland Mix Forest	R = Red Pine	W = White Pine
E = Swamp Hardwoods	M = Maple, Beech, Birch	S = Black Spruce	X = Non Stocked
F = Spruce/Fir	MC = Mixed Conifer	T = Tamarack	Y = Sand
G = Grass	MD = Mixed Deciduous	Z = Water	
H = Hemlock	N = Marsh		

Density	
0 = Non Stocked	5 = Pole Timber Medium
1 = Seedling Sapling Poor	6 = Pole Timber Well
2 = Seedling Sapling Medium	7 = Saw Timber Poor
3 = Seedling Sapling Well	8 = Saw Timber Medium
4 = Pole Timber Poor	9 = Saw Timber Well

PU #	Acres	PU #	Acres
1	14.6	4	20.6
2	23.4	5	21.6
3	22.9	6	14.1

## Hufflepuff Hardwoods

**117.3 Acres**

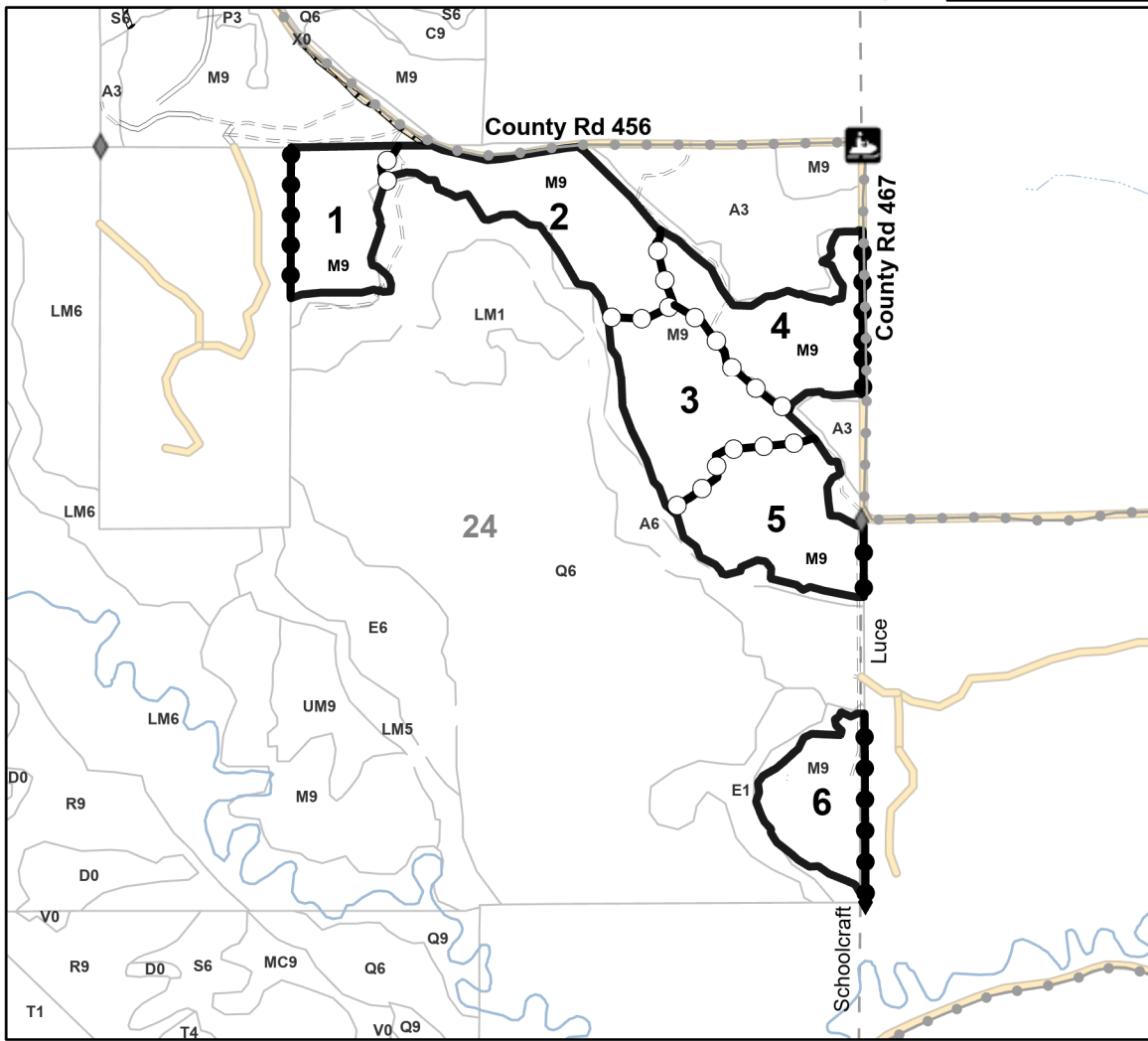
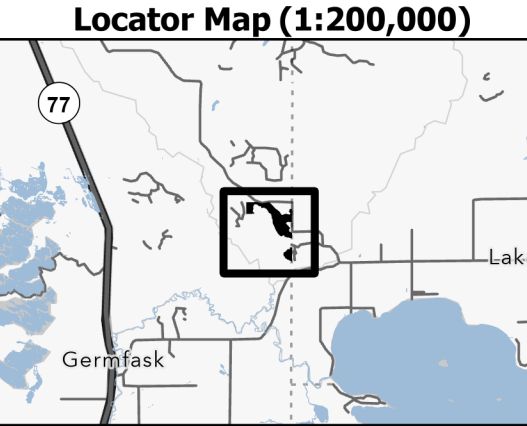

### Legend

- Sale Boundary (Red)
- Payment Unit (Yellow)
- Private Line (Blue)
- Recreational Trail
- Survey Corner
- Counties
- Intermittent Stream
- Perennial River
- Timber Sale Map Generic Lines
- Retention Areas
- Stand
- Primary Forest Road
- Secondary Forest Road
- Forest Access Route
- Administrative Access Only
- Non-DNR Road

Use QR Code to open Map in App

