



# TIMBER SALE MAP

This information provided by authority of Part 525, 1994 PA 451, as amended.

Forest Management Unit		County	Mapped By	Date	Page	of
Shingleton		Schoolcraft	Steve Tuovila	9/23/2019	2	2
Township	Range	Section(s) and Subdivision(s)		Scale		
see below	see below	see below		1:15,840		

Cover Type				Density	
A = Aspen	H = Hemlock	N = Marsh	U = Upland Brush	0 = Non Stocked	5 = Pole Timber Medium
B = Paper Birch	J = Jack Pine	O = Oak	UM = Upland Mixed	1 = Seedling Sapling Poor	6 = Pole Timber Well
C = Cedar	L = Lowland Brush	P = Lowland Poplar	V = Bog or Marsh	2 = Seedling Sapling Medium	7 = Saw Timber Poor
D = Treed Bog	LM = Lowland Mixed	Q = Mixed Swamp Conifer	W = White Pine	3 = Seedling Sapling Well	8 = Saw Timber Medium
E = Swamp Hdwoods	M = Mpl, Bch, Brch	R = Red Pine	X = Non Stocked	4 = Pole Timber Poor	9 = Saw Timber Well
F = Spruce Fir	MC = Mixed Conifer	S = Black Spruce	Z = Water		
G = Grass	MD = Mixed Deciduous	T = Tamarack			

46N 13W	6 NWNW
46N 14W	1 NENE
47N 13W	30 W1/2NW,SWSW
47N 13W	31 SWSW
47N 14W	25 SENW,NE,E1/2SW,SE
47N 14W	36 S1/2NW,NE,SW,SE

## Red Pine vs. White Pine

### map 2 of 2

### 434.4 Acres

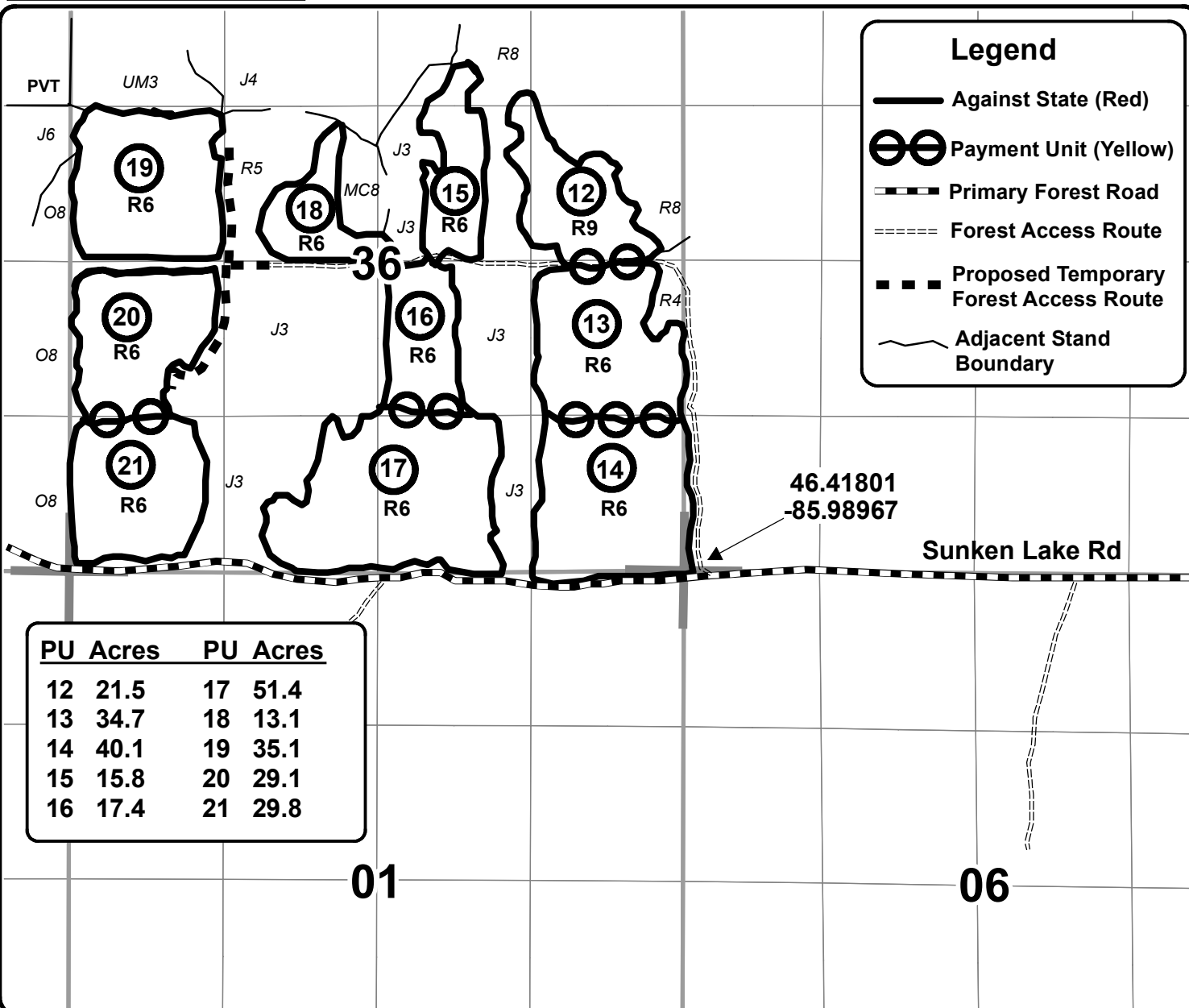
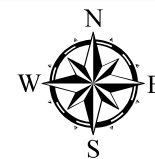

PU Acres	PU Acres	PU Acres	PU Acres
12	21.5	17	51.4
13	34.7	18	13.1
14	40.1	19	35.1
15	15.8	20	29.1
16	17.4	21	29.8

01

06

