



TIMBER SALE MAP

This information provided by authority of Part 525, 1994 PA 451, as amended.

Sale Number 41-010-23	Date 09/19/2023	
Scale 1:15,840	Page 1	Of 1

Forest Management Unit Shingleton Mgt Unit	County Schoolcraft	Mapped By: Petrelius Cruised By: UMLMWS
---	-----------------------	--

Township 42N	Range 17W	Section(s) and Subdivision(s)	NW,NWNE,S1/2NE,N1/2SW,N1/2SE; Sec. 34 W1/2NE; Sec. 26 S1/2NW,S1/2NE,N1/2SW,N1/2SE; Sec. 26 SWSE; Sec. 27
-----------------	--------------	----------------------------------	---

Cover Type			
A = Aspen	J = Jack Pine	O = Oak	U = Upland Brush
B = Paper Birch	K = Rock	P = Lowland Poplar	UM = Upland Mix Forest
C = Cedar	L = Lowland Brush	Q = Mixed Swamp Conifer	V = Bog or Marsh
D = Treed Bog	LM = Lowland Mix Forest	R = Red Pine	W = White Pine
E = Swamp Hardwoods	M = Maple, Beech, Birch	S = Black Spruce	X = Non Stocked
F = Spruce/Fir	MC = Mixed Conifer	T = Tamarack	Y = Sand
G = Grass	MD = Mixed Deciduous	Z = Water	
H = Hemlock	N = Marsh		

Density	
0 = Non Stocked	5 = Pole Timber Medium
1 = Seedling Sapling Poor	6 = Pole Timber Well
2 = Seedling Sapling Medium	7 = Saw Timber Poor
3 = Seedling Sapling Well	8 = Saw Timber Medium
4 = Pole Timber Poor	9 = Saw Timber Well

Ski Trail Hardwood 2 424.5 Acres

Sale Map Gaps U1-5 Gaps U6-8 Gaps U9



Legend			
	Payment Unit		Highway
	Stand		Primary Forest Road
	Sections		Secondary Forest Road
	Against State (Yellow)		Forest Access Route
	Payment Unit (Yellow)		Administrative Access Only
	Private Line (Blue)		Non-DNR Road
	Recreational Trail		Survey Grade Corner

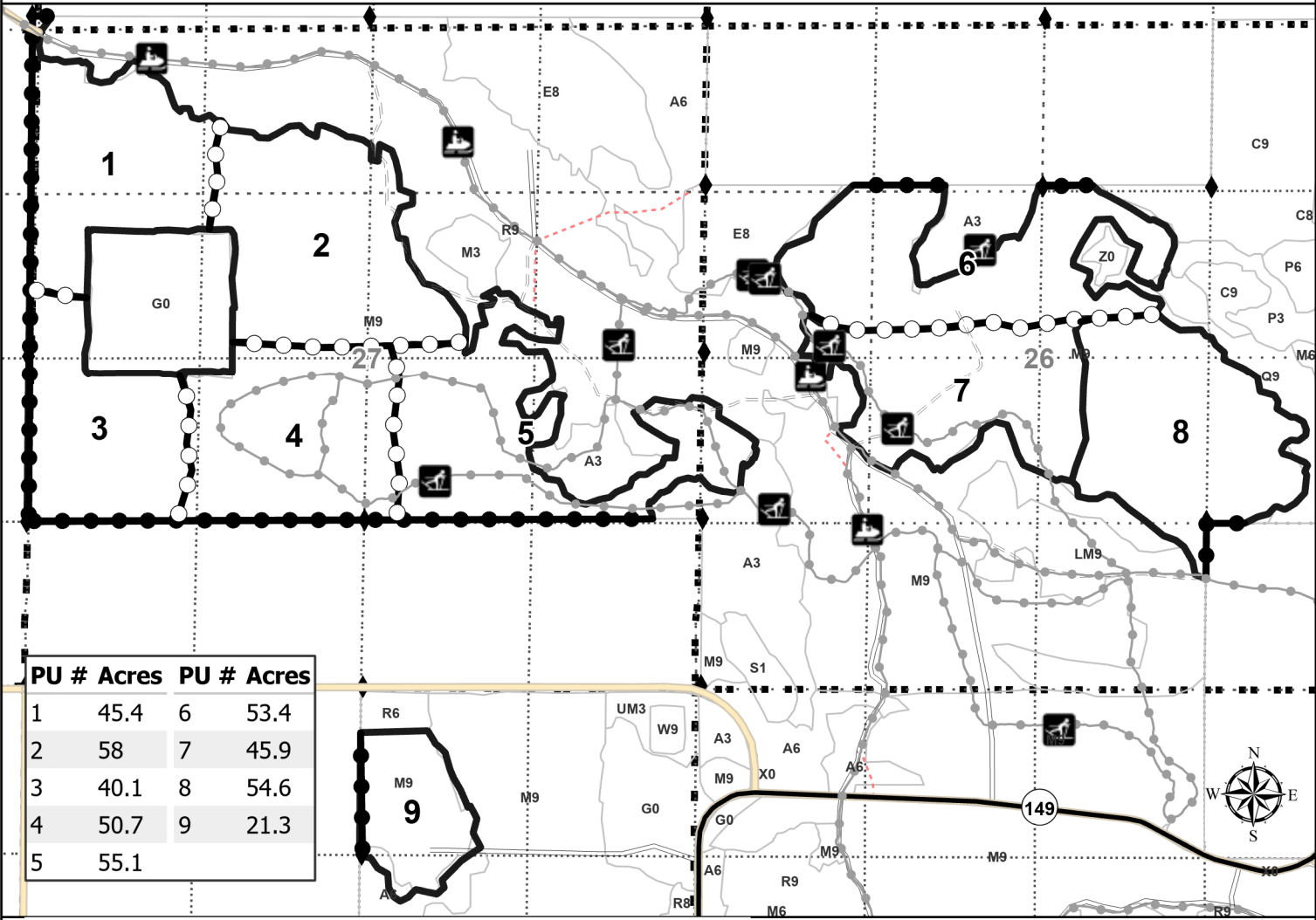

PU #	Acres	PU #	Acres
1	45.4	6	53.4
2	58	7	45.9
3	40.1	8	54.6
4	50.7	9	21.3
5	55.1		