



**DEPARTMENT OF NATURAL RESOURCES
STATE OF MICHIGAN
TIMBER SALE PROSPECTUS #7746**

SCHEDULED SALE DATE AND TIME: 3:00 p.m. (local time) on March 11, 2026.

LOCATION: ESCANABA MGMT UNIT, 6833 US-2, 41 & M-35, GLADSTONE, MI 49837.

PROSPECTUS NOTE: The bidder is advised to inspect the sale area and review the location, estimated volumes, operating costs and contract terms of proposed sales. Please be aware that some landowners may request 60 days or more notice for access across their land.

Notice is hereby given that bids will be received by the Unit Manager, CRYSTAL FALLS MANAGEMENT UNIT, for certain timber on the following described lands:

Twin Morels (12-011-25) / T40N, R28W, SEC. 5 , SWSW.
T40N, R28W, SEC. 6 , SE.
T40N, R28W, SEC. 7 , NW,NE,N1/2SE.
T40N, R29W, SEC. 1 , S1/2SW.
T40N, R29W, SEC. 12, N1/2NW,SENE.

Dickinson County, Advertised Price \$65,250.25, 221.6 Acres, Hardwood, Aspen.

SALE NOTE: Extensive road work is required on this sale. The advertised price has been reduced by the estimate cost of this road work to off-set the additional expense. Units 1 and 8 are winter cut only. Road work must be completed before cutting can begin. Sale has been discounted \$20,000 for extensive road work which includes gravel hauling, spreading, shaping, culvert installation, and ditching.

A recreation site such as a trail, pathway, or campground is within the sale area or the vicinity. Certain restrictions/specifications may be applicable including time restrictions. Access may be through private or other public land.

Red Eye Hazel (12-012-25) / T41N, R29W, SEC. 16, SESE.
T41N, R29W, SEC. 22, NENW,N1/2NE.
T41N, R29W, SEC. 23, S1/2NE,NESE.
T41N, R29W, SEC. 24, SWNW,N1/2SW,SWSW.

Dickinson County, Advertised Price \$60,320.40, 105.7 Acres, Aspen, Red Pine.

SALE NOTE: A recreation site such as a trail, pathway, or campground is within the sale area or the vicinity. Certain restrictions/specifications may be applicable including time restrictions.

MM Line Hardwoods (33-007-25) / T41N, R25W, SEC. 6 , N1/2NW.

T41N, R25W, SEC. 8 , SW.

T41N, R26W, SEC. 2 , NENW,N1/2NE.

T42N, R26W, SEC. 36, N1/2NW,NE.

Menominee County, Advertised Price \$69,165.95, 125.5 Acres, Hardwood, Red Pine.

SALE NOTE: Miscellaneous species 2 is dead/dying ash.

Alternative access through private property is the responsibility of the purchaser for Payment unit(s) 1,2,3, and 4.

Payment Unit(s) 2,5,6,7, and 8 cutting and skidding is not permitted during April 15th to July 15th. Payment Unit(s) 1,2,3, and 4 are limited to 12/1 to 3/31 or frozen ground conditions due to access road through Lyme land.

Contact: George Wilson (906)-203-8079

Access may be through private or other public land.

Skidmore Beaver (33-031-24) / T41N, R26W, SEC. 10, S1/2NW,N1/2SW,SWSW.

T41N, R26W, SEC. 15, NWNW.

T41N, R26W, SEC. 16, W1/2NE.

T41N, R26W, SEC. 2 , NWNW.

T41N, R26W, SEC. 3 , SWSW.

Menominee County, Advertised Price \$45,214.65, 124.4 Acres, Aspen, Spruce/Fir/Tamarack.

SALE NOTE: Payment unit 5 is limited to frozen ground conditions or very dry summer. Payment unit 1 no cutting from April 15th to July 15th.

Access may be through private land.

BID INSTRUCTIONS (VER. 10/10/2022):

1. Scheduled Bid Location, Date, and Time (2/11)

Bids must be received by the Unit Manager, ESCANABA OFFICE, 6833 US-2, 41 & M-35, Gladstone, MI 49837, no later than 3:00 p.m. (local time) on March 11, 2026. For further information concerning this sale, contact Dan Racine at 906-789-8231.

2. Bidder's Qualifications (10/22)

If all or part of a timber sale was prepared by a private contractor, the contractor and that contractor's company are not permitted to bid on the timber sale. A person must be 18 years of age or older to purchase timber. Permanent employees of the Department of Natural Resources or members of their immediate household may not bid. Former employees, in the permanent or seasonal class, may not bid until 3 months after the last day of active duty. Bids will not be accepted from individuals or companies appearing on the DNR/FRD No-Bid List. This list contains the names of purchasers who previously failed to execute a contract within 21-days or who have a history of poor performance.

3. Preparation of Sealed Bids (5/16)

Bid Forms may be completed online thru Michigan DNR Timber Sale Online Bidding (OLB) at www.michigan.gov/timberbidding or by completing the hardcopy Bid Form found in the Timber Sale Prospectus. Hardcopy Bid Forms shall be manually signed in ink. Registration in OLB is considered your 'signature' for all bids submitted thru that system. Bid prices must be entered for each species and product in the Bid Price column for all material subject to bidding and all fill-in blanks must be completed. If erasures or other changes appear on the hardcopy Bid Form, each erasure or change must be initialed by the person signing the bid.

4. Submission of Sealed Bids (5/16)

Bid forms may be obtained from the Unit Manager or thru OLB. Bids may be submitted hardcopy or thru OLB. All hardcopy bids must be submitted on the bid form and in an envelope clearly identified as described in this section. NOTE: Only one bid form per bid envelope. Sealed bids must be submitted to the Unit office designated in the prospectus and must be submitted at or prior to the time established in the prospectus. The envelope should show on the outside (a) the sale name or number and (b) the date and time of bid opening, as shown in the prospectus. Bids received after the time specified in the sale prospectus are late bids and will be rejected.

It is possible for a bidder to submit multiple bids on a single sale. For example, a bid may be submitted hardcopy and a bid may be submitted thru OLB. Or, two bidders from the same company could both submit bids on the same sale. If this were to happen, the State would accept all bids received and award the contract accordingly. All bidding and contractual requirements would apply to all bids received.

5. Public Opening of Sealed Bids (7/16)

If conditions permit, the sealed bids will be publicly opened and posted at the time and place set in the prospectus.

If a bidder, present at a bid opening, has submitted bids on more than one sale, that bidder may withdraw their unopened bid envelopes or announce the withdrawal of their online bid after being declared the successful bidder on one sale.

6. Award of Contract (1/11)

Award of the contract will be made to the Bidder whose bid, conforming to the prospectus, is most advantageous to the State of Michigan on the basis of total value at rates bid for the estimated quantities. The State reserves the right to reject any bid or waive any minor irregularity in bids received. A written award mailed (or otherwise furnished) to the successful Bidder shall be deemed to result in a binding contract without further action by either party.

7. Down Payment (1/11)

The Bidder to whom award is made must make a down payment within 21 days of the sale award. The amount of the down payment will be calculated as shown in the Bond and Payment Schedule of this prospectus. Only cash may be used to meet this requirement.

8. Performance Security (1/11)

As guarantee of faithful performance, a cash bond, certificate of deposit, surety bond or irrevocable letter of credit (LOC) is required within 21 days of the sale award. The amount of the performance security is shown in the Bond and

Payment Schedule of this prospectus. If an LOC or surety is used, the coverage must extend for at least 6 months beyond the contract expiration.

9. Worker's Compensation (10/22)

Purchaser shall obtain worker's compensation insurance to cover claims under Michigan's Worker's Disability Compensation Act of 1969 or similar employee benefit act of any other state applicable to an employee. Verification of Worker's Disability Compensation Act Compliance must be completed and submitted within 21 days of contract award and prior to the issuance of the timber sale contract. In addition, if applicable, Notice of Exclusion or Certificate of Insurance must also be submitted.

10. Timber Sale Contract (10/22)

Additional conditions and requirements common to all timber sales are listed on the timber sale contract (R4031) and are available on line at www.michigan.gov/timber. Contact the Unit Manager for additional information or a sample contract. Within 21 days of the date of the award letter, the bidder must sign the contract and provide the required down payment, performance security, and verification of worker's disability compensation. The down payment and performance security shall be in accordance with the provisions of the timber sale contract, in the sums stated in this prospectus. If these actions are not taken, then the Bidder, the Bidder's corporation, and the corporation's principals may not be permitted to bid on State timber sales for a period of 3 months after the first offense, 6 months after the second offense, and 1 year after the third offense. An offense will only be counted against the Bidder for 5 years. In addition, the Bidder certifies that if awarded this contract, the Bidder will complete the timber sale contract in accordance with its terms and any modifications thereof including requirements to purchase, cut, and remove the included timber by the expiration date.

Payment Unit values in the State Forest Timber Sale Contract are calculated based on the advertised value of the Payment Unit as a percentage of the total advertised value of the contract. The advertised value of each Payment Unit is given in the Description of Timber by Payment Unit table on the Timber Sale Information page. For example, if the value of Payment Unit 1 is advertised as \$1,500 and the total Timber Sale value is advertised as \$10,000, the contract price for Payment Unit 1 will be 15% of the total bid price ($\$1,500/\$10,000 * 100$).

11. Disclaimer of Estimates and Bidder's Warranty of Inspection (10/22)

Before submitting this bid, the Bidder is advised and cautioned to inspect the sale area, review the requirements of the sale contract, and take other steps as may be reasonably necessary to ascertain the location, estimated volumes, construction estimates, and operating costs of the proposed sale. Failure to do so will not relieve the Bidder from responsibility for completing the contract.

The Bidder warrants that this bid is submitted solely on the basis of the Bidder's examination and inspection of the quality and quantity of the timber offered for sale and the Bidder's opinion of the value thereof and the costs of recovery. No reliance should be placed on the State of Michigan's estimates of timber quality, quantity or costs of recovery. Bidder further acknowledges that the State of Michigan: (i) expressly disclaims any warranty of fitness of timber for any purpose; (ii) offers this timber as is without any warranty of quality (merchantability) or quantity and (iii) expressly disclaims any warranty as to the quantity or quality of timber sold.

12. Certification and Chain-of-Custody (10/22)

Unless otherwise indicated in the contract under section 7 – Other Conditions of the Sale Specific Conditions & Requirements, the area encompassed by this timber sale is certified to the standards of the Forest Stewardship Council (FSC) - Certificate #SCS-FM/COC-00090N and the Sustainable Forestry Initiative (SFI) - Certificate #NSF-SFIS-5Y031-SF5. Forest products from this sale may be delivered to the mill as "FSC 100% and / or SFI certified" as long as the contractor hauling the forest products is chain-of-custody (COC) certified or covered under a COC certificate from the destination mill. The purchaser is responsible for maintaining COC after leaving the sale area.

13. Good Neighbor Authority (GNA) Requirements (10/22)

If the name of this timber sales contains the acronym GNA, it is authorized by the Good Neighbor Authority (GNA) and covered by various agreements between the U.S. Forest Service and the State. The timber sale occurs on federal land and the following conditions apply:

GNA contracts on US Forest Service land will not be awarded to purchasers on the Federal list of excluded parties. The System for Award Management (SAM) will be checked for active excluded parties prior to award of contract. In

addition, the Bidder to whom award is made must complete an Assurance Regarding Felony Conviction or Tax Delinquent Status for Corporate Applicants (AD-3031).

14. Good Neighbor Authority (GNA) Requirements, con't (10/22)

Bidder certifies, by signing this bid form, that to the best of Bidder's knowledge that the following representations are accurate and complete.

- a. That the Bidder and its principals are not presently debarred, suspended, proposed for debarment, declared ineligible, or voluntary excluded from timber sales (covered transactions) by any Federal department or agency.
- b. That the Bidder and its principals have not within a 3-year period preceding this bid been convicted of or had a civil judgment rendered against them for commission of fraud or a criminal offense in connection with obtaining , attempting to obtain, or performing a public (Federal, State, or local) transaction or contract under a public transaction; violation of Federal or State antitrust statutes or commission of embezzlement, theft, forgery, bribery, falsification or destruction of records, making false statements, or receiving stolen property.
- c. That the Bidder and its principals are not presently indicted for or otherwise criminally or civilly charged by a governmental entity (Federal, State, or local) with commission of any of the offenses enumerated in paragraph b of this certification.
- d. That the Bidder and its principals have not within a 3-year period preceding this bid had one or more public transactions (Federal, State, or local) terminated for breach or default of a timber or forest product contract.

Bidders that cannot certify this requirement, in whole or in part, shall submit an explanation with their bid.

Scott Bowen
Director

TIMBER SALE INFORMATION

Twin Morels (12-011-25)

T40N, R28W, SEC. 5; T40N, R28W, SEC. 6; T40N, R28W, SEC. 7; T40N, R29W, SEC. 1; T40N, R29W, SEC. 12.

Dickinson County (Advertised Price \$65,250.25)

SALE NOTE: Extensive road work is required on this sale. The advertised price has been reduced by the estimate cost of this road work to off-set the additional expense. Units 1 and 8 are winter cut only. Road work must be completed before cutting can begin. Sale has been discounted \$20,000 for extensive road work which includes gravel hauling, spreading, shaping, culvert installation, and ditching.

A recreation site such as a trail, pathway, or campground is within the sale area or the vicinity. Certain restrictions/specifications may be applicable including time restrictions. Access may be through private or other public land.

A timber sale contract for this lump sum, sealed bid timber sale will be awarded to the responsible bidder offering the highest sealed bid price. All units of volume listed below were estimated using the Inventory Manager computer program and the new Michigan taper model. Bids must be at or above the following advertised price for each product and species:

<u>PRODUCTS & SPECIES</u>	<u>ESTIMATED UNITS*</u>	<u>ADVERTISED PRICE</u>
Sawtimber		
Basswood	118.6 MBF	\$ 39.00 / MBF
Paper Birch	9.0 MBF	\$ 69.00 / MBF
Red Maple	29.4 MBF	\$ 125.00 / MBF
Sugar Maple	128.6 MBF	\$ 230.00 / MBF
Yellow Birch	5.8 MBF	\$ 89.00 / MBF
Pulpwood		
Balsam Fir	132 Cords	\$ 4.15 / Cord
Misc. Species 1	210 Cords	\$ 2.85 / Cord
Mixed Hardwood	2,168 Cords	\$ 9.45 / Cord
Mixed Spruce	95 Cords	\$ 8.05 / Cord
Quaking Aspen	280 Cords	\$ 13.70 / Cord

* The total volume is statistically estimated within plus (+) or minus (-) 10.88 percent. There are an estimated 3,568 cords on this timber sale, plus or minus 388 cords at the 95% confidence level. The estimated units are final and not subject to adjustment. Prospective bidders are urged to examine this timber and to make their own estimates of quantity and quality.

BOND AND PAYMENT SCHEDULE:

1. A bond in the amount of \$6,525.00 to insure faithful performance of the conditions of the contract will be deposited by the successful bidder within 21 days of the sale award.
2. Cutting in any sale or unit without the required advance payment would be considered a trespass.
3. Total payment must be paid in advance or according to the following schedule :
 - (a) Ten percent (10%) of the sale value must be paid within 21 days of the sale award.
 - (b) The 10% down payment will be credited towards the first unit cut.
 - (c) Payment for each of the following units must be made before cutting begins in that unit:

<u>PAYMENT UNIT NUMBER</u>	<u>PERCENT OF TOTAL SALE VALUE</u>
01	15.2%
02	29.6%
03	12.0%
04	8.2%
05	8.1%
06	10.6%
07	5.1%
08	6.0%
09	5.2%

4. If no cutting takes place, the 10% down payment will not be refunded.
5. Operations on the contract issued will terminate on 06/30/2030.

SALE STATISTICS

Volumes were calculated in cubic feet using the Michigan taper model. Cubic foot volume includes all wood inside bark for the product indicated. For display purposes, cubic feet were converted to cords and MBF using a simple conversion factor, e.g. 79 cubic feet per cord and 185 cubic feet per MBF. The cubic foot volumes are precise; the cords and MBF volumes are not. Cubic foot volume cannot be directly converted to cords or boards with precision.

SALE VOLUMES

The total estimated sale volume may not equal the sum of the species/products due to the nature of statistical calculations associated with double sampling methodology.

VOLUME			STATISTICAL RANGE IN CORDS	
TOTAL CUBIC FEET	TOTAL CORDS	PERCENT ERROR	MINIMUM	MAXIMUM
281,845	3,568	10.88%	3,179	3,956

VDU VOLUMES

A VDU is a Volume Determination Unit. Volumes and their associated statistics are calculated at the VDU level and summarized to the sale level. There is often a one to one relationship between a VDU and a Payment Unit, but not always, depending on the cruise design. Refer to the VDU TO PAYMENT UNIT table.

	VOLUME			RANGE IN CORDS	
VDU	TOTAL CUBIC FEET	TOTAL CORDS	PERCENT ERROR	MINIMUM	MAXIMUM
6	55,192	699	17.16%	579	819
7	56,526	716	29.04%	508	923
18	23,624	299	56.91%	129	469
21	74,856	948	18.22%	775	1,120
27	22,693	287	50.63%	142	433
33	48,954	620	23.66%	473	766
TOTAL:	281,845	3,568		2,605	4,530

VDU TO PAYMENT UNIT

When a VDU is associated with more than one Payment Unit (PU), the VDU volumes are assigned to the PU based on acres of the VDU within the PU.

VDU	VDU ACRES	PU	PU ACRES
TOTAL:			

DESCRIPTION OF TIMBER BY PAYMENT UNIT (PU)

PU	MARKET GROUP	PRODUCT	QUANTITY	UNIT	ACRES	ADVERTISE PRICE
1	Basswood	Sawtimber	4.2	MBF	27.0	\$9,918.30
	Paper Birch		2.8	MBF		
	Red Maple	Pulpwood	14.8	MBF		
	Sugar Maple		8.1	MBF		
	Yellow Birch		2.4	MBF		
	Balsam Fir		75	Cords		
	Misc. Species 1		52	Cords		
	<i>Black Ash</i>		52	Cords		
	Mixed Hardwood		390	Cords		
	<i>Balsam Poplar</i>		10	Cords		
	<i>Basswood</i>		17	Cords		
	<i>Black Cherry</i>		19	Cords		
	<i>Ironwood</i>		2	Cords		
	<i>Paper Birch</i>		14	Cords		
	<i>Red Maple</i>		236	Cords		
	<i>Sugar Maple</i>		61	Cords		
	<i>Yellow Birch</i>		31	Cords		
	Mixed Spruce		37	Cords		
	<i>Black Spruce</i>		24	Cords		
	<i>White Spruce</i>		13	Cords		
	Quaking Aspen		87	Cords		
2	Basswood	Sawtimber	18.1	MBF	38.0	\$19,324.90
	Red Maple	Pulpwood	5.1	MBF		
	Sugar Maple		57.8	MBF		
	Misc. Species 1		20	Cords		
	<i>White Ash</i>		20	Cords		
	Mixed Hardwood		490	Cords		
	<i>Basswood</i>		17	Cords		
	<i>Red Maple</i>		39	Cords		
	<i>Sugar Maple</i>		434	Cords		
3	Basswood	Sawtimber	21.5	MBF	41.8	\$7,813.95
	Paper Birch		2.6	MBF		
	Sugar Maple	Pulpwood	19.6	MBF		
	Yellow Birch		2.0	MBF		
	Misc. Species 1		54	Cords		
	<i>Black Ash</i>		2	Cords		
	<i>White Ash</i>		52	Cords		
	Mixed Hardwood		207	Cords		
	<i>Basswood</i>		25	Cords		
	<i>Ironwood</i>		6	Cords		
	<i>Paper Birch</i>		8	Cords		
	<i>Red Maple</i>		2	Cords		
	<i>Sugar Maple</i>		148	Cords		
	<i>Yellow Birch</i>		18	Cords		
4	Basswood	Sawtimber	14.8	MBF	28.7	\$5,378.35
	Paper Birch		1.8	MBF		
	Sugar Maple	Pulpwood	13.5	MBF		
	Yellow Birch		1.4	MBF		
	Misc. Species 1		37	Cords		
	<i>Black Ash</i>		2	Cords		
	<i>White Ash</i>		35	Cords		
	Mixed Hardwood		142	Cords		
	<i>Basswood</i>		17	Cords		
	<i>Ironwood</i>		4	Cords		
	<i>Paper Birch</i>		6	Cords		
	<i>Red Maple</i>		2	Cords		

PU	MARKET GROUP	PRODUCT	QUANTITY	UNIT	ACRES	ADVERTISE PRICE
4 cont'	<i>Sugar Maple</i> <i>Yellow Birch</i>	<i>Pulpwood</i>	101 12	<i>Cords</i> <i>Cords</i>		
5	Basswood Red Maple Sugar Maple Misc. Species 1 <i>White Ash</i> Mixed Hardwood <i>Basswood</i> <i>Ironwood</i> <i>Red Maple</i> <i>Sugar Maple</i> Quaking Aspen	Sawtimber Pulpwood	20.3 3.2 7.9 15 15 228 25 1 43 159 4	MBF MBF MBF Cords <i>Cords</i> Cords <i>Cords</i> <i>Cords</i> <i>Cords</i> <i>Cords</i> Cords	23.5	\$5,260.85
6	Basswood Red Maple Sugar Maple Misc. Species 1 <i>White Ash</i> Mixed Hardwood <i>Basswood</i> <i>Ironwood</i> <i>Red Maple</i> <i>Sugar Maple</i> Quaking Aspen	Sawtimber Pulpwood	26.7 4.2 10.3 19 19 301 34 2 56 209 5	MBF MBF MBF Cords <i>Cords</i> Cords <i>Cords</i> <i>Cords</i> <i>Cords</i> <i>Cords</i> Cords	30.8	\$6,902.40
7	Basswood Red Maple Sugar Maple Misc. Species 1 <i>White Ash</i> Mixed Hardwood <i>Basswood</i> <i>Ironwood</i> <i>Red Maple</i> <i>Sugar Maple</i> Quaking Aspen	Sawtimber Pulpwood	13.0 2.1 5.0 9 9 146 16 1 27 102 2	MBF MBF MBF Cords <i>Cords</i> Cords <i>Cords</i> <i>Cords</i> <i>Cords</i> <i>Cords</i> Cords	15.0	\$3,352.25
8	Sugar Maple Balsam Fir Mixed Hardwood <i>Balsam Poplar</i> <i>Ironwood</i> <i>Sugar Maple</i> Mixed Spruce <i>White Spruce</i> Quaking Aspen	Sawtimber Pulpwood	6.4 47 131 94 2 35 50 50 44	MBF Cords Cords <i>Cords</i> <i>Cords</i> <i>Cords</i> Cords <i>Cords</i> Cords	7.0	\$3,910.30
9	Paper Birch Balsam Fir Misc. Species 1 <i>White Ash</i> Mixed Hardwood <i>Ironwood</i> <i>Paper Birch</i> <i>Red Maple</i> <i>Sugar Maple</i> Mixed Spruce <i>White Spruce</i> Quaking Aspen	Sawtimber Pulpwood	1.8 10 4 4 133 1 20 58 54 8 8 138	MBF Cords Cords <i>Cords</i> Cords <i>Cords</i> <i>Cords</i> <i>Cords</i> <i>Cords</i> Cords <i>Cords</i> Cords	9.8	\$3,388.95

TOTAL:	291.4	MBF
TOTAL:	2,885	Cords

Sale Specific Conditions & Requirements

Sale Name: Twin Morels

Sale Number: 12-011-25 Seq#: 1

1 - Sale Area

1.2 - Boundaries

1.2.1 - Painted Boundaries (9/19)

The sale boundary and Payment Unit boundaries are marked and identified by blue, red and yellow paint. Exterior sale boundary lines against private property are marked with blue paint. Exterior sale boundary lines against state are marked with red paint. Interior Payment Unit boundaries are marked with yellow paint. Retention patches are marked with red paint; no harvesting activities may occur within these areas. The painted boundary line trees are not Included Timber and are to be protected unless marked with orange paint. Yellow painted trees designating an interior Payment Unit boundary are only to be cut when all surrounding Payment Units have been paid.

2 - Timber Specifications

2.1 - Included Timber

2.1.1 - Clearcut Unit(s) with Unmerchantable Trees (6/14)

Within Payment Unit(s) 1 and 8, cut all species trees that are two (2) inches or more at DBH, except cedar, pine, hemlock, and oak.

2.1.2 - Clearcut Unit(s) w/o Unmerchantable Trees (8/11)

Within Payment Unit(s) 9, cut all aspen, birch, and all other species 6 inches or greater at DBH trees which meet minimum piece specifications in 2.2 Utilization, except do not cut pine, cedar, hemlock or oak.

2.1.3 - Cut Tree Marked Unit(s) (12/08)

Within Payment Unit(s) 2, 3, 4, 5, 6 and 7, all trees are designated for cutting when marked with orange paint above and below stump height, regardless of merchantability.

2.1.11 - Description of Timber Note (2/04)

Note that Misc. Species 1 is dead/dying black ash and white ash.

4 - Transportation

4.1 - Construction

4.1.5 - Culverts (5/14)

Roads will require the installation of culverts for cross drainage or at natural drainage-ways. If culverts are needed in these locations, their placement will be specified by the Sale Administrator, and they shall be installed prior to hauling. The culverts shall be new, corrugated metal or plastic HDPE dual walled culverts. Culverts will be a minimum of 18 inches in diameter and 24 feet in length. All culverts shall be permanently set into place. Soils shall be maintained and left in a non-erodible condition as specified in the BMP manual using methods directed and approved by the Sale Administrator. No stream crossing permits are required. The Purchaser shall supply culverts and facilitate or carry out their installation using approved BMP methods.

4.1.7 - Road Closure (10/11)

All new roads built into the sale must be blocked to vehicle traffic upon completion of the sale. Overgrown roads that are reopened shall be considered new roads. In general, this will require constructing a four (4') foot high berm of stumps and logs covered with earth. Stumps and brush must be placed along the remainder of the trail. These roads must be rendered impassable to cars and trucks. All stumps from road building and landing construction must be reserved to block any newly constructed roads upon completion of the sale. These stumps must be scattered along the road system to prohibit vehicular movement. Temporary berms may be required if no sale activity occurs for 30 or more consecutive days. Contact the Sale Administrator for specific details of design and placement.

4.1.8 - Road Work (1) (8/07)

The following road work is required: The Purchaser must purchase and install 4 new culverts. The culverts will be installed at the locations shown on the Timber Sale Roadwork Map. The Purchaser must also haul and spread ~1010 cubic yards of pit run gravel at locations shown on the Timber Sale Roadwork Map. The Purchaser must ditch part of the road shown on the

Timber Sale Roadwork map. A minimum of 12 inches of pit run gravel must be placed over the culverts. Contact the Sale Administrator for possible gravel sources. All road work must be completed prior to the commencement of harvest operations.

4.2 - Maintenance

4.2.3 - Road maintenance (8/13)

The following road maintenance is required: Within 60 days of completion of hauling, or if no hauling occurs for 60 days, the road must be maintained and graded. This includes cleaning of drainage areas, grading, crowning and filling with gravel, if necessary. Damages will be assessed if grading/repair does not occur.

4.2.4 - Grading (10/16)

For completion of the sale, state forest roads must be graded. In general, this will require a road grader or bulldozer to shape up the roads after forest products have been hauled off site. This includes cleaning of drainage areas, grading, crowning and filling with gravel, if necessary. The grading equipment to be used must be approved by the Unit Manager or his/her representative.

4.4 - Access

4.4.2 - Alternate route on private property (2/04)

It is the Purchaser's responsibility to obtain access across private land for any routes other than the route shown on the Timber Sale Map.

5 - Operations

5.2 - Conduct of Operations

5.2.1 - Slash

5.2.1.13 - Dispose of Slash as Directed (12/05)

Slash is to be disposed of as directed by the Sale Administrator.

5.2.3 - Operating Restrictions

5.2.3.1 - Operating Restrictions (9/11)

Within Payment Unit(s) 1 and 8, unless changed by written agreement, cutting, skidding, and hauling are limited to frozen or dry conditions. This restriction is because of wet soils.

5.2.3.3 - Bark Slippage Restriction (3/09)

Within Payment Unit(s) 2, 3, 4, 5, 6 and 7, unless changed by written agreement, cutting and skidding are not permitted during the period of April 15 to July 15. This restriction is because of bark slippage.

5.2.32 - Decking/Landing Restoration (9/13)

All decking and landing areas must have the surface area restored to a condition equal to or better than before. This is to ensure the proper regeneration of the stand. Wood debris, chips and "cookies" from trimmings must be removed or scattered away from landing and loading areas and may not be windrowed on the edge.

5.2.38 - No Decking Against Live Trees (2/04)

Cut products may not be decked against unmarked or designated leave trees.

5.2.39 - ORV Trail/Route Protection (4/18)

There is an ORV trail or route and its shown on the Timber Sale Map. Do not cut trees or damage posts with yellow ORV markers. All stumps within five (5) feet of the trail must be cut flush with the ground. Maintain a 20-foot-wide slash, debris, and rut free zone daily using the ORV trail or route as the centerline. Do not run equipment down the ORV trail or route. Skidding across the trail or route may only occur in locations approved by the Sale Administrator.

5.2.41 - Snowmobile Trail Protection (9/11)

The Blomgren Marsh Road is a snowmobile trail and is not shown on the Timber Sale Map. Do not cut or damage posts with orange trail markers or traffic control signs. If the trail is used, it must be maintained and restored to a condition equal to or better than before the sale. The road maintenance/restoration must be done prior to December 1. If the trail is used for hauling, it must be graded to the satisfaction of the Unit Manager or his/her representative prior to December 1. If the trail road is to be used for hauling during the snowmobile season, then a snow-covered base must be left on the trail. The

snowmobile trail may only be crossed at right angles. Maintain a 20-foot-wide slash, debris, and rut free zone daily using the snowmobile trail as the centerline. No decking of forest products will be permitted along the snowmobile trail.

5.4 - Soil Protection

5.4.1 - Rutting Restriction, General (7/16)

Operations are to cease immediately if equipment and weather conditions result in rutting of roads and/or skid trails which are 12 inches or greater in depth and 50 feet in length. The Unit Manager or his/her representative may restrict hauling and/or skidding if ruts exceed the specified depth. With the Unit Manager or his/her representative's approval, the Purchaser may return to the area when the risk of rutting has decreased.

6 - Safety and Fire Prevention

6.2 - Signing

6.2.2 - Snowmobile Trail Posting (10/20)

The Purchaser is responsible for posting and maintaining caution signs on Blomgren Marsh Road prior to beginning operations during the snowmobile season (approximately December 1 to March 31). The trail must be posted at appropriate distances from the Sale Area to warn of logging activity and truck traffic. Signs must be removed when harvest operations are suspended or completed. The Purchaser will provide these signs.

6.2.3 - Recreational Trail Posting (10/20)

The Purchaser is responsible for posting and maintaining caution signs on the ORV trail prior to beginning operations. The trail must be posted at appropriate distances from the Sale Area to warn of logging activity and truck traffic at both ends of the trail. Signs must be removed when harvest operations are suspended or completed. The Purchaser will provide these signs.

7 - Other Conditions

7.5 - Loss

7.5.1 - Deteriorating Timber (7/09)

The Sale Area has received damage from Emerald Ash Borer. The Purchaser should harvest the wood as soon as possible. The Department of Natural Resources is held free of responsibility of any further damage or deterioration due to delay in harvesting.



TIMBER SALE MAP

This information provided by authority of Part 525, 1994 PA 451, as amended.

Sale Number

12-011-25

Date

09/10/2025

Forest Management Unit

County

Mapped By: R Goupell

Scale

Page

Of

Crystal Falls Mgt Unit

Dickinson

Cruised By: R Goupell

1:20,000

1

1

Township
40N

Range
28W /

Section(s) and

Subdivision(s) Sec. 1 S1/2SW; Sec. 12 N1/2NW,SENE; Sec. 5 SWSW; Sec. 6 SE; Sec. 7 NW,NE,N1/2SE;

Cover Type

A = Aspen	J = Jack Pine	O = Oak	U = Upland Brush
B = Paper Birch	K = Rock	P = Lowland Poplar	UM = Upland Mix Forest
C = Cedar	L = Lowland Brush	Q = Mixed Swamp Conifer	V = Bog or Marsh
D = Treed Bog	LM = Lowland Mix Forest	R = Red Pine	W = White Pine
E = Swamp Hardwoods	M = Maple, Beech, Birch	S = Black Spruce	X = Non Stocked
F = Spruce/Fir	MC = Mixed Conifer	T = Tamarack	Y = Sand
G = Grass	MD = Mixed Deciduous	Z = Water	
H = Hemlock	N = Marsh		

Density

0 = Non Stocked	5 = Pole Timber Medium
1 = Seedling Sapling Poor	6 = Pole Timber Well
2 = Seedling Sapling Medium	7 = Saw Timber Poor
3 = Seedling Sapling Well	8 = Saw Timber Medium
4 = Pole Timber Poor	9 = Saw Timber Well

Payment Unit Number	Acres	Payment Unit Number	Acres
1	27	6	30.8
2	38	7	15
3	41.8	8	7
4	28.7	9	9.8
5	23.5		

Twin Morels

221.6 Acres

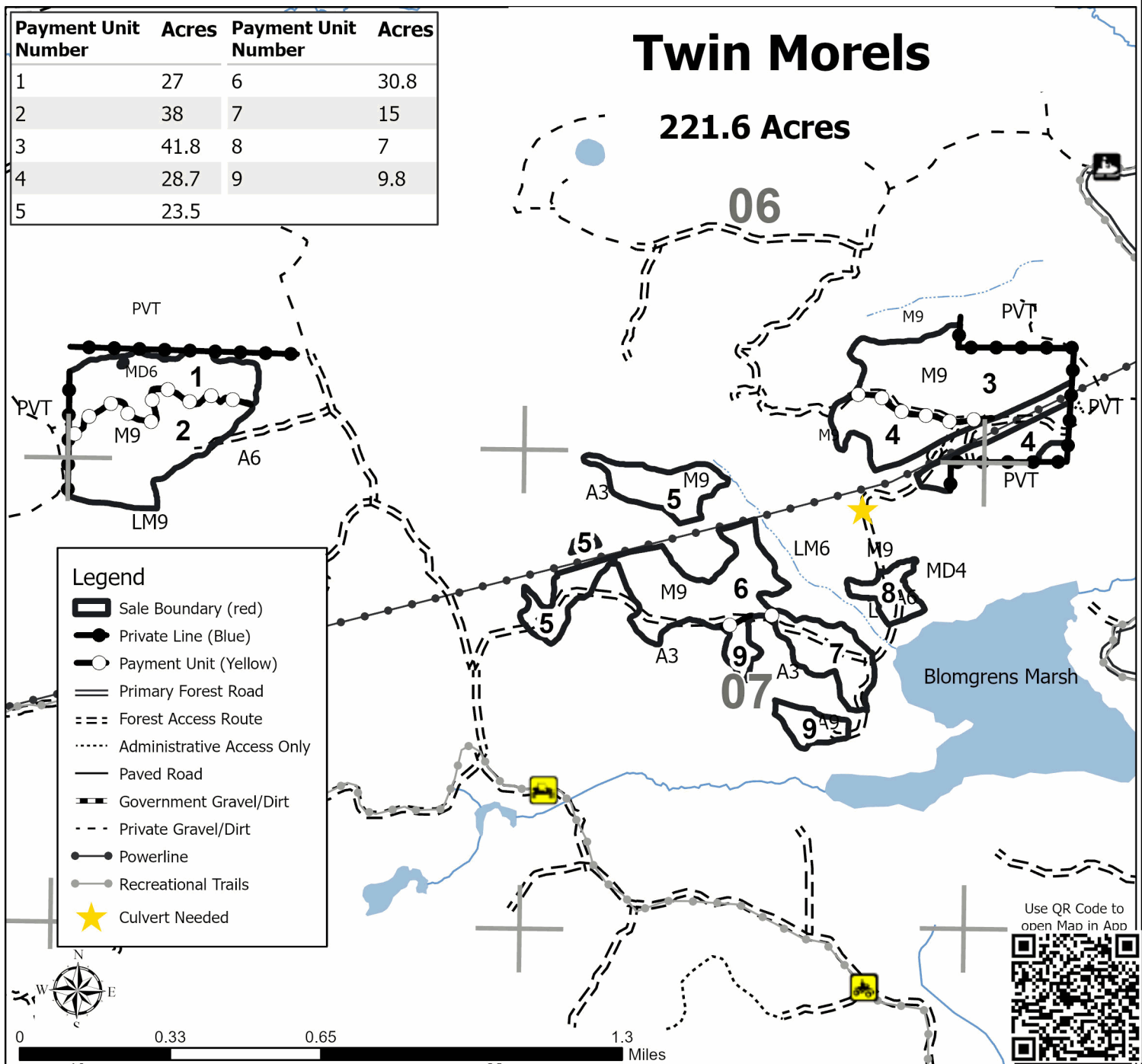



TIMBER SALE MAP

This information provided by authority of Part 525, 1994 PA 451, as amended.

Sale Number

12-011-25

Date

09/18/2025

Forest Management Unit

County

Mapped By: R Goupell

Scale

Page

Of

Crystal Falls Mgt Unit

Dickinson

Cruised By: R Goupell

1:10,000

1

1

Township
40N

Range
28W /

Section(s) and
Subdivision(s) Sec. 1 S1/2SW; Sec. 12 N1/2NW,SENE; Sec. 5 SWSW; Sec. 6 SE; Sec. 7 NW,NE,N1/2SE;

Cover Type

A = Aspen	J = Jack Pine	O = Oak	U = Upland Brush
B = Paper Birch	K = Rock	P = Lowland Poplar	UM = Upland Mix Forest
C = Cedar	L = Lowland Brush	Q = Mixed Swamp Conifer	V = Bog or Marsh
D = Treed Bog	LM = Lowland Mix Forest	R = Red Pine	W = White Pine
E = Swamp Hardwoods	M = Maple, Beech, Birch	S = Black Spruce	X = Non Stocked
F = Spruce/Fir	MC = Mixed Conifer	T = Tamarack	Y = Sand
G = Grass	MD = Mixed Deciduous		Z = Water
H = Hemlock	N = Marsh		

Density

0 = Non Stocked	5 = Pole Timber Medium
1 = Seedling Sapling Poor	6 = Pole Timber Well
2 = Seedling Sapling Medium	7 = Saw Timber Poor
3 = Seedling Sapling Well	8 = Saw Timber Medium
4 = Pole Timber Poor	9 = Saw Timber Well

**Twin Morels
Road Work**

0 0.15 0.3

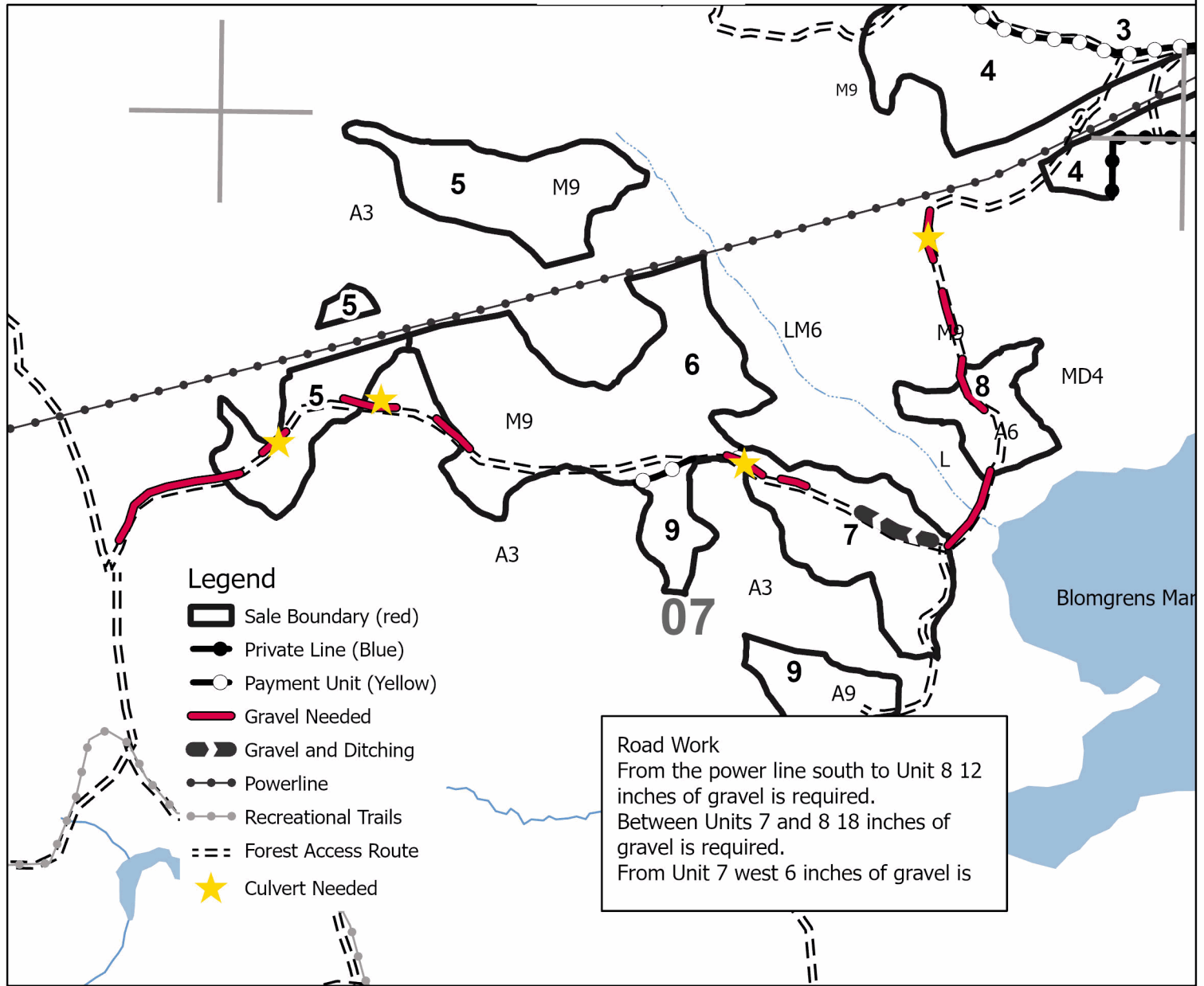

TIMBER SALE INFORMATION

Red Eye Hazel (12-012-25)

T41N, R29W, SEC. 16; T41N, R29W, SEC. 22; T41N, R29W, SEC. 23; T41N, R29W, SEC. 24.
Dickinson County (Advertised Price \$60,320.40)

SALE NOTE: A recreation site such as a trail, pathway, or campground is within the sale area or the vicinity. Certain restrictions/specifications may be applicable including time restrictions.

A timber sale contract for this lump sum, sealed bid timber sale will be awarded to the responsible bidder offering the highest sealed bid price. All units of volume listed below were estimated using the Inventory Manager computer program and the new Michigan taper model. Bids must be at or above the following advertised price for each product and species:

<u>PRODUCTS & SPECIES</u>	<u>ESTIMATED UNITS*</u>	<u>ADVERTISED PRICE</u>
Pulpwood		
Balsam Fir	21 Cords	\$ 5.40 / Cord
Black Spruce	40 Cords	\$ 10.50 / Cord
Mixed Aspen	887 Cords	\$ 17.90 / Cord
Mixed Hardwood	48 Cords	\$ 12.35 / Cord
Red Pine	583 Cords	\$ 74.30 / Cord

* The total volume is statistically estimated within plus (+) or minus (-) 22.86 percent. There are an estimated 1,577 cords on this timber sale, plus or minus 361 cords at the 95% confidence level. The estimated units are final and not subject to adjustment. Prospective bidders are urged to examine this timber and to make their own estimates of quantity and quality.

BOND AND PAYMENT SCHEDULE:

1. A bond in the amount of \$3,016.00 to insure faithful performance of the conditions of the contract will be deposited by the successful bidder within 21 days of the sale award.
 2. Cutting in any sale or unit without the required advance payment would be considered a trespass.
 3. Total payment must be paid in advance or according to the following schedule :
 - (a) Ten percent (10%) of the sale value must be paid within 21 days of the sale award.
 - (b) The 10% down payment will be credited towards the first unit cut.
 - (c) Payment for each of the following units must be made before cutting begins in that unit:
- | PAYMENT UNIT NUMBER | PERCENT OF TOTAL SALE VALUE |
|---------------------|-----------------------------|
| 01 | 16.2% |
| 02 | 12.0% |
| 03 | 71.8% |
4. If no cutting takes place, the 10% down payment will not be refunded.
 5. Operations on the contract issued will terminate on 06/30/2030.

SALE STATISTICS

Volumes were calculated in cubic feet using the Michigan taper model. Cubic foot volume includes all wood inside bark for the product indicated. For display purposes, cubic feet were converted to cords and MBF using a simple conversion factor, e.g. 79 cubic feet per cord and 185 cubic feet per MBF. The cubic foot volumes are precise; the cords and MBF volumes are not. Cubic foot volume cannot be directly converted to cords or boards with precision.

SALE VOLUMES

The total estimated sale volume may not equal the sum of the species/products due to the nature of statistical calculations associated with double sampling methodology.

<u>VOLUME</u>		<u>STATISTICAL RANGE IN CORDS</u>		
<u>TOTAL CUBIC FEET</u>	<u>TOTAL CORDS</u>	<u>PERCENT ERROR</u>	<u>MINIMUM</u>	<u>MAXIMUM</u>
124,603	1,577	22.86%	1,217	1,938

VDU VOLUMES

A VDU is a Volume Determination Unit. Volumes and their associated statistics are calculated at the VDU level and summarized to the sale level. There is often a one to one relationship between a VDU and a Payment Unit, but not always, depending on the cruise design. Refer to the VDU TO PAYMENT UNIT table.

VDU	VOLUME		PERCENT ERROR	RANGE IN CORDS	
	TOTAL CUBIC FEET	TOTAL CORDS		MINIMUM	MAXIMUM
1	46,060	583	25.75%	433	733
24	32,861	416	61.26%	161	671
31	45,683	578	38.95%	353	803
TOTAL:	124,603	1,577		947	2,207

VDU TO PAYMENT UNIT

When a VDU is associated with more than one Payment Unit (PU), the VDU volumes are assigned to the PU based on acres of the VDU within the PU.

VDU	VDU ACRES	PU	PU ACRES
TOTAL:			

DESCRIPTION OF TIMBER BY PAYMENT UNIT (PU)

PU	MARKET GROUP	PRODUCT	QUANTITY	UNIT	ACRES	ADVERTISE PRICE
1	Balsam Fir	Pulpwood	11	Cords	24.7	\$9,782.00
	Black Spruce		40	Cords		
	Mixed Aspen		499	Cords		
	Quaking Aspen		499	Cords		
	Mixed Hardwood		30	Cords		
	Balsam Poplar		24	Cords		
	Paper Birch		4	Cords		
	Red Maple		2	Cords		
2	Balsam Fir	Pulpwood	10	Cords	16.7	\$7,221.50
	Mixed Aspen		388	Cords		
	B. T. Aspen		169	Cords		
	Quaking Aspen		219	Cords		
	Mixed Hardwood		18	Cords		
	Paper Birch		3	Cords		
	Red Maple		15	Cords		
3	Red Pine	Pulpwood	583	Cords	64.3	\$43,316.90
TOTAL:			1,579	Cords		

Sale Specific Conditions & Requirements

Sale Name: Red Eye Hazel

Sale Number: 12-012-25 Seq#: 1

1 - Sale Area

1.2 - Boundaries

1.2.1 - Painted Boundaries (9/19)

The sale boundary and Payment Unit boundaries are marked and identified by blue and red paint. Exterior sale boundary lines against private property are marked with blue paint. Exterior sale boundary lines against state are marked with red paint. The painted boundary line trees are not Included Timber and are to be protected unless marked with orange paint.

2 - Timber Specifications

2.1 - Included Timber

2.1.1 - Clearcut Unit(s) with Unmerchantable Trees (6/14)

Within Payment Unit(s) 1 and 2, cut all species trees that are two (2) inches or more at DBH, except Pine, Oak, Hemlock and Cedar.

2.1.3 - Cut Tree Marked Unit(s) (12/08)

Within Payment Unit(s) 3, all trees are designated for cutting when marked with orange paint above and below stump height, regardless of merchantability.

3 - Payments

3.3 - Pre-measured Sales

3.3.4 - Dividing Payment Units (7/14)

Payment Unit(s) 3 may be divided at the request of the Purchaser and upon approval of the Unit Manager. Dividing Payment Units is a contract modification which requires a Timber Sale Contract Amendment. There will be only one division per Payment Unit.

3.4 - Damaged Timber

3.4.1 - Damaged Timber (12/24)

General Condition and Requirement 3.4 Damaged Timber, defines liquidated damages for undesignated live merchantable trees which are cut or injured. In addition, extreme care should be taken to avoid damage to tree seedlings and saplings.

Within the Sale Area, if more than 10% of the tree seedlings or saplings (1/4" to 4.5" DBH) within a specified portion of the Sale Area are damaged, liquidated damages will be assessed at \$100 per acre for all acreage within that specified portion of the Sale Area that was damaged.

No damage is acceptable to undesignated live merchantable trees. Within the Sale Area, if more than 10 % of trees (> 4.5" DBH) within a specified area of the sale are damaged, liquidated damages will be assessed for all trees damaged. Rates will be in accordance with General Condition and Requirement 3.4 Damaged Timber.

4 - Transportation

4.1 - Construction

4.1.12 - No New Roads (1/12)

No new roads will be permitted in any Payment Unit. All operations are limited to existing roads. Only Skid trails will be allowed.

4.2 - Maintenance

4.2.4 - Grading (10/16)

For completion of the sale, state forest roads must be graded. In general, this will require a road grader or bulldozer to shape up the roads after forest products have been hauled off site. This includes cleaning of drainage areas, grading, crowning and

filling with gravel, if necessary. The grading equipment to be used must be approved by the Unit Manager or his/her representative.

4.3 - Public Right-of-Way

4.3.2 - County R-O-W (12/06)

The County must be contacted prior to crossing or harvesting in the County Road R-O-W. This applies to Payment Units 2 and 3 on Lyons Lake Road.

5 - Operations

5.2 - Conduct of Operations

5.2.1 - Slash

5.2.1.13 - Dispose of Slash as Directed (12/05)

Slash is to be disposed of as directed by the Sale Administrator.

5.2.3 - Operating Restrictions

5.2.3.3 - Bark Slippage Restriction (3/09)

Within Payment Unit(s) 3, unless changed by written agreement, cutting and skidding are not permitted during the period of April 15 to July 15. This restriction is because of bark slippage.

5.2.32 - Decking/Landing Restoration (9/13)

All decking and landing areas must have the surface area restored to a condition equal to or better than before. This is to ensure the proper regeneration of the stand. Wood debris, chips and "cookies" from trimmings must be removed or scattered away from landing and loading areas and may not be windrowed on the edge.

5.2.38 - No Decking Against Live Trees (2/04)

Cut products may not be decked against unmarked or designated leave trees.

5.4 - Soil Protection

5.4.1 - Rutting Restriction, General (7/16)

Operations are to cease immediately if equipment and weather conditions result in rutting of roads and/or skid trails which are 12 inches or greater in depth and 50 feet in length. The Unit Manager or his/her representative may restrict hauling and/or skidding if ruts exceed the specified depth. With the Unit Manager or his/her representative's approval, the Purchaser may return to the area when the risk of rutting has decreased.

6 - Safety and Fire Prevention

6.2 - Signing

6.2.1 - Road Posting (10/20)

The Purchaser is responsible for posting and maintaining caution signs on Lyons Lake Road prior to beginning operations. The road must be posted at appropriate distances from the Sale Area to warn of logging activity and truck traffic. Signs must be removed when harvest operations are suspended or completed. The Purchaser will provide these signs.



TIMBER SALE MAP

This information provided by authority of Part 525, 1994 PA 451, as amended.

Sale Number

12-012-25

Date

09/11/2025

Forest Management Unit

Crystal Falls Mgt Unit

County

Dickinson

Mapped By: R Goupell

Cruised By: R Goupell

Scale

1:23,000

Page

1

Of

1

Township
41N

Range
29W

Section(s) and

Subdivision(s) Sec. 16 SESE; Sec. 22 NENW,N1/2NE; Sec. 23 S1/2NE,NESE; Sec. 24 SWNW,N1/2SW,SWSW;

Cover Type

A = Aspen	J = Jack Pine	O = Oak	U = Upland Brush
B = Paper Birch	K = Rock	P = Lowland Poplar	UM = Upland Mix Forest
C = Cedar	L = Lowland Brush	Q = Mixed Swamp Conifer	V = Bog or Marsh
D = Treed Bog	LM = Lowland Mix Forest	R = Red Pine	W = White Pine
E = Swamp Hardwoods	M = Maple, Beech, Birch	S = Black Spruce	X = Non Stocked
F = Spruce/Fir	MC = Mixed Conifer	T = Tamarack	Y = Sand
G = Grass	MD = Mixed Deciduous	Z = Water	
H = Hemlock	N = Marsh		

Density

0 = Non Stocked	5 = Pole Timber Medium
1 = Seedling Sapling Poor	6 = Pole Timber Well
2 = Seedling Sapling Medium	7 = Saw Timber Poor
3 = Seedling Sapling Well	8 = Saw Timber Medium
4 = Pole Timber Poor	9 = Saw Timber Well

Payment Unit Acres

1	24.7
2	16.7
3	64.3

Red Eye Hazel

105.7 Acres

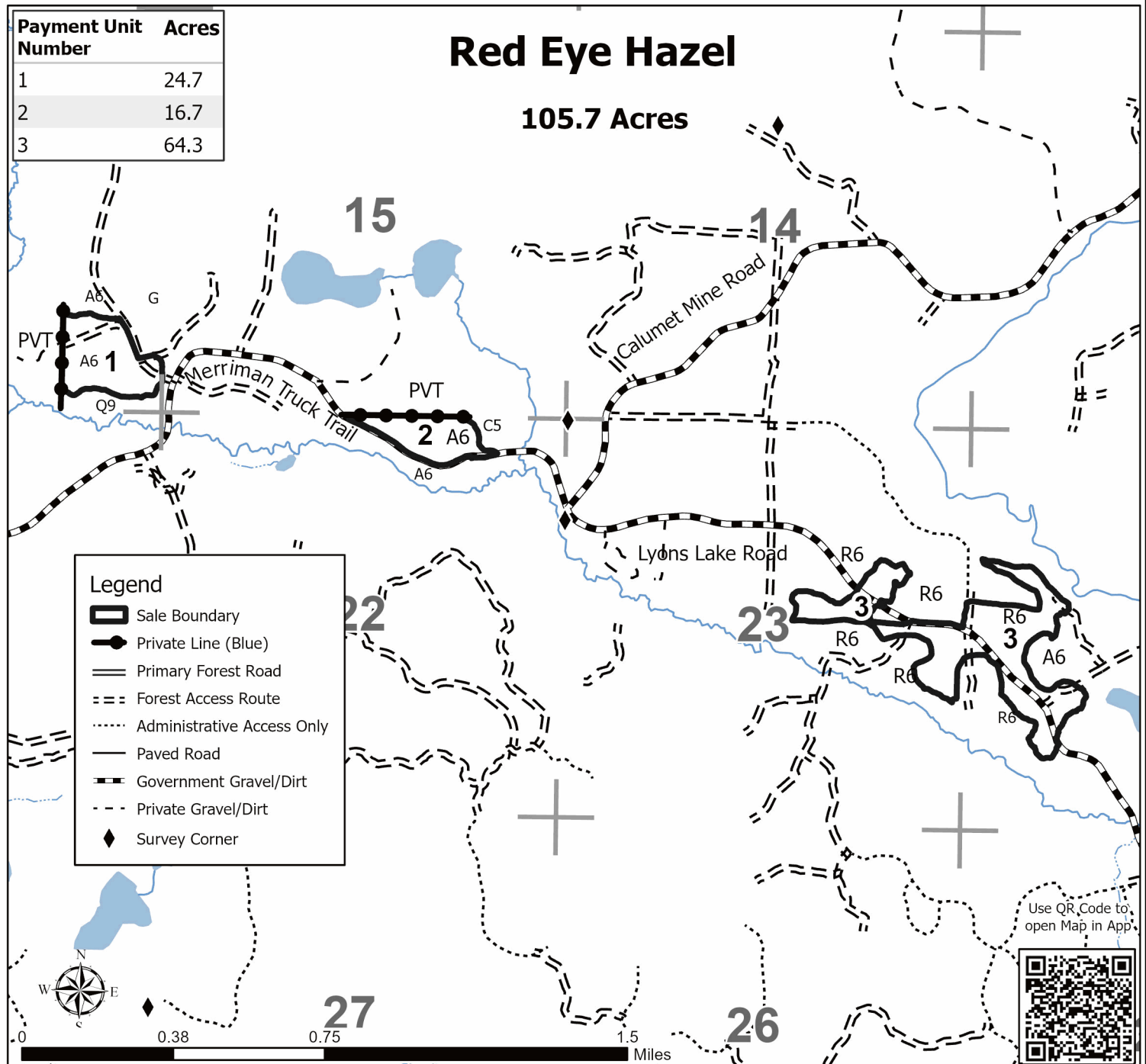

BID INSTRUCTIONS (VER. 10/10/2022):

1. Scheduled Bid Location, Date, and Time (2/11)

Bids must be received by the Unit Manager, ESCANABA OFFICE, 6833 US-2, 41 & M-35, Gladstone, MI 49837, no later than 3:00 p.m. (local time) on March 11, 2026. For further information concerning this sale, contact Dan Racine at 906-789-8231.

2. Bidder's Qualifications (10/22)

If all or part of a timber sale was prepared by a private contractor, the contractor and that contractor's company are not permitted to bid on the timber sale. A person must be 18 years of age or older to purchase timber. Permanent employees of the Department of Natural Resources or members of their immediate household may not bid. Former employees, in the permanent or seasonal class, may not bid until 3 months after the last day of active duty. Bids will not be accepted from individuals or companies appearing on the DNR/FRD No-Bid List. This list contains the names of purchasers who previously failed to execute a contract within 21-days or who have a history of poor performance.

3. Preparation of Sealed Bids (5/16)

Bid Forms may be completed online thru Michigan DNR Timber Sale Online Bidding (OLB) at www.michigan.gov/timberbidding or by completing the hardcopy Bid Form found in the Timber Sale Prospectus. Hardcopy Bid Forms shall be manually signed in ink. Registration in OLB is considered your 'signature' for all bids submitted thru that system. Bid prices must be entered for each species and product in the Bid Price column for all material subject to bidding and all fill-in blanks must be completed. If erasures or other changes appear on the hardcopy Bid Form, each erasure or change must be initialed by the person signing the bid.

4. Submission of Sealed Bids (5/16)

Bid forms may be obtained from the Unit Manager or thru OLB. Bids may be submitted hardcopy or thru OLB. All hardcopy bids must be submitted on the bid form and in an envelope clearly identified as described in this section. NOTE: Only one bid form per bid envelope. Sealed bids must be submitted to the Unit office designated in the prospectus and must be submitted at or prior to the time established in the prospectus. The envelope should show on the outside (a) the sale name or number and (b) the date and time of bid opening, as shown in the prospectus. Bids received after the time specified in the sale prospectus are late bids and will be rejected.

It is possible for a bidder to submit multiple bids on a single sale. For example, a bid may be submitted hardcopy and a bid may be submitted thru OLB. Or, two bidders from the same company could both submit bids on the same sale. If this were to happen, the State would accept all bids received and award the contract accordingly. All bidding and contractual requirements would apply to all bids received.

5. Public Opening of Sealed Bids (7/16)

If conditions permit, the sealed bids will be publicly opened and posted at the time and place set in the prospectus.

If a bidder, present at a bid opening, has submitted bids on more than one sale, that bidder may withdraw their unopened bid envelopes or announce the withdrawal of their online bid after being declared the successful bidder on one sale.

6. Award of Contract (1/11)

Award of the contract will be made to the Bidder whose bid, conforming to the prospectus, is most advantageous to the State of Michigan on the basis of total value at rates bid for the estimated quantities. The State reserves the right to reject any bid or waive any minor irregularity in bids received. A written award mailed (or otherwise furnished) to the successful Bidder shall be deemed to result in a binding contract without further action by either party.

7. Down Payment (1/11)

The Bidder to whom award is made must make a down payment within 21 days of the sale award. The amount of the down payment will be calculated as shown in the Bond and Payment Schedule of this prospectus. Only cash may be used to meet this requirement.

8. Performance Security (1/11)

As guarantee of faithful performance, a cash bond, certificate of deposit, surety bond or irrevocable letter of credit (LOC) is required within 21 days of the sale award. The amount of the performance security is shown in the Bond and

Payment Schedule of this prospectus. If an LOC or surety is used, the coverage must extend for at least 6 months beyond the contract expiration.

9. Worker's Compensation (10/22)

Purchaser shall obtain worker's compensation insurance to cover claims under Michigan's Worker's Disability Compensation Act of 1969 or similar employee benefit act of any other state applicable to an employee. Verification of Worker's Disability Compensation Act Compliance must be completed and submitted within 21 days of contract award and prior to the issuance of the timber sale contract. In addition, if applicable, Notice of Exclusion or Certificate of Insurance must also be submitted.

10. Timber Sale Contract (10/22)

Additional conditions and requirements common to all timber sales are listed on the timber sale contract (R4031) and are available on line at www.michigan.gov/timber. Contact the Unit Manager for additional information or a sample contract. Within 21 days of the date of the award letter, the bidder must sign the contract and provide the required down payment, performance security, and verification of worker's disability compensation. The down payment and performance security shall be in accordance with the provisions of the timber sale contract, in the sums stated in this prospectus. If these actions are not taken, then the Bidder, the Bidder's corporation, and the corporation's principals may not be permitted to bid on State timber sales for a period of 3 months after the first offense, 6 months after the second offense, and 1 year after the third offense. An offense will only be counted against the Bidder for 5 years. In addition, the Bidder certifies that if awarded this contract, the Bidder will complete the timber sale contract in accordance with its terms and any modifications thereof including requirements to purchase, cut, and remove the included timber by the expiration date.

Payment Unit values in the State Forest Timber Sale Contract are calculated based on the advertised value of the Payment Unit as a percentage of the total advertised value of the contract. The advertised value of each Payment Unit is given in the Description of Timber by Payment Unit table on the Timber Sale Information page. For example, if the value of Payment Unit 1 is advertised as \$1,500 and the total Timber Sale value is advertised as \$10,000, the contract price for Payment Unit 1 will be 15% of the total bid price ($\$1,500/\$10,000 * 100$).

11. Disclaimer of Estimates and Bidder's Warranty of Inspection (10/22)

Before submitting this bid, the Bidder is advised and cautioned to inspect the sale area, review the requirements of the sale contract, and take other steps as may be reasonably necessary to ascertain the location, estimated volumes, construction estimates, and operating costs of the proposed sale. Failure to do so will not relieve the Bidder from responsibility for completing the contract.

The Bidder warrants that this bid is submitted solely on the basis of the Bidder's examination and inspection of the quality and quantity of the timber offered for sale and the Bidder's opinion of the value thereof and the costs of recovery. No reliance should be placed on the State of Michigan's estimates of timber quality, quantity or costs of recovery. Bidder further acknowledges that the State of Michigan: (i) expressly disclaims any warranty of fitness of timber for any purpose; (ii) offers this timber as is without any warranty of quality (merchantability) or quantity and (iii) expressly disclaims any warranty as to the quantity or quality of timber sold.

12. Certification and Chain-of-Custody (10/22)

Unless otherwise indicated in the contract under section 7 – Other Conditions of the Sale Specific Conditions & Requirements, the area encompassed by this timber sale is certified to the standards of the Forest Stewardship Council (FSC) - Certificate #SCS-FM/COC-00090N and the Sustainable Forestry Initiative (SFI) - Certificate #NSF-SFIS-5Y031-SF5. Forest products from this sale may be delivered to the mill as "FSC 100% and / or SFI certified" as long as the contractor hauling the forest products is chain-of-custody (COC) certified or covered under a COC certificate from the destination mill. The purchaser is responsible for maintaining COC after leaving the sale area.

13. Good Neighbor Authority (GNA) Requirements (10/22)

If the name of this timber sales contains the acronym GNA, it is authorized by the Good Neighbor Authority (GNA) and covered by various agreements between the U.S. Forest Service and the State. The timber sale occurs on federal land and the following conditions apply:

GNA contracts on US Forest Service land will not be awarded to purchasers on the Federal list of excluded parties. The System for Award Management (SAM) will be checked for active excluded parties prior to award of contract. In

addition, the Bidder to whom award is made must complete an Assurance Regarding Felony Conviction or Tax Delinquent Status for Corporate Applicants (AD-3031).

14. Good Neighbor Authority (GNA) Requirements, con't (10/22)

Bidder certifies, by signing this bid form, that to the best of Bidder's knowledge that the following representations are accurate and complete.

- a. That the Bidder and its principals are not presently debarred, suspended, proposed for debarment, declared ineligible, or voluntary excluded from timber sales (covered transactions) by any Federal department or agency.
- b. That the Bidder and its principals have not within a 3-year period preceding this bid been convicted of or had a civil judgment rendered against them for commission of fraud or a criminal offense in connection with obtaining , attempting to obtain, or performing a public (Federal, State, or local) transaction or contract under a public transaction; violation of Federal or State antitrust statutes or commission of embezzlement, theft, forgery, bribery, falsification or destruction of records, making false statements, or receiving stolen property.
- c. That the Bidder and its principals are not presently indicted for or otherwise criminally or civilly charged by a governmental entity (Federal, State, or local) with commission of any of the offenses enumerated in paragraph b of this certification.
- d. That the Bidder and its principals have not within a 3-year period preceding this bid had one or more public transactions (Federal, State, or local) terminated for breach or default of a timber or forest product contract.

Bidders that cannot certify this requirement, in whole or in part, shall submit an explanation with their bid.

Scott Bowen
Director

TIMBER SALE INFORMATION

MM Line Hardwoods (33-007-25)

T41N, R25W, SEC. 6; T41N, R25W, SEC. 8; T41N, R26W, SEC. 2; T42N, R26W, SEC. 36.

Menominee County (Advertised Price \$69,165.95)

SALE NOTE: Miscellaneous species 2 is dead/dying ash.

Alternative access through private property is the responsibility of the purchaser for Payment unit(s) 1,2,3, and 4.

Payment Unit(s) 2,5,6,7, and 8 cutting and skidding is not permitted during April 15th to July 15th. Payment Unit(s) 1,2,3, and 4 are limited to 12/1 to 3/31 or frozen ground conditions due to access road through Lyme land.

Contact: George Wilson (906)-203-8079

Access may be through private or other public land.

A timber sale contract for this lump sum, sealed bid timber sale will be awarded to the responsible bidder offering the highest sealed bid price. All units of volume listed below were estimated using the Inventory Manager computer program and the new Michigan taper model. Bids must be at or above the following advertised price for each product and species:

<u>PRODUCTS & SPECIES</u>	<u>ESTIMATED UNITS*</u>	<u>ADVERTISED PRICE</u>
Sawtimber		
Paper Birch	5.6 MBF	\$ 78.00 / MBF
Red Maple	24.4 MBF	\$ 100.00 / MBF
Sugar Maple	86.2 MBF	\$ 229.00 / MBF
Yellow Birch	1.5 MBF	\$ 40.00 / MBF
Pulpwood		
Balsam Fir	22 Cords	\$ 8.75 / Cord
Black Spruce	218 Cords	\$ 11.25 / Cord
Misc. Species 2	8 Cords	\$ 3.75 / Cord
Mixed Aspen	54 Cords	\$ 23.55 / Cord
Mixed Hardwood	1,041 Cords	\$ 16.95 / Cord
Red Pine	365 Cords	\$ 51.35 / Cord
Tamarack	32 Cords	\$ 9.85 / Cord
White Pine	329 Cords	\$ 17.75 / Cord

* The total volume is statistically estimated within plus (+) or minus (-) 16.02 percent. There are an estimated 2,348 cords on this timber sale, plus or minus 376 cords at the 95% confidence level. The estimated units are final and not subject to adjustment. Prospective bidders are urged to examine this timber and to make their own estimates of quantity and quality.

BOND AND PAYMENT SCHEDULE:

1. A bond in the amount of \$6,917.00 to insure faithful performance of the conditions of the contract will be deposited by the successful bidder within 21 days of the sale award.
2. Cutting in any sale or unit without the required advance payment would be considered a trespass.
3. Total payment must be paid in advance or according to the following schedule:
 - (a) Ten percent (10%) of the sale value must be paid within 21 days of the sale award.
 - (b) The 10% down payment will be credited towards the first unit cut.
 - (c) Payment for each of the following units must be made before cutting begins in that unit:

<u>PAYMENT UNIT NUMBER</u>	<u>PERCENT OF TOTAL SALE VALUE</u>
01	38.8%
02	21.1%
03	2.5%
04	4.9%
05	10.6%
06	2.1%
07	2.3%
08	17.7%

4. If no cutting takes place, the 10% down payment will not be refunded.
5. Operations on the contract issued will terminate on 06/30/2030.

SALE STATISTICS

Volumes were calculated in cubic feet using the Michigan taper model. Cubic foot volume includes all wood inside bark for the product indicated. For display purposes, cubic feet were converted to cords and MBF using a simple conversion factor, e.g. 79 cubic feet per cord and 185 cubic feet per MBF. The cubic foot volumes are precise; the cords and MBF volumes are not. Cubic foot volume cannot be directly converted to cords or boards with precision.

SALE VOLUMES

The total estimated sale volume may not equal the sum of the species/products due to the nature of statistical calculations associated with double sampling methodology.

VOLUME			STATISTICAL RANGE IN CORDS	
TOTAL CUBIC FEET	TOTAL CORDS	PERCENT ERROR	MINIMUM	MAXIMUM
185,455	2,348	16.02%	1,971	2,724

VDU VOLUMES

A VDU is a Volume Determination Unit. Volumes and their associated statistics are calculated at the VDU level and summarized to the sale level. There is often a one to one relationship between a VDU and a Payment Unit, but not always, depending on the cruise design. Refer to the VDU TO PAYMENT UNIT table.

	VOLUME			RANGE IN CORDS	
VDU	TOTAL CUBIC FEET	TOTAL CORDS	PERCENT ERROR	MINIMUM	MAXIMUM
21	33,245	421	27.96%	303	538
25	3,677	47	51.89%	22	71
79	14,566	184	38.42%	114	255
111	3,803	48	49.09%	25	72
125	71,530	905	34.85%	590	1,221
127	34,557	437	24.83%	329	546
130	15,149	192	63.40%	70	313
132	8,929	113	72.51%	31	195
TOTAL:	185,455	2,348		1,484	3,212

VDU TO PAYMENT UNIT

When a VDU is associated with more than one Payment Unit (PU), the VDU volumes are assigned to the PU based on acres of the VDU within the PU.

VDU	VDU ACRES	PU	PU ACRES
TOTAL:			

DESCRIPTION OF TIMBER BY PAYMENT UNIT (PU)

PU	MARKET GROUP	PRODUCT	QUANTITY	UNIT	ACRES	ADVERTISE PRICE
1	Paper Birch	Sawtimber	1.0	MBF	27.7	\$26,817.40
	Black Spruce	Pulpwood	191	Cords		
	Mixed Hardwood		51	Cords		
	<i>Balsam Poplar</i>		12	<i>Cords</i>		
	<i>Paper Birch</i>		7	<i>Cords</i>		
	<i>Red Maple</i>		32	<i>Cords</i>		
	Red Pine		365	Cords		
	Tamarack		32	Cords		
	White Pine		263	Cords		
2	Red Maple	Sawtimber	6.4	MBF	38.0	\$14,615.20
	Sugar Maple		34.2	MBF		
	Yellow Birch		0.6	MBF		
	Mixed Aspen	Pulpwood	54	Cords		
	<i>B. T. Aspen</i>		5	<i>Cords</i>		
	<i>Quaking Aspen</i>		49	<i>Cords</i>		
	Mixed Hardwood		286	Cords		
	<i>Ironwood</i>		16	<i>Cords</i>		
	<i>Red Maple</i>		38	<i>Cords</i>		
	<i>Sugar Maple</i>		230	<i>Cords</i>		
	<i>Yellow Birch</i>		2	<i>Cords</i>		
3	Black Spruce	Pulpwood	27	Cords	8.0	\$1,761.45
	Mixed Hardwood		86	Cords		
	<i>Paper Birch</i>		31	<i>Cords</i>		
	<i>Red Maple</i>		55	<i>Cords</i>		
4	Paper Birch	Sawtimber	2.3	MBF	7.7	\$3,372.90
	Red Maple		1.1	MBF		
	Yellow Birch		0.9	MBF		
	Balsam Fir	Pulpwood	11	Cords		
	Mixed Hardwood		105	Cords		
	<i>Paper Birch</i>		19	<i>Cords</i>		
	<i>Red Maple</i>		82	<i>Cords</i>		
	<i>Yellow Birch</i>		4	<i>Cords</i>		
	White Pine		66	Cords		
5	Red Maple	Sawtimber	1.1	MBF	12.4	\$7,313.20
	Sugar Maple		22.8	MBF		
	Balsam Fir	Pulpwood	10	Cords		
	Misc. Species 2		8	Cords		
	Mixed Hardwood		110	Cords		
	<i>Paper Birch</i>		3	<i>Cords</i>		
	<i>Red Maple</i>		11	<i>Cords</i>		
	<i>Sugar Maple</i>		96	<i>Cords</i>		
6	Paper Birch	Sawtimber	1.2	MBF	5.6	\$1,418.90
	Red Maple		0.4	MBF		
	Sugar Maple		2.8	MBF		
	Mixed Hardwood	Pulpwood	38	Cords		
	<i>Paper Birch</i>		1	<i>Cords</i>		
	<i>Red Maple</i>		2	<i>Cords</i>		
	<i>Sugar Maple</i>		35	<i>Cords</i>		
7	Red Maple	Sawtimber	1.3	MBF	2.7	\$1,622.30
	Sugar Maple		4.0	MBF		
	Mixed Hardwood	Pulpwood	34	Cords		
	<i>Red Maple</i>		5	<i>Cords</i>		
	<i>Sugar Maple</i>		29	<i>Cords</i>		
8	Paper Birch	Sawtimber	1.1	MBF	23.4	\$12,244.60
	Red Maple		14.1	MBF		

DESCRIPTION OF TIMBER BY PAYMENT UNIT (PU), CON'T

PU	MARKET GROUP	PRODUCT	QUANTITY	UNIT	ACRES	ADVERTISE PRICE
8 con't	Sugar Maple	Sawtimber	22.4	MBF		
	Balsam Fir	Pulpwood	1	Cords		
	Mixed Hardwood		331	Cords		
	<i>Basswood</i>		4	<i>Cords</i>		
	<i>Paper Birch</i>		4	<i>Cords</i>		
	<i>Red Maple</i>		134	<i>Cords</i>		
	<i>Sugar Maple</i>		189	<i>Cords</i>		
TOTAL:			117.7	MBF		
TOTAL:			2,069	Cords		

Sale Specific Conditions & Requirements

Sale Name: MM Line Hardwoods

Sale Number: 33-007-25 Seq#: 1

1 - Sale Area

1.2 - Boundaries

1.2.1 - Painted Boundaries (9/19)

The sale boundary and Payment Unit boundaries are marked and identified by blue, red and yellow paint. Exterior sale boundary lines against private property are marked with blue paint. Exterior sale boundary lines against state are marked with red paint. Interior Payment Unit boundaries are marked with yellow paint. Retention patches are marked with red paint; no harvesting activities may occur within these areas. The painted boundary line trees are not Included Timber and are to be protected unless marked with orange paint.

2 - Timber Specifications

2.1 - Included Timber

2.1.1 - Clearcut Unit(s) with Unmerchantable Trees (6/14)

Within Payment Unit(s) 3 and 4, cut all trees that are three (3) inches or more at DBH, except:

- Within Payment Unit 3, do not cut cedar, hemlock or pine.

- Within Payment Unit 4, do not cut cedar, hemlock, trees marked with green paint, or trees marked with red paint labeled "X".

2.1.3 - Cut Tree Marked Unit(s) (12/08)

Within Payment Unit(s) 2, 5, 6, 7 and 8, all trees are designated for cutting when marked with orange paint above and below stump height, regardless of merchantability. In addition, the following specifications apply:

- Within Payment Unit 5, cut all trees marked with orange paint above and below stump height. Additionally, cut all aspen, balm, balsam, ironwood, and spruce greater than three (3) inches DBH.

- Within Payment Unit 7, cut all trees marked with orange paint above and below stump height. Additionally, cut all balsam, spruce, and ironwood which meet minimum piece specifications in 2.2 Utilization.

2.1.7 - Leave Tree Marked Unit(s) (6/14)

Within Payment Unit(s) 1, cut all trees that are three (3) inches or more at DBH, except do not cut cedar, hemlock, or trees marked with green paint above and below stump height.

2.1.9 - Harvest Exception (12/24)

Do not cut any hemlock trees within Payment Unit(s) 6 and cedar within Payment Unit(s) 1, 3 and 4 other than those that are necessary to remove in order to operate within the Sale Area. Every effort must be made to preserve the existing hemlock and cedar and to leave an intact stand upon sale completion. All cut hemlock and cedar shall be piled separately by product and scaled in the woods, unless other scaling arrangements are agreed to by the Unit Manager or his/her representative. Stumpage price for hemlock and cedar shall be \$20.00 per cord.

2.1.11 - Description of Timber Note (2/04)

Note that Miscellaneous Species 2 is dead/dying mixed ash species.

2.2 - Utilization

2.2.4 - Skidding Length (12/24)

Skidding of unlimbed tops or lengths over 17 feet is not permissible, unless approved by the Unit Manager or his/her representative.

3 - Payments

3.3 - Pre-measured Sales

3.3.4 - Dividing Payment Units (7/14)

Payment Unit(s) with a value greater than \$18,000 may be divided at the request of the Purchaser and upon approval of the Unit Manager. Dividing Payment Units is a contract modification which requires a Timber Sale Contract Amendment. There will be only one division per Payment Unit.

4 - Transportation

4.1 - Construction

4.1.7 - Road Closure (10/11)

All new roads built into the sale must be blocked to vehicle traffic upon completion of the sale. Overgrown roads that are reopened shall be considered new roads. In general, this will require constructing a four (4') foot high berm of stumps and logs covered with earth. These roads must be rendered impassable to cars and trucks. Temporary berms may be required if no sale activity occurs for 30 or more consecutive days. Contact the Sale Administrator for specific details of design and placement.

4.2 - Maintenance

4.2.2 - Fill Material (4/07)

To maintain roads, fill material may be needed in areas where "holes" exist or may be expected to develop. This fill material should be placed before trucking begins. Contact the Sale Administrator regarding the availability of onsite sand or gravel from adjacent State-owned lands.

4.2.4 - Grading (10/16)

For completion of the sale, state forest roads must be graded. In general, this will require a road grader or bulldozer to shape up the roads after forest products have been hauled off site. This includes cleaning of drainage areas, grading, crowning and filling with gravel, if necessary. The grading equipment to be used must be approved by the Unit Manager or his/her representative.

4.4 - Access

4.4.1 - Private property access (3/11)

Permission for access across private land has been obtained by the DNR.

4.4.2 - Alternate route on private property (2/04)

It is the Purchaser's responsibility to obtain access across private land for any routes other than the route shown on the Timber Sale Map.

5 - Operations

5.2 - Conduct of Operations

5.2.2 - Hazard Trees/Snags

5.2.2.1 - Den Trees (10/16)

Obvious hollow and/or den trees shall be protected and left standing unless they are a safety hazard.

5.2.3 - Operating Restrictions

5.2.3.2 - Operating Restrictions (9/11)

Within Payment Unit(s) 1, 2, 3 and 4, unless changed by written agreement, cutting, skidding, and hauling are limited to the period of December 1 to March 31. This restriction is because of the private road going to state land on wet and low soil.

5.2.3.3 - Bark Slippage Restriction (3/09)

Within Payment Unit(s) 2, 5, 6, 7 and 8, unless changed by written agreement, cutting and skidding are not permitted during the period of April 15 to July 15. This restriction is because of bark slippage.

5.2.32 - Decking/Landing Restoration (9/13)

All decking and landing areas must have the surface area restored to a condition equal to or better than before. This is to ensure the proper regeneration of the stand. Wood debris, chips and "cookies" from trimmings must be removed or scattered away from landing and loading areas and may not be windrowed on the edge.

5.2.38 - No Decking Against Live Trees (2/04)

Cut products may not be decked against unmarked or designated leave trees.

5.4 - Soil Protection

5.4.1 - Rutting Restriction, General (7/16)

Operations are to cease immediately if equipment and weather conditions result in rutting of roads and/or skid trails which are 12 inches or greater in depth and 50 feet in length. The Unit Manager or his/her representative may restrict hauling and/or skidding if ruts exceed the specified depth. With the Unit Manager or his/her representative's approval, the Purchaser may return to the area when the risk of rutting has decreased.

5.4.6 - Wet Area Protection (5/10)

No harvesting operations, including skidding and felling, are to take place within the vernal pond areas or drainages. When harvesting occurs, there should be no disturbance to the vernal pond depression. All equipment, trees and tops should be kept out of this area. Within 100 feet of the pond, equipment should only be used when the soil is in a dry or frozen condition. Care must be taken by the Purchaser to identify and avoid operating in these areas of the timber sale.

6 - Safety and Fire Prevention

6.2 - Signing

6.2.1 - Road Posting (10/20)

The Purchaser is responsible for posting and maintaining caution signs on 10.1 Lane and County Road SD prior to beginning operations. The road must be posted at appropriate distances from the Sale Area to warn of logging activity and truck traffic. Signs must be removed when harvest operations are suspended or completed. The Purchaser will provide these signs.

7 - Other Conditions

7.5 - Loss

7.5.1 - Deteriorating Timber (7/09)

The Sale Area has received damage from Spruce Budworm and Emerald Ash Borer. The Purchaser should harvest the wood as soon as possible. The Department of Natural Resources is held free of responsibility of any further damage or deterioration due to delay in harvesting.



TIMBER SALE MAP

This information provided by authority of Part 525, 1994 PA 451, as amended.

Sale Number

33-007-25

Date

09/30/2025

Forest Management Unit

Escanaba Mgt Unit

County

Menominee

Mapped By: George Wilson

Cruised By: G.Wilson, J.Baker

Scale

1:15,840

Page

1

Of

4

Township
41N / 42N

Range
25W /

Section(s) and

Subdivision(s) Sec. 2 NENW,N1/2NE; Sec. 36 N1/2NW,NE; Sec. 6 N1/2NW; Sec. 8 SW;

Cover Type

A = Aspen	J = Jack Pine	O = Oak	U = Upland Brush
B = Paper Birch	K = Rock	P = Lowland Poplar	UM = Upland Mix Forest
C = Cedar	L = Lowland Brush	Q = Mixed Swamp Conifer	V = Bog or Marsh
D = Treed Bog	LM = Lowland Mix Forest	R = Red Pine	W = White Pine
E = Swamp Hardwoods	M = Maple, Beech, Birch	S = Black Spruce	X = Non Stocked
F = Spruce/Fir	MC = Mixed Conifer	T = Tamarack	Y = Sand
G = Grass	MD = Mixed Deciduous	Z = Water	
H = Hemlock	N = Marsh		

Density

0 = Non Stocked	5 = Pole Timber Medium
1 = Seedling Sapling Poor	6 = Pole Timber Well
2 = Seedling Sapling Medium	7 = Saw Timber Poor
3 = Seedling Sapling Well	8 = Saw Timber Medium
4 = Pole Timber Poor	9 = Saw Timber Well

Legend

- Against State (Red)
- Private Line (Blue)
- Payment Unit (Yellow)
- Poor Dirt Road
- Skid Trail
- Possible Skid Trail
- Lyme Access Road
- Recreational Trails
- Forest Access Route
- Paved Road
- Private Gravel/Dirt
- ◆ Survey Grade Corner

**MM Line
Hardwoods**

125.5 Acres

Payment Unit Number	Acres	Payment Unit Number	Acres
1	27.7	5	12.4
2	38	6	5.6
3	8	7	2.7
4	7.7	8	23.4

Compartment 65 & 66

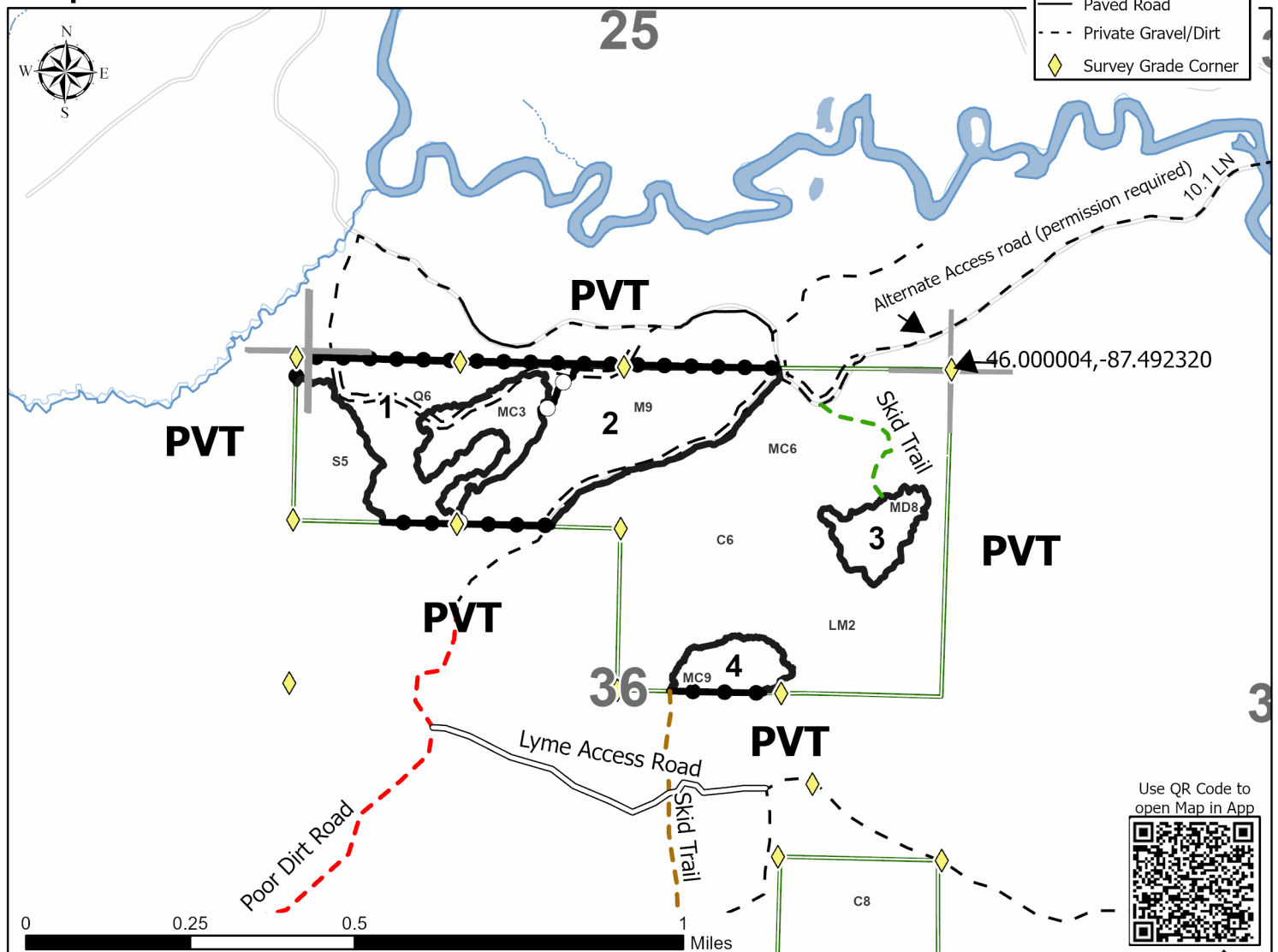

**TIMBER SALE MAP**

This information provided by authority of Part 525, 1994 PA 451, as amended.

Sale Number

33-007-25

Date

09/30/2025

Forest Management Unit

Escanaba Mgt Unit

County

Menominee

Mapped By: George Wilson

Cruised By: G.Wilson, J.Baker

Scale

1:15,840

Page

2

Of

4Township
41N / 42NRange
25W /Section(s) and
Subdivision(s)

Sec. 2 NENW,N1/2NE; Sec. 36 N1/2NW,NE; Sec. 6 N1/2NW; Sec. 8 SW;

Cover Type

A = Aspen	J = Jack Pine	O = Oak	U = Upland Brush
B = Paper Birch	K = Rock	P = Lowland Poplar	UM = Upland Mix Forest
C = Cedar	L = Lowland Brush	Q = Mixed Swamp Conifer	V = Bog or Marsh
D = Treed Bog	LM = Lowland Mix Forest	R = Red Pine	W = White Pine
E = Swamp Hardwoods	M = Maple, Beech, Birch	S = Black Spruce	X = Non Stocked
F = Spruce/Fir	MC = Mixed Conifer	T = Tamarack	Y = Sand
G = Grass	MD = Mixed Deciduous		Z = Water
H = Hemlock	N = Marsh		

Density

0 = Non Stocked	5 = Pole Timber Medium
1 = Seedling Sapling Poor	6 = Pole Timber Well
2 = Seedling Sapling Medium	7 = Saw Timber Poor
3 = Seedling Sapling Well	8 = Saw Timber Medium
4 = Pole Timber Poor	9 = Saw Timber Well

Legend

- Against State (Red)
- Private Line (Blue)
- - - Poor Dirt Road
- Lyme Access Road
- Recreational Trails
- - - Forest Access Route
- - - Private Gravel/Dirt
- ◆ Survey Grade Corner

Payment Unit Number	Acres	Payment Unit Number	Acres
1	27.7	5	12.4
2	38	6	5.6
3	8	7	2.7
4	7.7	8	23.4

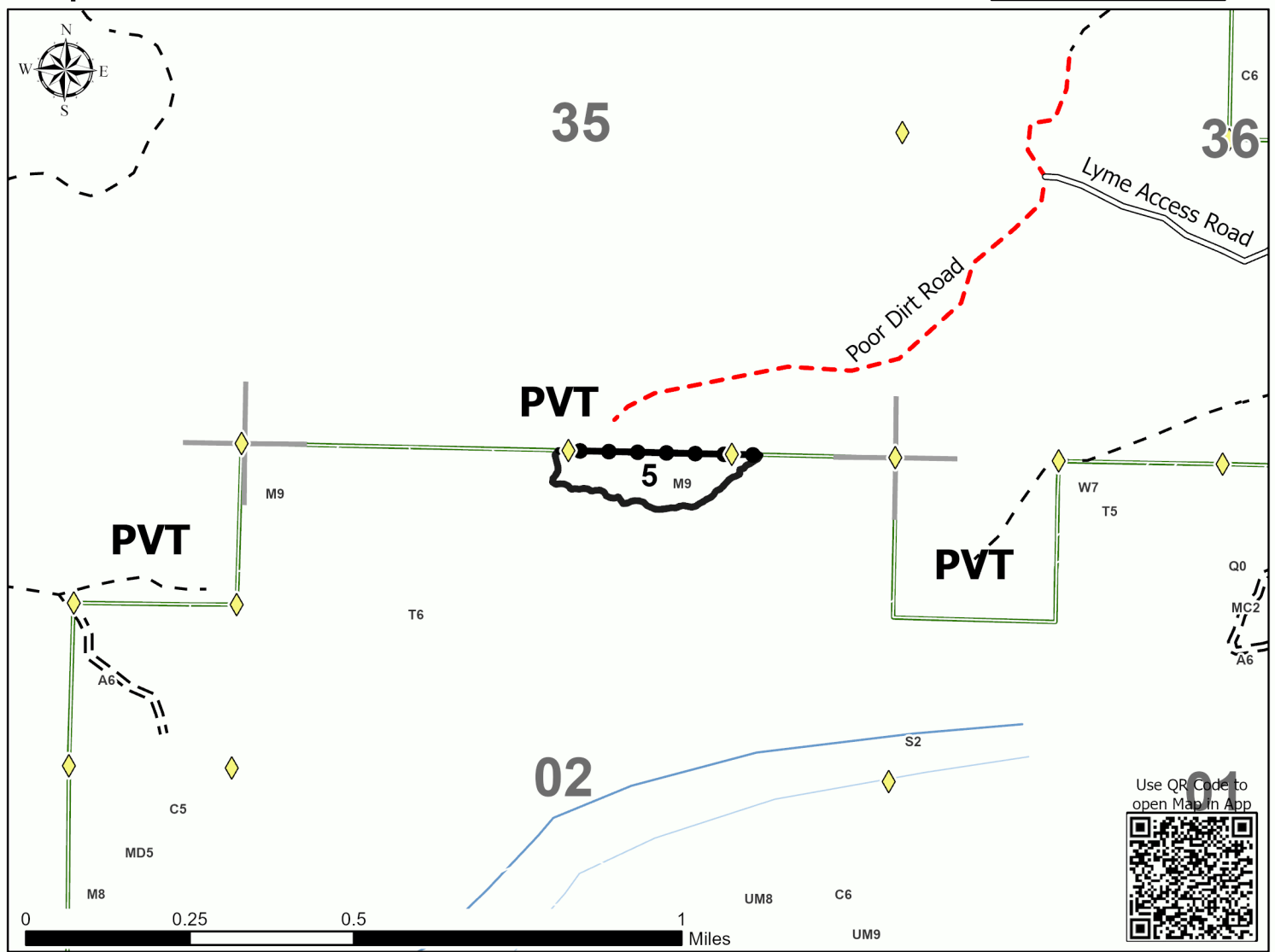
**MM Line
Hardwoods****125.5 Acres****Compartment 65 & 66**

TIMBER SALE MAP

This information provided by authority of Part 525, 1994 PA 451, as amended.

Sale Number 33-007-25	Date 09/30/2025	
Scale 1:15,840	Page 3	Of 4

Forest Management Unit	County	Mapped By: George Wilson	Scale	Page	Of
Escanaba Mgt Unit	Menominee	Cruised By: G.Wilson, J.Baker	1:15,840	3	4

Township 41N / 42N	Range 25W /	Section(s) and Subdivision(s) Sec. 2 NENW,N1/2NE; Sec. 36 N1/2NW,NE; Sec. 6 N1/2NW; Sec. 8 SW;
-----------------------	----------------	--











Cover Type

A = Aspen	J = Jack Pine	O = Oak	U = Upland Brush
B = Paper Birch	K = Rock	P = Lowland Poplar	UM = Upland Mix Forest
C = Cedar	L = Lowland Brush	Q = Mixed Swamp Conifer	V = Bog or Marsh
D = Treed Bog	LM = Lowland Mix Forest	R = Red Pine	W = White Pine
E = Swamp Hardwoods	M = Maple, Beech, Birch	S = Black Spruce	X = Non Stocked
F = Spruce/Fir	MC = Mixed Conifer	T = Tamarack	Y = Sand
G = Grass	MD = Mixed Deciduous		Z = Water
H = Hemlock	N = Marsh		

Density

0 = Non Stocked	5 = Pole Timber Medium
1 = Seedling Sapling Poor	6 = Pole Timber Well
2 = Seedling Sapling Medium	7 = Saw Timber Poor
3 = Seedling Sapling Well	8 = Saw Timber Medium
4 = Pole Timber Poor	9 = Saw Timber Well

Legend

-  Against State (Red)
-  Private Line (Blue)
-  Skid Trail
-  Possible Skid Trail
-  Lyme Access Road
-  Recreational Trails
-  Forest Access Route
-  Private Gravel/Dirt
-  Survey Grade Corner
-  Gate

Payment Unit Number	Acres	Payment Unit Number	Acres
1	27.7	5	12.4
2	38	6	5.6
3	8	7	2.7
4	7.7	8	23.4

MM Line Hardwoods

125.5 Acres

Compartment 65 & 66

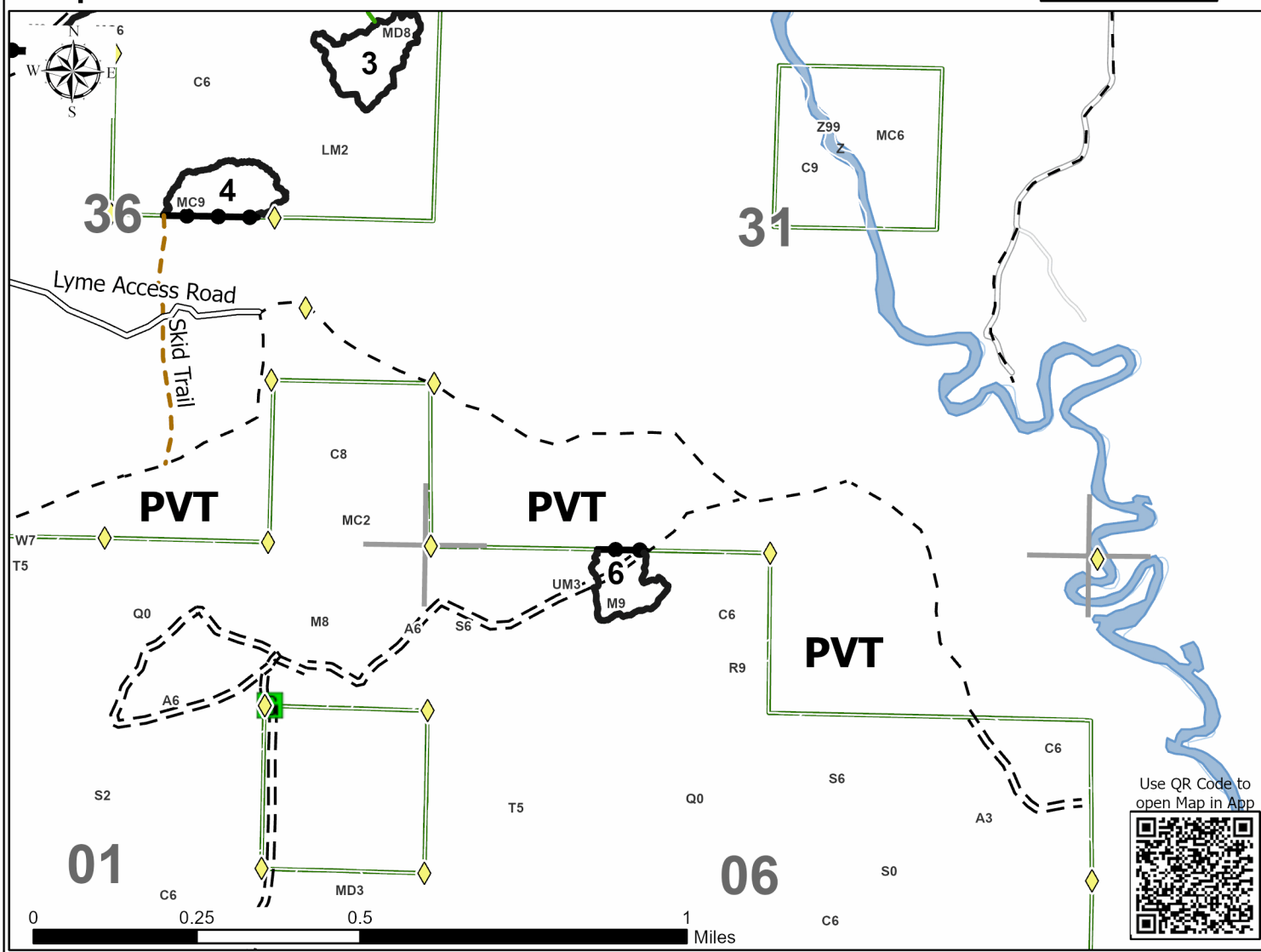

TIMBER SALE MAP

This information provided by authority of Part 525, 1994 PA 451, as amended.

Sale Number 33-007-25	Date 09/30/2025	
Scale 1:15,840	Page 4	Of 4

Forest Management Unit	County	Mapped By: George Wilson	Scale	Page	Of
Escanaba Mgt Unit	Menominee	Cruised By: G.Wilson, J.Baker	1:15,840	4	4

Township 41N / 42N	Range 25W /	Section(s) and Subdivision(s) Sec. 2 NENW,N1/2NE; Sec. 36 N1/2NW,NE; Sec. 6 N1/2NW; Sec. 8 SW;
-----------------------	----------------	--





Cover Type

A = Aspen	J = Jack Pine	O = Oak	U = Upland Brush
B = Paper Birch	K = Rock	P = Lowland Poplar	UM = Upland Mix Forest
C = Cedar	L = Lowland Brush	Q = Mixed Swamp Conifer	V = Bog or Marsh
D = Treed Bog	LM = Lowland Mix Forest	R = Red Pine	W = White Pine
E = Swamp Hardwoods	M = Maple, Beech, Birch	S = Black Spruce	X = Non Stocked
F = Spruce/Fir	MC = Mixed Conifer	T = Tamarack	Y = Sand
G = Grass	MD = Mixed Deciduous		Z = Water
H = Hemlock	N = Marsh		

Density

0 = Non Stocked	5 = Pole Timber Medium
1 = Seedling Sapling Poor	6 = Pole Timber Well
2 = Seedling Sapling Medium	7 = Saw Timber Poor
3 = Seedling Sapling Well	8 = Saw Timber Medium
4 = Pole Timber Poor	9 = Saw Timber Well

Legend

-  Against State (Red)
-  Private Line (Blue)
-  Recreational Trails
-  Forest Access Route
-  Private Gravel/Dirt
-  Survey Grade Corner

Payment Unit Number	Acres	Payment Unit Number	Acres
1	27.7	5	12.4
2	38	6	5.6
3	8	7	2.7
4	7.7	8	23.4

MM Line Hardwoods

125.5 Acres

Compartment 65 & 66

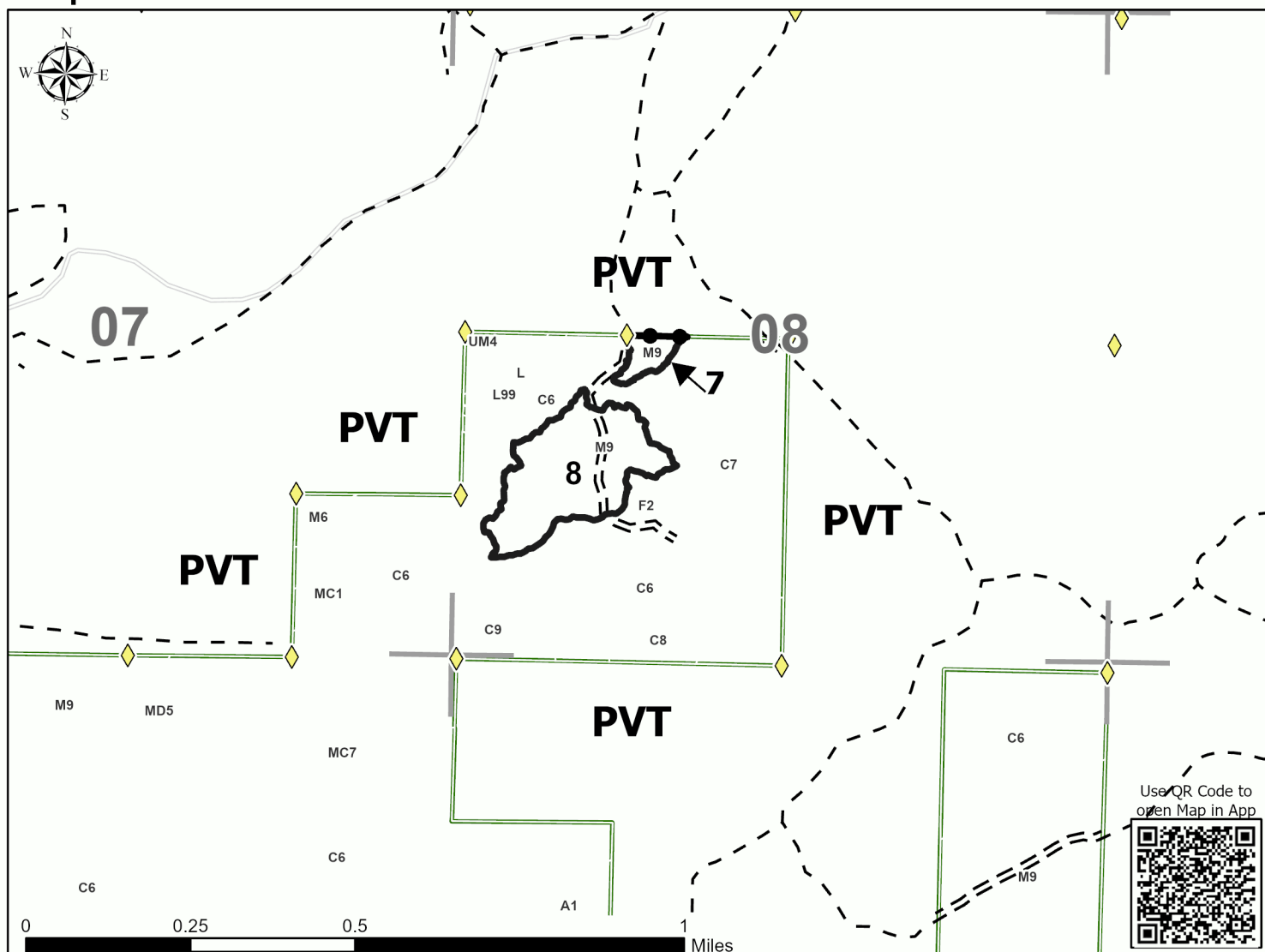

TIMBER SALE INFORMATION

Skidmore Beaver (33-031-24)

T41N, R26W, SEC. 10; T41N, R26W, SEC. 15; T41N, R26W, SEC. 16; T41N, R26W, SEC. 2; T41N, R26W, SEC. 3.
Menominee County (Advertised Price \$45,214.65)

SALE NOTE: Payment unit 5 is limited to frozen ground conditions or very dry summer. Payment unit 1 no cutting from April 15th to July 15th.

Access may be through private land.

A timber sale contract for this lump sum, sealed bid timber sale will be awarded to the responsible bidder offering the highest sealed bid price. All units of volume listed below were estimated using the Inventory Manager computer program and the new Michigan taper model. Bids must be at or above the following advertised price for each product and species:

<u>PRODUCTS & SPECIES</u>	<u>ESTIMATED UNITS*</u>		<u>ADVERTISED PRICE</u>
Sawtimber			
Sugar Maple	31.1	MBF	\$ 153.00 / MBF
Pulpwood			
Balsam Fir	149	Cords	\$ 5.85 / Cord
Basswood	5	Cords	\$ 4.85 / Cord
Mixed Aspen	1,906	Cords	\$ 15.70 / Cord
Mixed Hardwood	318	Cords	\$ 11.30 / Cord
Mixed Spruce	221	Cords	\$ 7.50 / Cord
N. White Cedar	47	Cords	\$ 4.95 / Cord
Tamarack	634	Cords	\$ 6.55 / Cord

* The total volume is statistically estimated within plus (+) or minus (-) 13.36 percent. There are an estimated 3,356 cords on this timber sale, plus or minus 449 cords at the 95% confidence level. The estimated units are final and not subject to adjustment. Prospective bidders are urged to examine this timber and to make their own estimates of quantity and quality.

BOND AND PAYMENT SCHEDULE:

1. A bond in the amount of \$3,617.00 to insure faithful performance of the conditions of the contract will be deposited by the successful bidder within 21 days of the sale award.
2. Cutting in any sale or unit without the required advance payment would be considered a trespass.
3. Total payment must be paid in advance or according to the following schedule :
 - (a) Ten percent (10%) of the sale value must be paid within 21 days of the sale award.
 - (b) The 10% down payment will be credited towards the first unit cut.
 - (c) Payment for each of the following units must be made before cutting begins in that unit:

PAYMENT UNIT NUMBER	PERCENT OF TOTAL SALE VALUE
01	11.6%
02	9.5%
03	47.8%
04	18.1%
05	13.0%

4. If no cutting takes place, the 10% down payment will not be refunded.

5. Operations on the contract issued will terminate on 06/30/2030.

SALE STATISTICS

Volumes were calculated in cubic feet using the Michigan taper model. Cubic foot volume includes all wood inside bark for the product indicated. For display purposes, cubic feet were converted to cords and MBF using a simple conversion factor, e.g. 79 cubic feet per cord and 185 cubic feet per MBF. The cubic foot volumes are precise; the cords and MBF volumes are not. Cubic foot volume cannot be directly converted to cords or boards with precision.

SALE VOLUMES

The total estimated sale volume may not equal the sum of the species/products due to the nature of statistical calculations associated with double sampling methodology.

VOLUME			STATISTICAL RANGE IN CORDS	
TOTAL CUBIC FEET	TOTAL CORDS	PERCENT ERROR	MINIMUM	MAXIMUM
265,125	3,356	13.36%	2,907	3,805

VDU VOLUMES

A VDU is a Volume Determination Unit. Volumes and their associated statistics are calculated at the VDU level and summarized to the sale level. There is often a one to one relationship between a VDU and a Payment Unit, but not always, depending on the cruise design. Refer to the VDU TO PAYMENT UNIT table.

	VOLUME			RANGE IN CORDS	
VDU	TOTAL CUBIC FEET	TOTAL CORDS	PERCENT ERROR	MINIMUM	MAXIMUM
1	26,491	335	49.63%	169	502
15	163,978	2,076	17.92%	1,704	2,448
30	63,213	800	23.65%	611	989
77	11,443	145	53.78%	67	223
TOTAL:	265,125	3,356		2,551	4,161

VDU TO PAYMENT UNIT

When a VDU is associated with more than one Payment Unit (PU), the VDU volumes are assigned to the PU based on acres of the VDU within the PU.

VDU	VDU ACRES	PU	PU ACRES
1	14.7	2	14.7
15	63.5	3	46.1
		4	17.4
30	36.3	5	36.3
77	9.9	1	9.9
TOTAL:	124.4		124.4

DESCRIPTION OF TIMBER BY PAYMENT UNIT (PU)

PU	MARKET GROUP	PRODUCT	QUANTITY	UNIT	ACRES	ADVERTISE PRICE
1	Sugar Maple	Sawtimber	28.8	MBF	9.9	\$5,244.25
	Basswood	Pulpwood	5	Cords		
	<i>Basswood</i>	<i>Sawtimber</i>	1.8	<i>MBF</i>		
	<i>Basswood</i>	<i>Pulpwood</i>	1	<i>Cords</i>		
	Mixed Hardwood		72	Cords		
	<i>Paper Birch</i>	<i>Sawtimber</i>	1.1	<i>MBF</i>		
	<i>Ironwood</i>	<i>Pulpwood</i>	7	<i>Cords</i>		
	<i>Paper Birch</i>		2	<i>Cords</i>		
	<i>Sugar Maple</i>		61	<i>Cords</i>		
2	Balsam Fir	Pulpwood	14	Cords	14.7	\$4,295.30
	Mixed Aspen		217	Cords		
	<i>B. T. Aspen</i>		4	<i>Cords</i>		
	<i>Quaking Aspen</i>		213	<i>Cords</i>		
	Mixed Hardwood		9	Cords		
	<i>Balsam Poplar</i>		7	<i>Cords</i>		
	<i>Black Cherry</i>		2	<i>Cords</i>		
	Mixed Spruce		80	Cords		
	<i>Black Spruce</i>		75	<i>Cords</i>		
	<i>White Spruce</i>		5	<i>Cords</i>		
	Tamarack		16	Cords		
3	Sugar Maple	Sawtimber	1.7	MBF	46.1	\$21,639.80
	Balsam Fir	Pulpwood	98	Cords		
	Mixed Aspen		1,185	Cords		
	<i>Quaking Aspen</i>		1,185	<i>Cords</i>		
	Mixed Hardwood		172	Cords		
	<i>Balsam Poplar</i>		56	<i>Cords</i>		
	<i>Black Cherry</i>		6	<i>Cords</i>		
	<i>Ironwood</i>		7	<i>Cords</i>		
	<i>Paper Birch</i>		8	<i>Cords</i>		
	<i>Red Maple</i>		15	<i>Cords</i>		
	<i>Sugar Maple</i>		57	<i>Cords</i>		
	<i>Yellow Birch</i>		23	<i>Cords</i>		
	Mixed Spruce		12	Cords		
	<i>Black Spruce</i>		8	<i>Cords</i>		
	<i>White Spruce</i>		4	<i>Cords</i>		
	N. White Cedar		34	Cords		
4	Sugar Maple	Sawtimber	0.6	MBF	17.4	\$8,162.50
	Balsam Fir	Pulpwood	37	Cords		
	Mixed Aspen		447	Cords		
	<i>Quaking Aspen</i>		447	<i>Cords</i>		
	Mixed Hardwood		65	Cords		
	<i>Balsam Poplar</i>		21	<i>Cords</i>		
	<i>Black Cherry</i>		2	<i>Cords</i>		
	<i>Ironwood</i>		3	<i>Cords</i>		
	<i>Paper Birch</i>		3	<i>Cords</i>		
	<i>Red Maple</i>		6	<i>Cords</i>		
	<i>Sugar Maple</i>		22	<i>Cords</i>		
	<i>Yellow Birch</i>		8	<i>Cords</i>		
	Mixed Spruce		5	Cords		
	<i>Black Spruce</i>		3	<i>Cords</i>		
	<i>White Spruce</i>		2	<i>Cords</i>		
	N. White Cedar		13	Cords		
5	Mixed Aspen	Pulpwood	57	Cords	36.3	\$5,872.80
	<i>B. T. Aspen</i>		14	<i>Cords</i>		
	<i>Quaking Aspen</i>		43	<i>Cords</i>		
	Mixed Spruce		124	Cords		

DESCRIPTION OF TIMBER BY PAYMENT UNIT (PU), CON'T

PU	MARKET GROUP	PRODUCT	QUANTITY	UNIT	ACRES	ADVERTISE PRICE
5 con't	<i>Black Spruce</i> Tamarack	<i>Pulpwood</i>	124 618	<i>Cords</i> Cords		
TOTAL:			31.1	MBF		
TOTAL:			3,280	Cords		

Sale Specific Conditions & Requirements

Sale Name: Skidmore Beaver

Sale Number: 33-031-24 Seq#: 2

1 - Sale Area

1.2 - Boundaries

1.2.1 - Painted Boundaries (9/19)

The sale boundary and Payment Unit boundaries are marked and identified by blue and red paint. Exterior sale boundary lines against private property are marked with blue paint. Exterior sale boundary lines against state are marked with red paint. The painted boundary line trees are not Included Timber and are to be protected unless marked with orange paint.

2 - Timber Specifications

2.1 - Included Timber

2.1.1 - Clearcut Unit(s) with Unmerchantable Trees (6/14)

Within Payment Unit(s) 2-5, cut all trees that are three (3) inches or more at DBH, except:

Within Payment Unit 2, do not cut hemlock, cedar, pine, or cherry.

Within Payment Units 3 and 4, do not cut pine or trees marked in green paint.

Within Payment Unit 5, do not cut hemlock, cedar, or pine.

2.1.3 - Cut Tree Marked Unit(s) (12/08)

Within Payment Unit(s) 1, all trees are designated for cutting when marked with orange paint above and below stump height, regardless of merchantability.

3 - Payments

3.3 - Pre-measured Sales

3.3.4 - Dividing Payment Units (7/14)

Payment Unit(s) \$18,000 or more may be divided at the request of the Purchaser and upon approval of the Unit Manager.

Dividing Payment Units is a contract modification which requires a Timber Sale Contract Amendment. There will be only one division per Payment Unit.

4 - Transportation

4.1 - Construction

4.1.6 - Road Construction (4/24)

Construction of new roads or improvements of existing roads shall be done in such a way as to minimize the environmental and visual impacts. Merchantable trees shall be cut and utilized unless otherwise directed. Non-merchantable trees shall be severed and laid flat on the ground. Slash shall be scattered, and not left in windrows and kept a minimum of 10 feet back from the road edge. Stumps shall be set upright, not left on edge, and be moved at least 10 feet away from the road edge. Disturbed soil shall be feathered into the woods and not left in berms or windrows.

4.1.7 - Road Closure (10/11)

All new roads built into the sale must be blocked to vehicle traffic upon completion of the sale. Overgrown roads that are reopened shall be considered new roads. In general, this will require constructing a four (4') foot high berm of stumps and logs covered with earth. These roads must be rendered impassable to cars and trucks. Temporary berms may be required if no sale activity occurs for 30 or more consecutive days. Contact the Sale Administrator for specific details of design and placement.

4.2 - Maintenance

4.2.1 - Hauling Restriction (12/08)

Hauling may be restricted on forest roads by the Unit Manager or his/her representative. The restriction may occur during spring breakup or prolonged wet weather conditions.

4.2.4 - Grading (10/16)

For completion of the sale, state forest roads must be graded. In general, this will require a road grader or bulldozer to shape up the roads after forest products have been hauled off site. This includes cleaning of drainage areas, grading, crowning and filling with gravel, if necessary. The grading equipment to be used must be approved by the Unit Manager or his/her representative.

4.4 - Access

4.4.1 - Private property access (3/11)

Permission for access across private land is the responsibility of the Purchaser.

5 - Operations

5.2 - Conduct of Operations

5.2.3 - Operating Restrictions

5.2.3.1 - Operating Restrictions (9/11)

Within Payment Unit(s) 5, cutting and skidding are limited to frozen ground or very dry summer conditions. This restriction is because of the organic soils.

5.2.3.3 - Bark Slippage Restriction (3/09)

Within Payment Unit(s) 1, unless changed by written agreement, cutting and skidding are not permitted during the period of April 15 to July 15. This restriction is because of bark slippage.

5.2.32 - Decking/Landing Restoration (9/13)

All decking and landing areas must have the surface area restored to a condition equal to or better than before. This is to ensure the proper regeneration of the stand. Wood debris, chips and "cookies" from trimmings must be removed or scattered away from landing and loading areas and may not be windrowed on the edge.

5.2.38 - No Decking Against Live Trees (2/04)

Cut products may not be decked against unmarked or designated leave trees.

5.4 - Soil Protection

5.4.1 - Rutting Restriction, General (7/16)

Operations are to cease immediately if equipment and weather conditions result in rutting of roads and/or skid trails which is 12 inches or greater in depth and 50 feet in length. The Unit Manager or his/her representative may restrict hauling and/or skidding if ruts exceed the specified depth. With the Unit Manager or his/her representative's approval, the Purchaser may return to the area when the risk of rutting has decreased.

5.8 - Protection of Endangered Species

5.8.5 - Protection of Raptor Nests (3/13)

All trees with raptor nests will be protected if found during harvesting operations. Notification will be made to the Unit Manager or his/her representative who will notify the Wildlife Biologist so an onsite evaluation and recommendation can be made, if necessary.

6 - Safety and Fire Prevention

6.2 - Signing

6.2.1 - Road Posting (10/20)

The Purchaser is responsible for posting and maintaining caution signs on the haul route prior to beginning operations. The road must be posted at appropriate distances from the Sale Area to warn of logging activity and truck traffic. Signs must be removed when harvest operations are suspended or completed. The Purchaser will provide these signs.



TIMBER SALE MAP

This information provided by authority of Part 525, 1994 PA 451, as amended.

Sale Number

33-031-24

Date

09/25/2024

Forest Management Unit

Escanaba Mgt Unit

County

Menominee

Mapped By: Dan Racine

Cruised By: Dickinson Co. crew

Scale

1:31,680

Page

1

Of

1

Township
41N

Range
26W

Section(s) and
Subdivision(s)

Sec. 10 S1/2NW,N1/2SW,SWSW; Sec. 15 NWNW; Sec. 16 W1/2NE; Sec. 2 NWNW; Sec. 3 SWSW;

Cover Type

A = Aspen	J = Jack Pine	O = Oak	U = Upland Brush
B = Paper Birch	K = Rock	P = Lowland Poplar	UM = Upland Mix Forest
C = Cedar	L = Lowland Brush	Q = Mixed Swamp Conifer	V = Bog or Marsh
D = Treed Bog	LM = Lowland Mix Forest	R = Red Pine	W = White Pine
E = Swamp Hardwoods	M = Maple, Beech, Birch	S = Black Spruce	X = Non Stocked
F = Spruce/Fir	MC = Mixed Conifer	T = Tamarack	Y = Sand
G = Grass	MD = Mixed Deciduous		Z = Water
H = Hemlock	N = Marsh		

Density

0 = Non Stocked	5 = Pole Timber Medium
1 = Seedling Sapling Poor	6 = Pole Timber Well
2 = Seedling Sapling Medium	7 = Saw Timber Poor
3 = Seedling Sapling Well	8 = Saw Timber Medium
4 = Pole Timber Poor	9 = Saw Timber Well

Skidmore Beaver

124.4 Acres

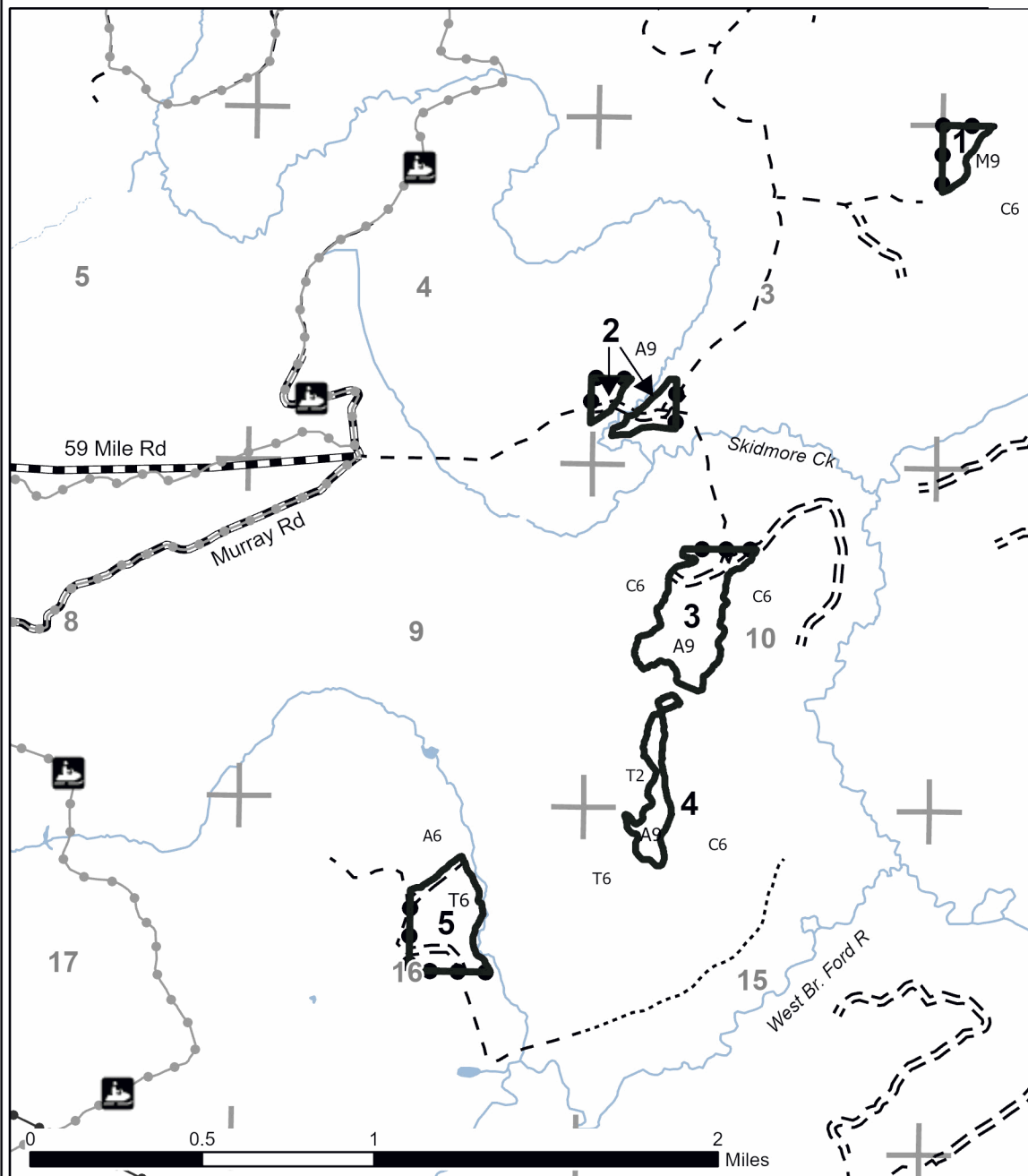

PU #	Acres
1	9.9
2	14.7
3	46.1
4	17.4
5	36.3



Legend

- Against State (Red)
- Private Line (Blue)
- Recreational Trail
- Powerline
- Forest Access Route
- Administrative Access Only
- Paved Road
- Government Gravel/Dirt
- Private Gravel/Dirt
- Section Corner

Skidmore Beaver (33-031-24)

T41N, R26W, SEC. 10; T41N, R26W, SEC. 15; T41N, R26W, SEC. 16; T41N,

In response to the notice of sale to be held 3:00 p.m. (local time) on March 11, 2026, I am hereby submitting my sealed bid (firm offer) for the following forest products to be cut. Bids for individual species must be at or above the advertised price. All non-responsive bid forms may be rejected.

<u>PRODUCTS & SPECIES</u>	<u>ESTIMATED VOLUME*</u>	<u>ADVERTISED PRICE</u>	<u>BID PRICE/UNIT</u>
Sawtimber			
Sugar Maple	31.1 MBF	\$ 153.00/MBF	\$ _____
Pulpwood			
Balsam Fir	149 Cords	\$ 5.85/Cord	\$ _____
Basswood	5 Cords	\$ 4.85/Cord	\$ _____
Mixed Aspen	1,906 Cords	\$ 15.70/Cord	\$ _____
Mixed Hardwood	318 Cords	\$ 11.30/Cord	\$ _____
Mixed Spruce	221 Cords	\$ 7.50/Cord	\$ _____
N. White Cedar	47 Cords	\$ 4.95/Cord	\$ _____
Tamarack	634 Cords	\$ 6.55/Cord	\$ _____

*The volumes are statistically estimated within plus (+) or minus (-) 13.36 percent at 95% confidence level. These estimated volumes are final and not subject to adjustment. Prospective bidders are urged to examine this timber and to make their own estimates of quantity and quality.

I understand that any or all bids may be rejected. All bids must be signed and all bid items must be bid or the bid form may be rejected. I also understand that consideration and awarding a contract will be based upon my past performance and ability to complete the contract based upon equipment and staffing subject to my control.

FEDERAL ID: ____ - ____ - ____ or SOCIAL SECURITY NUMBER: ____ - ____ - ____

Company or individual bidding: _____

Company representative's name: _____

Address: _____

City: _____ State: _____ Zip: _____

IF AVAILABLE, PLEASE PLACE THE PERSONALIZED LABEL FROM YOUR PROSPECTUS IN THE ABOVE BOX.

Individual or company representative's signature: _____ Date: _____

Phone number : _____ Email (optional): _____

**THE WINNING BIDDER MUST COMPLETE THE VERIFICATION OF WORKER'S DISABILITY COMPENSATION ACT
COMPLIANCE (ON REVERSE SIDE IF DOUBLE SIDED) WITHIN 21 DAYS OF SALE AWARD DATE**



TIMBER SALE VERIFICATION OF WORKER'S DISABILITY COMPENSATION ACT COMPLIANCE

As required by Act 317, P.A. 1969 (Worker's Compensation) and
Part 5 of Act 451 of 1994, as amended.

FOR DEPARTMENT USE ONLY

Sale Number (XX - XXX - XX - XX)

Forest Management Unit:

VERIFICATION OF WORKER'S DISABILITY COMPENSATION ACT COMPLIANCE

- This verification must be completed and submitted within 21 days of contract award and prior to the issuance of the timber sale contract.
- In addition, if boxes 2B or 2C are checked, then Notice of Exclusion or Certificate of Insurance must be submitted within twenty-one (21) days of the contract award and prior to the issuance of the timber sale contract.
- All information must be typed or printed except for written signatures.

Please Check Appropriate Categories:

1. My business is organized as (you **must** check one of the boxes below):
 - A. ☐ Sole Proprietorship (individual)
 - B. ☐ Partnership
 - C. ☐ Corporation
2. You **must** check one of the boxes below:
 - A. ☐ I certify my business is a sole proprietorship and it has no employees but the sole proprietor. I am not subject to the Worker's Compensation Laws.
 - B. ☐ I certify my business has satisfied its obligation to the Worker's Compensation Act through the use of an approved Notice of Exclusion (BWC-337, Rev. 5/96). I will provide a copy of the Notice of Exclusion within 21 days of the contract award. (For questions or a copy of the BWC-337, please call the Worker's Compensation Bureau at 517-322-1195).
 - C. ☐ I certify my business has a Worker's Compensation Policy. I will provide an original Certificate of Insurance within twenty-one (21) days of the contract award.
3. If you have checked item 2(A) or 2(B), you **must** indicate the number of **both** full-time and part-time employees, other than yourself, including family members and active partners (if none, you must enter "0").

_____ Full-time Employees

_____ Part-time Employees

Name of Business		Federal ID (or) Social Security No.
Address		Telephone ()
City	State	ZIP

I hereby certify that the above information is true and correct. I agree to notify the Michigan DNR of any changes that occur in factors affecting my coverage during any of my present and future operations.

Signature of Owner or Authorized Representative

Title

Date

Please complete the "SEALED BID" information on the next page

Twin Morels (12-011-25)

T40N, R28W, SEC. 5; T40N, R28W, SEC. 6; T40N, R28W, SEC. 7; T40N, R29W,

In response to the notice of sale to be held 3:00 p.m. (local time) on March 11, 2026, I am hereby submitting my sealed bid (firm offer) for the following forest products to be cut. Bids for individual species must be at or above the advertised price. All non-responsive bid forms may be rejected.

<u>PRODUCTS & SPECIES</u>	<u>ESTIMATED VOLUME*</u>	<u>ADVERTISED PRICE</u>	<u>BID PRICE/UNIT</u>
Sawtimber			
Basswood	118.6 MBF	\$ 39.00/MBF	\$ _____
Paper Birch	9.0 MBF	\$ 69.00/MBF	\$ _____
Red Maple	29.4 MBF	\$ 125.00/MBF	\$ _____
Sugar Maple	128.6 MBF	\$ 230.00/MBF	\$ _____
Yellow Birch	5.8 MBF	\$ 89.00/MBF	\$ _____
Pulpwood			
Balsam Fir	132 Cords	\$ 4.15/Cord	\$ _____
Misc. Species 1	210 Cords	\$ 2.85/Cord	\$ _____
Mixed Hardwood	2,168 Cords	\$ 9.45/Cord	\$ _____
Mixed Spruce	95 Cords	\$ 8.05/Cord	\$ _____
Quaking Aspen	280 Cords	\$ 13.70/Cord	\$ _____

*The volumes are statistically estimated within plus (+) or minus (-) 10.88 percent at 95% confidence level. These estimated volumes are final and not subject to adjustment. Prospective bidders are urged to examine this timber and to make their own estimates of quantity and quality.

I understand that any or all bids may be rejected. All bids must be signed and all bid items must be bid or the bid form may be rejected. I also understand that consideration and awarding a contract will be based upon my past performance and ability to complete the contract based upon equipment and staffing subject to my control.

FEDERAL ID: ____ - ____ - ____ or SOCIAL SECURITY NUMBER: ____ - ____ - ____

Company or individual bidding: _____

Company representative's name: _____

Address: _____

City: _____ State: _____ Zip: _____

IF AVAILABLE, PLEASE PLACE THE PERSONALIZED LABEL FROM YOUR PROSPECTUS IN THE ABOVE BOX.

Individual or company representative's signature: _____ Date: _____

Phone number : _____ Email (optional): _____

**THE WINNING BIDDER MUST COMPLETE THE VERIFICATION OF WORKER'S DISABILITY COMPENSATION ACT
COMPLIANCE (ON REVERSE SIDE IF DOUBLE SIDED) WITHIN 21 DAYS OF SALE AWARD DATE**



TIMBER SALE VERIFICATION OF WORKER'S DISABILITY COMPENSATION ACT COMPLIANCE

As required by Act 317, P.A. 1969 (Worker's Compensation) and
Part 5 of Act 451 of 1994, as amended.

FOR DEPARTMENT USE ONLY

Sale Number (XX - XXX - XX - XX)

Forest Management Unit:

VERIFICATION OF WORKER'S DISABILITY COMPENSATION ACT COMPLIANCE

- This verification must be completed and submitted within 21 days of contract award and prior to the issuance of the timber sale contract.
- In addition, if boxes 2B or 2C are checked, then Notice of Exclusion or Certificate of Insurance must be submitted within twenty-one (21) days of the contract award and prior to the issuance of the timber sale contract.
- All Information must be typed or printed except for written signatures.

Please Check Appropriate Categories:

1. My business is organized as (you **must** check one of the boxes below):
 - A. ☐ Sole Proprietorship (individual)
 - B. ☐ Partnership
 - C. ☐ Corporation
2. You **must** check one of the boxes below:
 - A. ☐ I certify my business is a sole proprietorship and it has no employees but the sole proprietor. I am not subject to the Worker's Compensation Laws.
 - B. ☐ I certify my business has satisfied its obligation to the Worker's Compensation Act through the use of an approved Notice of Exclusion (BWC-337, Rev. 5/96). I will provide a copy of the Notice of Exclusion within 21 days of the contract award. (For questions or a copy of the BWC-337, please call the Worker's Compensation Bureau at 517-322-1195).
 - C. ☐ I certify my business has a Worker's Compensation Policy. I will provide an original Certificate of Insurance within twenty-one (21) days of the contract award.
3. If you have checked item 2(A) or 2(B), you **must** indicate the number of **both** full-time and part-time employees, other than yourself, including family members and active partners (if none, you must enter "0").

_____ Full-time Employees

_____ Part-time Employees

Name of Business		Federal ID (or) Social Security No.
Address		Telephone ()
City	State	ZIP

I hereby certify that the above information is true and correct. I agree to notify the Michigan DNR of any changes that occur in factors affecting my coverage during any of my present and future operations.

Signature of Owner or Authorized Representative

Title

Date

Please complete the "SEALED BID" information on the next page

Red Eye Hazel (12-012-25)

T41N, R29W, SEC. 16; T41N, R29W, SEC. 22; T41N, R29W, SEC. 23; T41N,

In response to the notice of sale to be held 3:00 p.m. (local time) on March 11, 2026, I am hereby submitting my sealed bid (firm offer) for the following forest products to be cut. Bids for individual species must be at or above the advertised price. All non-responsive bid forms may be rejected.

<u>PRODUCTS & SPECIES</u>	<u>ESTIMATED VOLUME*</u>	<u>ADVERTISED PRICE</u>	<u>BID PRICE/UNIT</u>
Pulpwood			
Balsam Fir	21 Cords	\$ 5.40/Cord	\$ _____
Black Spruce	40 Cords	\$ 10.50/Cord	\$ _____
Mixed Aspen	887 Cords	\$ 17.90/Cord	\$ _____
Mixed Hardwood	48 Cords	\$ 12.35/Cord	\$ _____
Red Pine	583 Cords	\$ 74.30/Cord	\$ _____

*The volumes are statistically estimated within plus (+) or minus (-) 22.86 percent at 95% confidence level. These estimated volumes are final and not subject to adjustment. Prospective bidders are urged to examine this timber and to make their own estimates of quantity and quality.

I understand that any or all bids may be rejected. All bids must be signed and all bid items must be bid or the bid form may be rejected. I also understand that consideration and awarding a contract will be based upon my past performance and ability to complete the contract based upon equipment and staffing subject to my control .

FEDERAL ID: ____ - ____ - ____ or SOCIAL SECURITY NUMBER: ____ - ____ - ____

Company or individual bidding: _____

Company representative's name: _____

Address: _____

City: _____ State: _____ Zip: _____

IF AVAILABLE, PLEASE PLACE THE PERSONALIZED LABEL FROM YOUR PROSPECTUS IN THE ABOVE BOX.

Individual or company representative's signature: _____ Date: _____

Phone number : _____ Email (optional): _____

**THE WINNING BIDDER MUST COMPLETE THE VERIFICATION OF WORKER'S DISABILITY COMPENSATION ACT
COMPLIANCE (ON REVERSE SIDE IF DOUBLE SIDED) WITHIN 21 DAYS OF SALE AWARD DATE**



TIMBER SALE VERIFICATION OF WORKER'S DISABILITY COMPENSATION ACT COMPLIANCE

As required by Act 317, P.A. 1969 (Worker's Compensation) and
Part 5 of Act 451 of 1994, as amended.

FOR DEPARTMENT USE ONLY

Sale Number (XX - XXX - XX - XX)

Forest Management Unit:

VERIFICATION OF WORKER'S DISABILITY COMPENSATION ACT COMPLIANCE

- This verification must be completed and submitted within 21 days of contract award and prior to the issuance of the timber sale contract.
- In addition, if boxes 2B or 2C are checked, then Notice of Exclusion or Certificate of Insurance must be submitted within twenty-one (21) days of the contract award and prior to the issuance of the timber sale contract.
- All information must be typed or printed except for written signatures.

Please Check Appropriate Categories:

1. My business is organized as (you **must** check one of the boxes below):
 - A. ☐ Sole Proprietorship (individual)
 - B. ☐ Partnership
 - C. ☐ Corporation
2. You **must** check one of the boxes below:
 - A. ☐ I certify my business is a sole proprietorship and it has no employees but the sole proprietor. I am not subject to the Worker's Compensation Laws.
 - B. ☐ I certify my business has satisfied its obligation to the Worker's Compensation Act through the use of an approved Notice of Exclusion (BWC-337, Rev. 5/96). I will provide a copy of the Notice of Exclusion within 21 days of the contract award. (For questions or a copy of the BWC-337, please call the Worker's Compensation Bureau at 517-322-1195).
 - C. ☐ I certify my business has a Worker's Compensation Policy. I will provide an original Certificate of Insurance within twenty-one (21) days of the contract award.
3. If you have checked item 2(A) or 2(B), you **must** indicate the number of **both** full-time and part-time employees, other than yourself, including family members and active partners (if none, you must enter "0").

_____ Full-time Employees

_____ Part-time Employees

Name of Business		Federal ID (or) Social Security No.
Address		Telephone ()
City	State	ZIP

I hereby certify that the above information is true and correct. I agree to notify the Michigan DNR of any changes that occur in factors affecting my coverage during any of my present and future operations.

Signature of Owner or Authorized Representative

Title

Date

Please complete the "SEALED BID" information on the next page

MM Line Hardwoods (33-007-25)

T41N, R25W, SEC. 6; T41N, R25W, SEC. 8; T41N, R26W, SEC. 2; T42N, R26W,

In response to the notice of sale to be held 3:00 p.m. (local time) on March 11, 2026, I am hereby submitting my sealed bid (firm offer) for the following forest products to be cut. Bids for individual species must be at or above the advertised price. All non-responsive bid forms may be rejected.

<u>PRODUCTS & SPECIES</u>	<u>ESTIMATED VOLUME*</u>	<u>ADVERTISED PRICE</u>	<u>BID PRICE/UNIT</u>
Sawtimber			
Paper Birch	5.6 MBF	\$ 78.00/MBF	\$ _____
Red Maple	24.4 MBF	\$ 100.00/MBF	\$ _____
Sugar Maple	86.2 MBF	\$ 229.00/MBF	\$ _____
Yellow Birch	1.5 MBF	\$ 40.00/MBF	\$ _____
Pulpwood			
Balsam Fir	22 Cords	\$ 8.75/Cord	\$ _____
Black Spruce	218 Cords	\$ 11.25/Cord	\$ _____
Misc. Species 2	8 Cords	\$ 3.75/Cord	\$ _____
Mixed Aspen	54 Cords	\$ 23.55/Cord	\$ _____
Mixed Hardwood	1,041 Cords	\$ 16.95/Cord	\$ _____
Red Pine	365 Cords	\$ 51.35/Cord	\$ _____
Tamarack	32 Cords	\$ 9.85/Cord	\$ _____
White Pine	329 Cords	\$ 17.75/Cord	\$ _____

*The volumes are statistically estimated within plus (+) or minus (-) 16.02 percent at 95% confidence level. These estimated volumes are final and not subject to adjustment. Prospective bidders are urged to examine this timber and to make their own estimates of quantity and quality.

I understand that any or all bids may be rejected. All bids must be signed and all bid items must be bid or the bid form may be rejected. I also understand that consideration and awarding a contract will be based upon my past performance and ability to complete the contract based upon equipment and staffing subject to my control.

FEDERAL ID: ____ - ____ - ____ or SOCIAL SECURITY NUMBER: ____ - ____ - ____

Company or individual bidding: _____

Company representative's name: _____

Address: _____

City: _____ State: _____ Zip: _____

IF AVAILABLE, PLEASE PLACE THE PERSONALIZED LABEL FROM YOUR PROSPECTUS IN THE ABOVE BOX.

Individual or company representative's signature: _____ Date: _____

Phone number : _____ Email (optional): _____

**THE WINNING BIDDER MUST COMPLETE THE VERIFICATION OF WORKER'S DISABILITY COMPENSATION ACT
COMPLIANCE (ON REVERSE SIDE IF DOUBLE SIDED) WITHIN 21 DAYS OF SALE AWARD DATE**



TIMBER SALE VERIFICATION OF WORKER'S DISABILITY COMPENSATION ACT COMPLIANCE

As required by Act 317, P.A. 1969 (Worker's Compensation) and
Part 5 of Act 451 of 1994, as amended.

FOR DEPARTMENT USE ONLY

Sale Number (XX - XXX - XX - XX)

Forest Management Unit:

VERIFICATION OF WORKER'S DISABILITY COMPENSATION ACT COMPLIANCE

- This verification must be completed and submitted within 21 days of contract award and prior to the issuance of the timber sale contract.
- In addition, if boxes 2B or 2C are checked, then Notice of Exclusion or Certificate of Insurance must be submitted within twenty-one (21) days of the contract award and prior to the issuance of the timber sale contract.
- All information must be typed or printed except for written signatures.

Please Check Appropriate Categories:

1. My business is organized as (you **must** check one of the boxes below):
 - A. ☐ Sole Proprietorship (individual)
 - B. ☐ Partnership
 - C. ☐ Corporation
2. You **must** check one of the boxes below:
 - A. ☐ I certify my business is a sole proprietorship and it has no employees but the sole proprietor. I am not subject to the Worker's Compensation Laws.
 - B. ☐ I certify my business has satisfied its obligation to the Worker's Compensation Act through the use of an approved Notice of Exclusion (BWC-337, Rev. 5/96). I will provide a copy of the Notice of Exclusion within 21 days of the contract award. (For questions or a copy of the BWC-337, please call the Worker's Compensation Bureau at 517-322-1195).
 - C. ☐ I certify my business has a Worker's Compensation Policy. I will provide an original Certificate of Insurance within twenty-one (21) days of the contract award.
3. If you have checked item 2(A) or 2(B), you **must** indicate the number of **both** full-time and part-time employees, other than yourself, including family members and active partners (if none, you must enter "0").

_____ Full-time Employees

_____ Part-time Employees

Name of Business		Federal ID (or) Social Security No.
Address		Telephone ()
City	State	ZIP

I hereby certify that the above information is true and correct. I agree to notify the Michigan DNR of any changes that occur in factors affecting my coverage during any of my present and future operations.

Signature of Owner or Authorized Representative

Title

Date

Please complete the "SEALED BID" information on the next page