

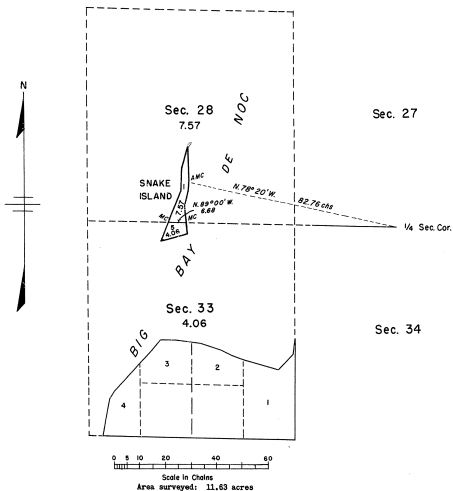

TOWNSHIP 39 NORTH, RANGE 19 WEST OF THE MICHIGAN MERIDIAN, MICHIGAN  
 SURVEY OF SNAKE ISLAND, SECTIONS 28 AND 33

46-202



This plat represents the survey of Snake Island in Big Bay de Noc of Lake Michigan, which was not included in the original survey of the township which is represented on the plat approved March 15, 1949.

Surveyed by Morville E. Shearer, Cartographer (Cadastral), on Sept. 5 and 9, 1955, under Special Instructions dated April 26, 1950 and Supplemental Instructions dated August 5, 1955, For Group 63, Michigan.

UNITED STATES DEPARTMENT OF THE INTERIOR  
 BUREAU OF LAND MANAGEMENT  
 Washington, D. C. February 17, 1956

This plat is strictly conformable to the approved field notes, and the survey, having been correctly executed in accordance with the requirements of law and the regulations of this Bureau, is hereby accepted.

For the Director  
*Earl S. Harrington*  
 Cadastral Engineering Staff Officer