

DRAWN BY <i>D.M.W.</i>		REVIEWED BY SECTIONS		APPROVED BY		NO. DATE BY		REVISIONS		DATE BY	
TRACED BY <i>J.H.F.</i>	ARCHITECTURAL	<i>J.R.</i>	<i>J.R.</i>	<i>J.R.</i>	<i>J.R.</i>	1		4			
CHECKED BY	ENGINEERING	<i>H.C.M.</i>	<i>H.C.M.</i>	<i>H.C.M.</i>	<i>H.C.M.</i>	2		5			
DATE	LANDSCAPE	<i>1-11-58</i>	<i>1-11-58</i>	<i>1-11-58</i>	<i>1-11-58</i>	3		6			

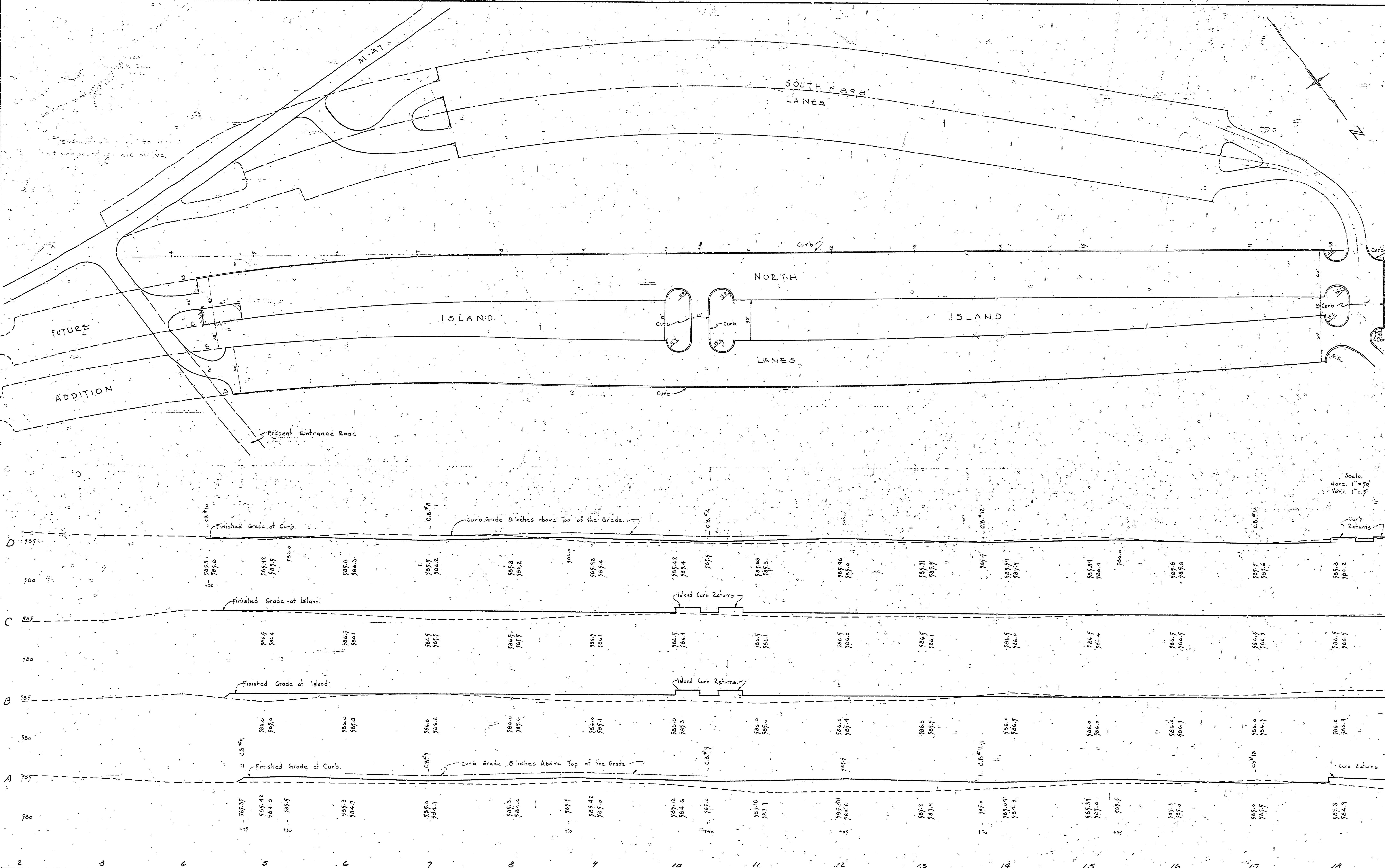

2	3	4	5	6	7	8	9	10	11	12	13	14	15	16	17	18
---	---	---	---	---	---	---	---	----	----	----	----	----	----	----	----	----

MICHIGAN DEPARTMENT OF CONSERVATION PARKS AND RECREATION DIVISION

BAY CITY STATE PARK WEST PARKING AREA-NORTH LANES PLAN # PROFILES

PROJECT NO. 75-204-1C

SHEET NO. 2 OF 11 PLAN NO. L-108

Scale  
 Horiz. 1" = 50'  
 Vert. 1" = 5'