

FEB 08 2000

JACKSON COUNTY
APPROVED LAND CORNER
P.A. 348 of 1990

Chairman David Erickson
Date 12/23/99

North 1/16 Corner, East Line Section 36, Leoni Township
LAND CORNER RECORDATION CERTIFICATE
Filing Requirement of Act 74, Mich. P.A. 1970

SECTION

For corners in JACKSON (County) Located in: Corner Code #

1. Public Land Survey T _____ R _____
T _____ R _____

1a. Remonumentation "Other" Code T _____ R _____
T _____ R _____

2. Property Controlling in Section S _____ T _____ R _____
S _____ T _____ R _____

3. Miscellaneous Property In Sec. S 36 T 1s R 1E
S _____ T _____ R _____

4. Lot No. _____ Recorded Plat _____

5. Private Claims _____

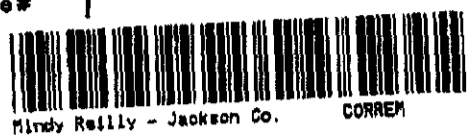

2141952
Page: 1 of 1
01/05/2000 09:14
L-1820 P-111

Register of Deeds Stamp & File Number

	A	B	C	D	E	F	G	H	I	J	K	L	M
1													
2	6	5	4	3	2	1							
3													
4	7	8	9	10	11	12							
5													
6	18	17	16	15	14	13							
7													
8	19	20	21	22	23	24							
9													
10	30	29	28	27	26	25							
11													
12	31	32	33	34	35	36							
13													

I, David E. Erickson, in a field survey on December 15, 19 94, do hereby certify that under requirements of P.A. 74, Michigan P.A. of 1970, the corner points mentioned in lines 1 and 2 above were in conformance with regulations and rules therefore as required in the current manual of survey instructions of the United States Department of the Interior, Bureau of Land Management or by a decree of a Court of Law and/or that the corner points mentioned in lines 3, 4 and 5 above were in conformance with the rules of the Michigan Board of Land Surveyors or by a Decree of a Court of Law; established, re-established, monumented, re-monumented, recovered, found as expressed below:

NOTE: Not more than 4 corners, all in the same town and range, may be recorded on this certificate.

A. Description of original monument and accessories and/or subsequent restoration

Corner not established in original government survey. Field notes dated 1-25-34 by F. Riley, (on file at Gutekunst Surveyor's in Book H-2, page 37) indicate the "E-NE 1/8 Post" was established 1344.84' North of the "E 1/4 Post, Sec 36". Riley set an "Iron Pipe" and recorded two Bearing Trees: Y Oak 16", N27°W, 103.55'; Y Oak 20", S79°W, 115.76'

B. Description of corner evidence found and/or method applied in restoring or reestablishing corner:

Searched area. Position falls in 3' deep drainage ditch running North and South. No pipe found. No other occupation noted. Positions of Riley's Bearing Trees fall in relatively new gravel road. No remaining evidence noted. Established corner by single-proportion between corner "M-12" as remonumented and the calculated position of "M-11" (in Lake) based on single-proportion between remonumented corners "M-10" and "M-12". Set a 60" aluminum pipe with Jackson County Remonumentation (JCR) cap, 0.3' high at East edge of drainage ditch.

C. Description of monument for corner and accessories established to perpetuate locating the position of the corner:

1" x 60" Aluminum Pipe with JCR Aluminum Cap stamped "L.S. 29245, 1994, N 1/16, S36/S31".

- N50°E Set Spike and Tag 29245 in Northwest side of 10" Cherry 60.00'
- N70°E Set Spike and Tag 29245 in North side of 30" Oak 95.40'
- S46°W Set Spike and Tag 29245 in East side of 18" Ash 8.23'
- N77°W Set Spike and Tag 29245 in North side of 9" Cherry 47.95'
- N31°W Set Spike and Tag 29245 in Northeast side of 10" Oak 72.69'
- East County Surveyor sign post 1'
- West Centerline gravel road 100'

Note: Bearings are magnetic
Note: This corner is being re-recorded to satisfy State of Michigan requirements.
It is the same corner as previously recorded in Liber 1451, Page 1003.

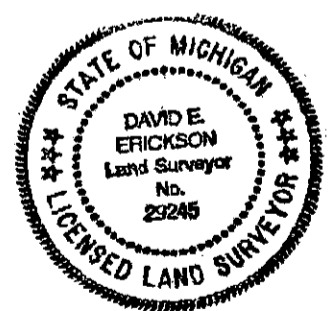

Signed by David Erickson Date 12/23/99
Surveyor's Michigan License No. 29245