

\$7.00
\$2.00

DEC 08 1999

SECTION

LAND CORNER RECORDATION CERTIFICATE
Filing Requirement of Act 74, Mich. P.A. 1970
KENT COUNTY REMONUMENTATION

For corners in

Kent (County)	Located in:	Grattan Township	Corner Code #
1. Public Land Survey	T <u>8N</u>	R <u>9W</u>	<u>K-13</u>
	T _____	R _____	_____
	T _____	R _____	_____
	T _____	R _____	_____
2. Property Controlling in Section	S _____	T _____	R _____
	S _____	T _____	R _____
3. Miscellaneous Property in Sec.	S _____	T _____	R _____
	S _____	T _____	R _____
4. Lot No. _____, Recorded Plat _____			
5. Private Claims _____			

STATE OF MICHIGAN
COUNTY OF KENT
RECEIVED FOR RECORD

38 DEC 14 AM 8:00

REG. OF DEEDS
Lucy Bond

11000

Register of Deeds Stamp & File Number

I, Randy Kolehouse, in a field survey on January 9 19 98, do hereby certify that under requirements of P.A. 74 Michigan P.A. of 1970, the corner points mentioned in lines 1 and 2 above were in conformance with regulations and rules therefore as required in the current manual of survey instructions of the United States Department of the interior, Bureau of Land Management or by a decree of a Court of Law and/or that the corner points mentioned in lines 3, 4 and 5 above were in conformance with the rules of the Michigan Board of Land Surveyors or by a Decree of a Court of Law; established, re-established, monumented, re-monumented, recovered, found as expressed below:

NOTE: Not more than 4 corners, all in the same town and range, may be recorded on this certificate.

A. Description of original monument and accessories and/or subsequent restoration:

K-13	1837	G.L.O. Notes	N. Brookfield	Set Post
	1939-62	Witness Map	K.C. Surveyor	Concrete Monument
	1978	L.C.R.C. #1134	Medema, Van Kooten & Assoc.	3/4" Iron
	1981	L.C.R.C. #1781	Williams & Works	Fnd. 3/4" Iron in Concrete Mon. / Set K.C. Monument
	1991	L.C.R.C. #5897	William Byl	K.C. Monument

	A	B	C	D	E	F	G	H	I	J	K	L	M
2	6		5		4		3		2		1		
3													
4	7		8		9		10		11		12		
5													
6	18		17		16		15		14		13		
7													
8	19		20		21		22		23		24		
9													
10	30		29		28		27		26		25		
11													
12	31		32		33		34		35		36		
13													

P.A. 345 1990 KENT COUNTY
PEER APPROVED 9/24/98
CHAIRMAN Randy Kolehouse

Note: This corner is not common with K-1, T7N, R9W.

This corner was originally approved by the Kent County Remonumentation Peer Group and monumented by Williams & Works on 1/16/81 and was recorded per L.C.R.C. #1781.

B. Description of corner evidence found and/or method applied in restoring or reestablishing corner:

K-13 Found a Standard Kent County Monument on the C/L of 4 Mile Road (gravel) running East and West, 1.0' West of the C/L of Ashley Road (gravel) running South, and 7.0' West of the C/L of Ashley Road (gravel) running North per L.C.R.C.'s #1781 and #5897 as set by Williams & Works in place of a 3/4" iron they found in a concrete monument which checked L.C.R.C. #1134 and the K.C. Surveyor's records.

L.C.R.C. #1781

L.C.R.C. #5897

K.C. Remon. Tag & Nail in NE Side P. Pole S 55°E 95.25'
K.C. Remon. Tag & Nail in W. Side 32" Maple S 25°E 131.20'
K.C. Remon. Tag & Nail in S. Side 12" Maple N 75°E 154.86'
K.C. Remon. Tag & Nail in NW Side P. Pole S 65°W 173.88'
Top C/L of MBT Box S 45°W 47.89'

KC Remon tag & nail NE side P. Pole S55°E 95.25' (m. 95.23')
KC Remon tag & nail W. side 36" Maple S25°E 131.18' (m. 131.12')
KC Remon tag & nail S. side 14" Maple N75°E 154.81' (m. 154.80')
KC Remon tag & nail NW side P. Pole S65°W 173.90' (m. 173.94')
Top C/L of MBT Box S45°W 47.89' (m. 47.70')
Kent County Monument @ NE cor. Sec. 2, T7N, R9W N90°E 24.40' (m. 24.46')

The selected location is accepted by me and is generally accepted by professional surveyors as the best available evidence of the position of the original corner.

C. Description of monument for corner and accessories established to perpetuate locating the position of the corner:

K-13 Standard Kent County Monument

Nail & K.C. remon. tag on NE side P. pole S 55° E 95.23'
Nail & K.C. remon. tag on W side 36" Maple S 25° E 131.12'
Nail & K.C. remon. tag on S side 14" Maple N 75° E 154.80'
Nail & K.C. remon. tag on NW side P. pole S 65° W 173.94'
Top C/L MBT box S 45° W 47.70'

On C/L of gravel road running E-W
C/L of gravel road running S, East 1.0'
C/L of gravel road running N, East 7.0'
K.C. Mon., K-1, T7N, R9W, N90°E 24.46'

Signed by Randy J. Kolehouse Date 9-30-98
EARTH TECH

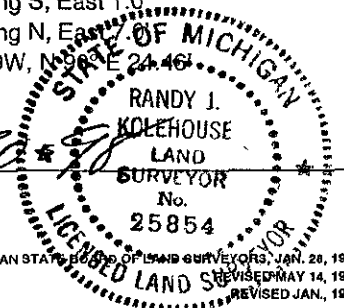

Surveyor's Michigan License No. 25854